

Filterelemente

for filter series

Pi 200, 210, 340, 360, 370, 420 und 450

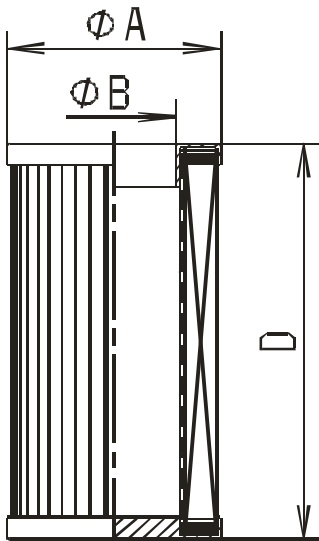

- Smx / Smx vst:** Single-use filter elements made of anorganic filter material
Retention rates 3, 6, 10, 25 μm ($\beta_x \geq 75$)
- Drg / Drg vst :** Cleanable filter elements made of stainless steel wire mesh (for retention rates $< 40 \mu\text{m}$ preferably in an ultrasonic bath)
Mesh sizes 10, 25, 40, 60, 100 μm
- Mic :** Single-use filter elements made of organic filter material
Retention rates 10, 25 μm
- End caps :** Steel, galvanized and yellow chromated
- Inner tube :** Steel, galvanized and yellow chromated

| Nominal-size | [] Type designation | | | | | | | | Order - no. | | | () Filter surface | | |
|--------------|---|---|---|---|---|---|---|---|----------------|------|---------------------|--------------------|--|--|
| | Smx 3 Δp 20 bar | Smx 6 Δp 20 bar | Smx 10 Δp 20 bar | Smx 25 Δp 20 bar | Smx vst 3 Δp 210 bar | Smx vst 6 Δp 210 bar | Smx vst 10 Δp 210 bar | Smx vst 25 Δp 210 bar | Measures in mm | | | | | |
| | A | B | D | | | | | | | | | | | |
| 50 | [Pi 2105] 768.013.5 (590 cm ²) | [Pi 5105] 794.350.9 (590 cm ²) | [Pi 3105] 768.032.5 (590 cm ²) | [Pi 4105] 768.044.0 (590 cm ²) | [Pi 2205] 768.019.2 (470 cm ²) | [Pi 5205] 794.353.3 (470 cm ²) | [Pi 3205] 768.038.2 (470 cm ²) | [Pi 4205] 768.050.7 (470 cm ²) | 47 | 25,5 | 95 _{.3} | | | |
| 80 | [Pi 2108] 768.014.3 (1150 cm ²) | [Pi 5108] 794.351.7 (1150 cm ²) | [Pi 3108] 768.034.1 (1150 cm ²) | [Pi 4108] 768.045.7 (1150 cm ²) | [Pi 2208] 768.020.0 (900 cm ²) | [Pi 5208] 794.354.1 (900 cm ²) | [Pi 3208] 768.019.0 (900 cm ²) | [Pi 4208] 768.051.5 (900 cm ²) | 47 | 25,5 | 173 _{.3} | | | |
| 110 | [Pi 2111] 768.015.0 (1700 cm ²) | [Pi 5111] 794.352.5 (1700 cm ²) | [Pi 3111] 768.033.3 (1700 cm ²) | [Pi 4111] 768.046.5 (1700 cm ²) | [Pi 2211] 768.021.8 (1315 cm ²) | [Pi 5211] 794.355.8 (1315 cm ²) | [Pi 3211] 768.039.0 (1315 cm ²) | [Pi 4211] 768.052.3 (1315 cm ²) | 47 | 25,5 | 249 _{.3} | | | |
| 150 | [Pi 2115] 768.016.8 (2425 cm ²) | [Pi 5115] 795.509.9 (2425 cm ²) | [Pi 3115] 768.035.8 (2425 cm ²) | [Pi 4115] 768.047.3 (2425 cm ²) | [Pi 2215] 768.022.6 (2010 cm ²) | [Pi 5215] 795.512.3 (2010 cm ²) | [Pi 3215] 768.040.8 (2010 cm ²) | [Pi 4215] 768.053.1 (2010 cm ²) | 83 | 47,5 | 145 _{.3} | | | |
| 300 | [Pi 2130] 768.017.6 (4620 cm ²) | [Pi 5130] 795.510.7 (4620 cm ²) | [Pi 3130] 768.036.6 (4620 cm ²) | [Pi 4130] 768.048.1 (4620 cm ²) | [Pi 2230] 768.023.4 (3800 cm ²) | [Pi 5230] 795.513.1 (3800 cm ²) | [Pi 3230] 768.041.6 (3800 cm ²) | [Pi 4230] 768.054.9 (3800 cm ²) | 83 | 47,5 | 258,5 _{.3} | | | |
| 450 | [Pi 2145] 768.018.4 (6865 cm ²) | [Pi 5145] 795.511.5 (6865 cm ²) | [Pi 3145] 768.037.4 (6865 cm ²) | [Pi 4145] 768.049.9 (6865 cm ²) | [Pi 2245] 768.024.2 (5600 cm ²) | [Pi 5245] 795.514.9 (5600 cm ²) | [Pi 3245] 768.042.4 (5600 cm ²) | [Pi 4245] 768.055.6 (5600 cm ²) | 83 | 47,5 | 375 _{.3} | | | |

| [] Type designation | | | Order - no. | | | () Filter surface | | | | | |
|----------------------|--|--|--|--|--|--------------------|--|--|----------------|------|---------------------|
| Nominal-size | Drg 10 | Drg 25 | Drg 40 | Drg 60 | Drg 100 | | Mic 10 | Mic 25 | Measures in mm | | |
| | Δp 20 bar | Δp 20 bar | Δp 20 bar | Δp 20 bar | Δp 20 bar | | Δp 20 bar | Δp 20 bar | A | B | D |
| 50 | [Pi 8105] 768.089.5 (590 cm ²) | [Pi 8205] 768.091.1 (590 cm ²) | [Pi 8305] 768.096.0 (590 cm ²) | [Pi 8405] 757.664.8 (590 cm ²) | [Pi 8505] 768.106.7 (590 cm ²) | | [Pi 1105] 757.663.0 (640 cm ²) | [Pi 1005] 771.862.0 (640 cm ²) | 47 | 25,5 | 95 _{.3} |
| 80 | [Pi 8108] 771.873.7 (1150 cm ²) | [Pi 8208] 768.092.9 (1150 cm ²) | [Pi 8308] 768.097.8 (1150 cm ²) | [Pi 8408] 768.101.8 (1150 cm ²) | [Pi 8508] 768.107.5 (1150 cm ²) | | [Pi 1108] 768.008.5 (1250 cm ²) | [Pi 1008] 765.717.4 (1250 cm ²) | 47 | 25,5 | 173 _{.3} |
| 110 | [Pi 8111] 768.090.3 (1700 cm ²) | [Pi 8211] 768.093.7 (1700 cm ²) | [Pi 8311] 768.098.6 (1700 cm ²) | [Pi 8411] 768.102.6 (1700 cm ²) | [Pi 8511] 771.877.8 (1700 cm ²) | | [Pi 1111] 768.009.3 (1840 cm ²) | [Pi 1011] 765.718.2 (1840 cm ²) | 47 | 25,5 | 249 _{.3} |
| 150 | [Pi 8115] 771.112.0 (2250 cm ²) | [Pi 8215] 768.094.5 (2250 cm ²) | [Pi 8315] 768.099.4 (2250 cm ²) | [Pi 8415] 768.103.4 (2250 cm ²) | [Pi 8515] 768.108.3 (2250 cm ²) | | [Pi 1115] 768.010.1 (2565 cm ²) | [Pi 1015] 765.719.0 (2565 cm ²) | 83 | 47,5 | 145 _{.3} |
| 300 | [Pi 8130] 771.881.0 (4280 cm ²) | [Pi 8230] 768.095.2 (4280 cm ²) | [Pi 8330] 771.880.2 (4280 cm ²) | [Pi 8430] 768.104.2 (4280 cm ²) | [Pi 8530] 768.907.8 (4280 cm ²) | | [Pi 1130] 768.011.9 (4885 cm ²) | [Pi 1030] 765.720.8 (4885 cm ²) | 83 | 47,5 | 258,5 _{.3} |
| 450 | [Pi 8145] 771.117.9 (6370 cm ²) | [Pi 8245] 771.118.7 (6370 cm ²) | [Pi 8345] 768.100.0 (6370 cm ²) | [Pi 8445] 768.105.9 (6370 cm ²) | [Pi 8545] 768.909.4 (6370 cm ²) | | [Pi 1145] 768.012.7 (7265 cm ²) | [Pi 1045] 771.116.1 (7265 cm ²) | 83 | 47,5 | 375 _{.3} |

| [] Type designation | | | Order - no. | | | () Filter surface | | | | | |
|----------------------|--|--|--|--|--|--------------------|--|--|----------------|------|---------------------|
| Nominal-size | Drg vst 10 | Drg vst 25 | Drg vst 40 | Drg vst 60 | Drg vst 100 | | | | Measures in mm | | |
| | Δp 210 bar | Δp 210 bar | Δp 210 bar | Δp 210 bar | Δp 210 bar | | | | A | B | D |
| 50 | [Pi 9105] 768.910.2 (480 cm ²) | [Pi 9205] 768.912.8 (480 cm ²) | [Pi 9305] 768.916.9 (480 cm ²) | [Pi 9405] 768.921.9 (480 cm ²) | [Pi 9505] 768.927.6 (480 cm ²) | | | | 47 | 25,5 | 95 _{.3} |
| 80 | [Pi 9108] 768.911.0 (910 cm ²) | [Pi 9208] 774.095.4 (910 cm ²) | [Pi 9308] 774.097.0 (910 cm ²) | [Pi 9408] 768.922.7 (910 cm ²) | [Pi 9508] 774.096.2 (910 cm ²) | | | | 47 | 25,5 | 173 _{.3} |
| 110 | [Pi 9111] 774.101.0 (1350 cm ²) | [Pi 9211] 768.913.6 (1350 cm ²) | [Pi 9311] 768.917.7 (1350 cm ²) | [Pi 9411] 768.923.5 (1350 cm ²) | [Pi 9511] 768.928.4 (1350 cm ²) | | | | 47 | 25,5 | 249 _{.3} |
| 150 | [Pi 9115] 774.103.6 (1800 cm ²) | [Pi 9215] 768.914.4 (1800 cm ²) | [Pi 9315] 768.918.5 (1800 cm ²) | [Pi 9415] 768.924.3 (1800 cm ²) | [Pi 9515] 768.929.2 (1800 cm ²) | | | | 83 | 47,5 | 145 _{.3} |
| 300 | [Pi 9130] 774.107.7 (3400 cm ²) | [Pi 9230] 768.915.1 (3400 cm ²) | [Pi 9330] 768.919.3 (3400 cm ²) | [Pi 9430] 768.925.0 (3400 cm ²) | [Pi 9530] 768.930.0 (3400 cm ²) | | | | 83 | 47,5 | 258,5 _{.3} |
| 450 | [Pi 9145] 774.111.9 (5020 cm ²) | [Pi 9245] 774.112.7 (5020 cm ²) | [Pi 9345] 768.920.1 (5020 cm ²) | [Pi 9445] 768.926.8 (5020 cm ²) | [Pi 9545] 768.931.8 (5020 cm ²) | | | | 83 | 47,5 | 375 _{.3} |

3IVI 03/2000

3IVM 07/2003

Data is subject to change without notice