

## Temperature Sensor Thermolog MK2- / EK2 - Desina

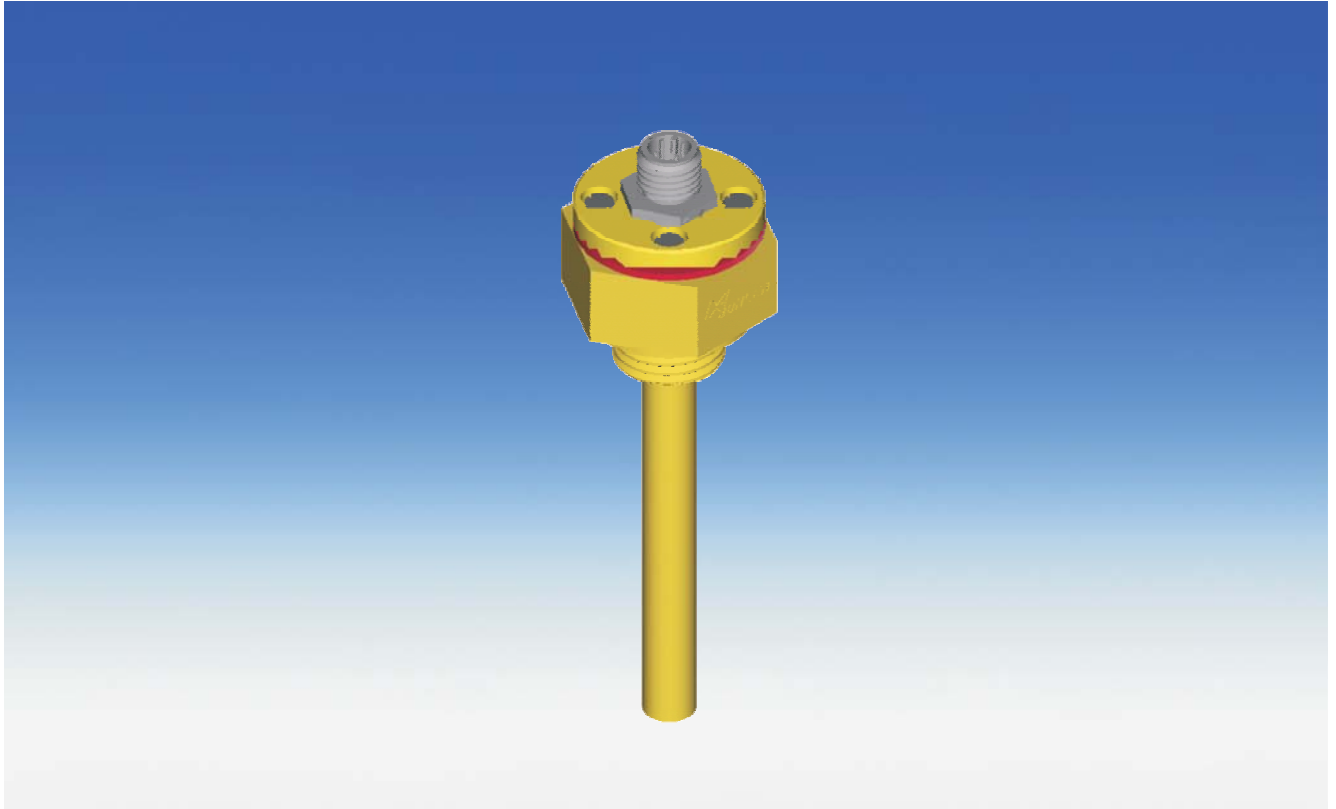

The Thermolog MK2 / EK2 temperature sensor designed by Bühler Technologies is produced according to the Desina standard.

Desina is a brand name of the VDW (German Machine Tool Builders' Association) and stands for a technically specified standardised installation concept on machine tools, which has decentralised structures.

With the standard analogue output of 4 - 20 mA found nearly throughout the entire sector of temperature measuring technology, the Thermolog MK2/EK2 provides a continuous signal, which remains stable over long distances irrespective of the cable length. A Pt 100 is used as the sensor. The small and compact transmitter is located inside the hexagon head.

The Thermolog MK2/EK2 measures the current temperature quickly and precisely and converts it into an analogue signal 4 - 20 mA. This signal can be implemented in the system control unit in any number of threshold values.

The modular design separates "wet" and "dry" components. This allows for working on the electronics even when installed below the liquid level without draining the fluid.

- **simple, robust design**
- **small dimensions**
- **electrical inner part easy to remove**
- **M12 base connector**
- **elastic sealing ring**
- **Desina**



1800-OILSOL <https://oilsolutions.com.au/>  
1800-645765

[sales@oilsolutions.com.au](mailto:sales@oilsolutions.com.au)

## Technical data

Versions	MK2- and EK2-Desina
Temperature sensor	Pt 100 Class B DIN / IEC 751
Measuring range*	- 0 °C to +100 °C
Probe length L max.	1000 mm
Operating voltage (UB)	10 - 30 V DC
Output	4 - 20 mA (0 °C = 4 mA) (100 °C = 20 mA)
Max. Load $\Omega$	= (UB -7,5 V)/0,02 A
permissible operating temperature	-20 °C to +100 °C
Storage temperature	-40 °C to +100 °C
<b>Material</b>	
Probe	Model MK 2 = brass Model EK 2 = 1.4571
Max. operating pressure	Model MK2 = 5 bar Model EK2 = 10 bar

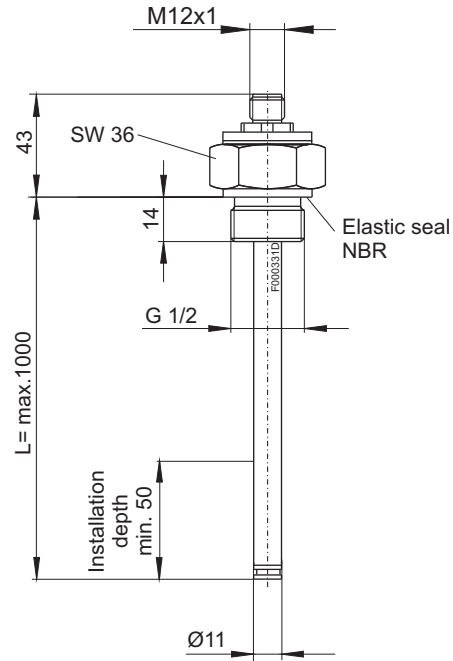

\* Other measuring ranges available upon request

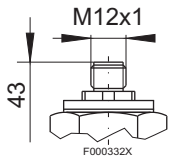
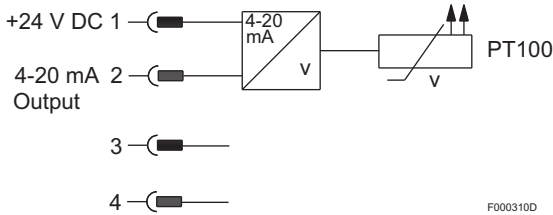
<p><b>Plug connection</b></p> <p>IP rating Cable fitting Other plug connections available on request</p> <p>Max. voltage</p>	<p><b>M12 (base)</b> 4-pin</p> <p>IP 67** PG 7**</p> <p>** with respective plug top</p>  <p>24 V DC</p>	<p><b>Pin assignment ***</b></p>  <p>F000310D</p> <p>*** The pin assignment is based on Desina, Spec_11 und Spec_16</p>
--	--	---

## Ordering instructions

Item no. for base version, L=variabel

with connector	M12 (base and plug top)	Length
MK2-Desina	1124599	L = ... mm
Ek2-Desina	1124699	L = ... mm

### Ordering example:

You require: Temperature sensor with M12 plug connector, length L= 520 mm, operating pressure 2 bar  
Order: Item-no.: 1124599 Temperature sensor Thermolog MK2-M12-Desina , L= 520