

Welcome To **BUCHER** hydraulics

POWER UNITS

Our quality: We always adhere to the implementation of ISO9001 quality management system and continuously strengthen and improve internal management, as well as providing our customers with best quality products. Quality and service is our sincere commitment.



Search:

Position: Index >> Products

Gear Pumps and Gear Motors Power Units Hydraulic Valves Accessories

CBM GEAR PUMP

## CBM GEAR PUMP

### General Description



The CBM series gear pump consists of a gear pair, a housing, a front cover and a rear cover. The CBM Series Gear Pump features high mechanical and volumetric efficiency, low noise level as well as low weight/power ratio. It is widely used in the power units for snow plows and small displacement, modest pressure hydraulic systems.

### Order Code

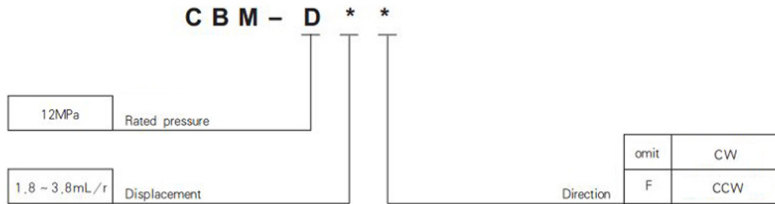

### Outline Dimension

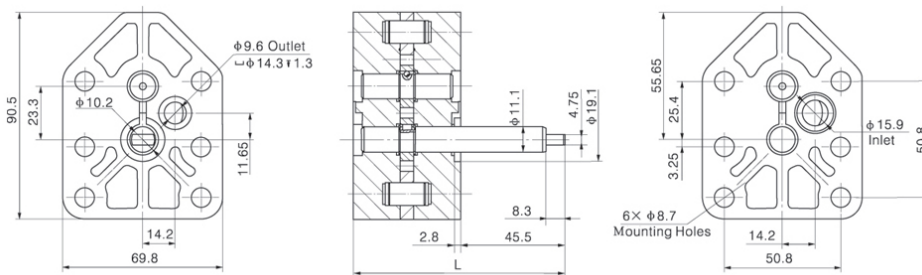

### Technical Data

Model	Displacement mL/r (in <sup>3</sup> /r)	pressure (MPa)			Speed (RPM)		L(mm)	Efficiency
		P1	P2	P3	Rated	Max		
CBM-D1.8F	1.8 (0.110)	12	15	17.5	2000	3000	92.5	75%
CBM-D2.8F	2.8 (0.171)						95.5	
CBM-D3.8F	3.8 (0.232)						98.5	

Copyright: Bucher Hydraulics (Wuxi)Co.,Ltd. 编号: 苏ICP备18069474号-1