

Welcome To **BUCHER** hydraulics

POWER UNITS

Our quality: We always adhere to the implementation of ISO9001 quality management system and continuously strengthen and improve internal management, as well as providing our customers with best quality products. Quality and service is our sincere commitment.



Search:

Position: Index >> Products

- [Gear Pumps and Gear Motors](#)
- [Power Units](#)
- [Hydraulic Valves](#)
- [Accessories](#)

[CBM1 Gear Pumps](#)

CBM1 Gear Pumps

General Description



The CBM1 gear pump consists of a gear pair, a housing, a front cover and a rear cover. The CBM1 Series Gear Pump features high mechanical and volumetric efficiency, low noise level as well as low weight/power ratio.

Order Code

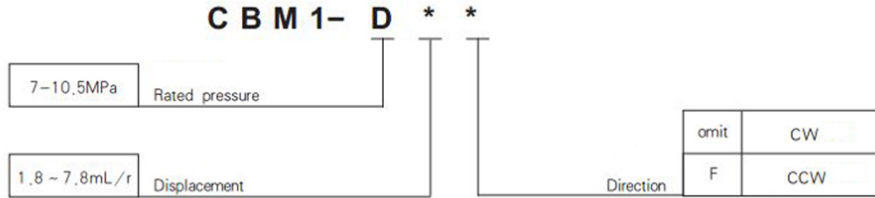

Outline Dimension

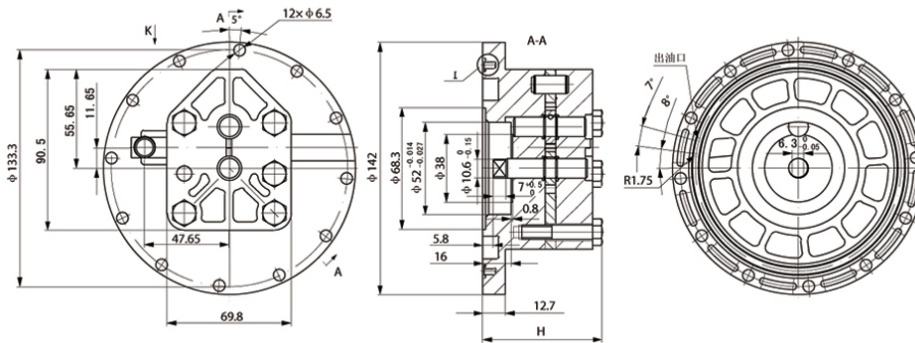

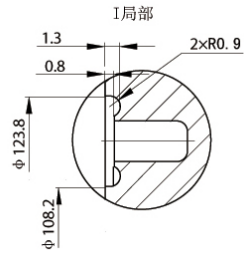
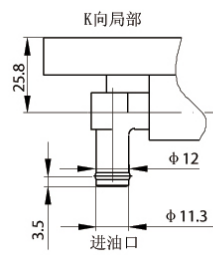

Technical Data

Model	Displacement mL/r (in ³ /r)	Pressure (MPa)		Speed (RPM)	H	Efficiency	Overall Efficiency
		Rated(MPa)	Max(MPa)				
CBM1-D1.8	1.92	10.5	14	1775	67	≥ 85%	≥ 72%
CBM1-D3.2	3.32				71.3		
CBM1-D4.2	4.36	9.1	74.5				
CBM1-D6.3	6.38		80.7				
CBM1-D7.8	8.26	7	12.5	1450	86.5		

Copyright: Bucher Hydraulics (Wuxi)Co.,Ltd. 编号: 苏ICP备18069474号-1