

**CSP SYSTEM**  
**CASAPPA SMART**  
**POWER SYSTEM**

# INDEX

Section	Page
CSP CASAPPA SMART POWER SYSTEM .....	3
smartEASY SOFTWARE .....	4
smartFULL SOFTWARE.....	5
CASAPPA SERVICE TOOL.....	11
MVPe PISTON PUMP - INTRODUCTION .....	12
GENERAL INFORMATION / INSTRUCTIONS .....	13
MOUNTING POSITIONS.....	14
FEATURES.....	16
DOUBLE SHAFT SEAL OPTION.....	20
DISPLACEMENT SETTING.....	21
SINGLE PUMPS AND COMMON INLET MULTIPLE PUMPS DIMENSIONS .....	22
DRIVE SHAFTS.....	30
MOUNTING FLANGES.....	32
PORTS TYPE .....	34
INTEGRATED ELECTRONIC CONTROL UNIT .....	37
REGULATORS.....	39
MULTIPLE PUMPS WITH THROUGH DRIVE .....	41
HOW TO ORDER .....	48

Replaces: 01/08.2022

02/02.2023



Modification from former edition.

## CSP - CASAPPA SMART POWER SYSTEM

Casappa Smart Power system is an evolution of the Load Sensing flow sharing system and it allows to manage smartly the power of the machines hydraulic system.

Replaces: 01/08.2022



Building & Construction • Material Handling - On-Highway - Agriculture

## Optimization of the machine power management

Digital transformation and upgrade of Load Sensing hydraulic control systems on mobile machines.

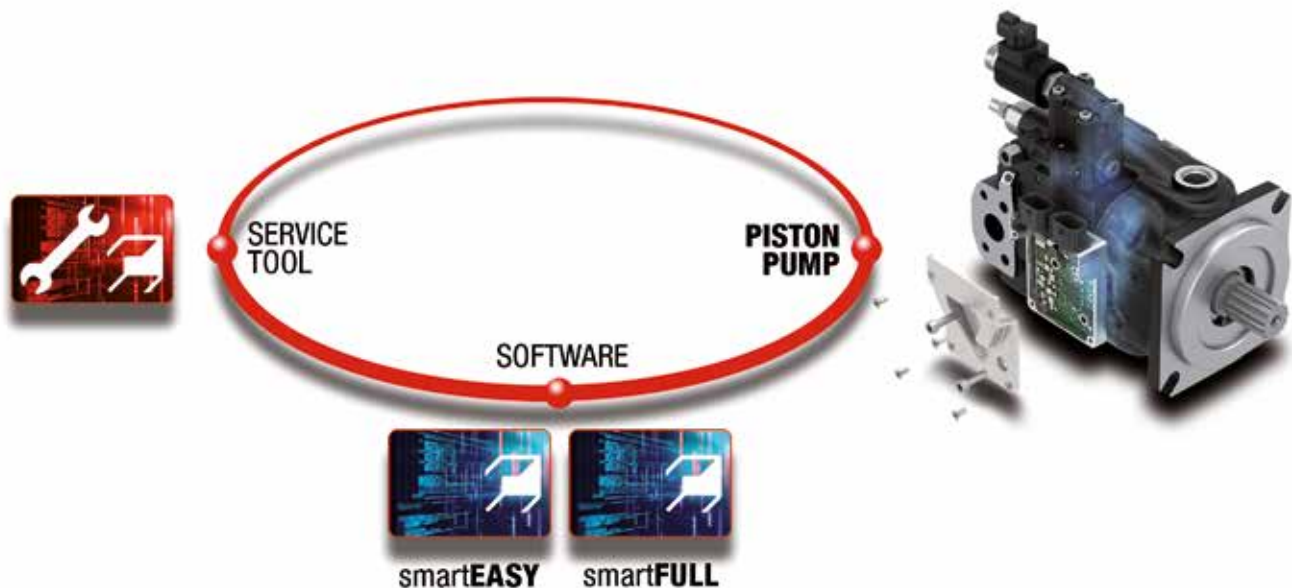

02/02.2023

### Software evolution

- ▶ **smartEASY & smartFULL**  
Availability of 2 different software logics

### Hardware evolution

- ▶ Integration of ECU into the case
- ▶ **MVPe PISTON PUMP** ○

## smartEASY SOFTWARE

### Pump control logics

The smartEASY software includes logics relating to real time pump control. These logics are developed by Casappa for the maximum efficiency, stability and reactivity of the pump. The logics relating to the power management strategies of the machine are freely defined and developed by the customer. The software developed by Casappa, thanks to the thorough knowledge of pump operation, ensures the optimal functioning of the pump and the maximum flexibility for the customer, since the MVPe can be easily controlled via CAN bus setpoints.



Replaces: 01/08.2022

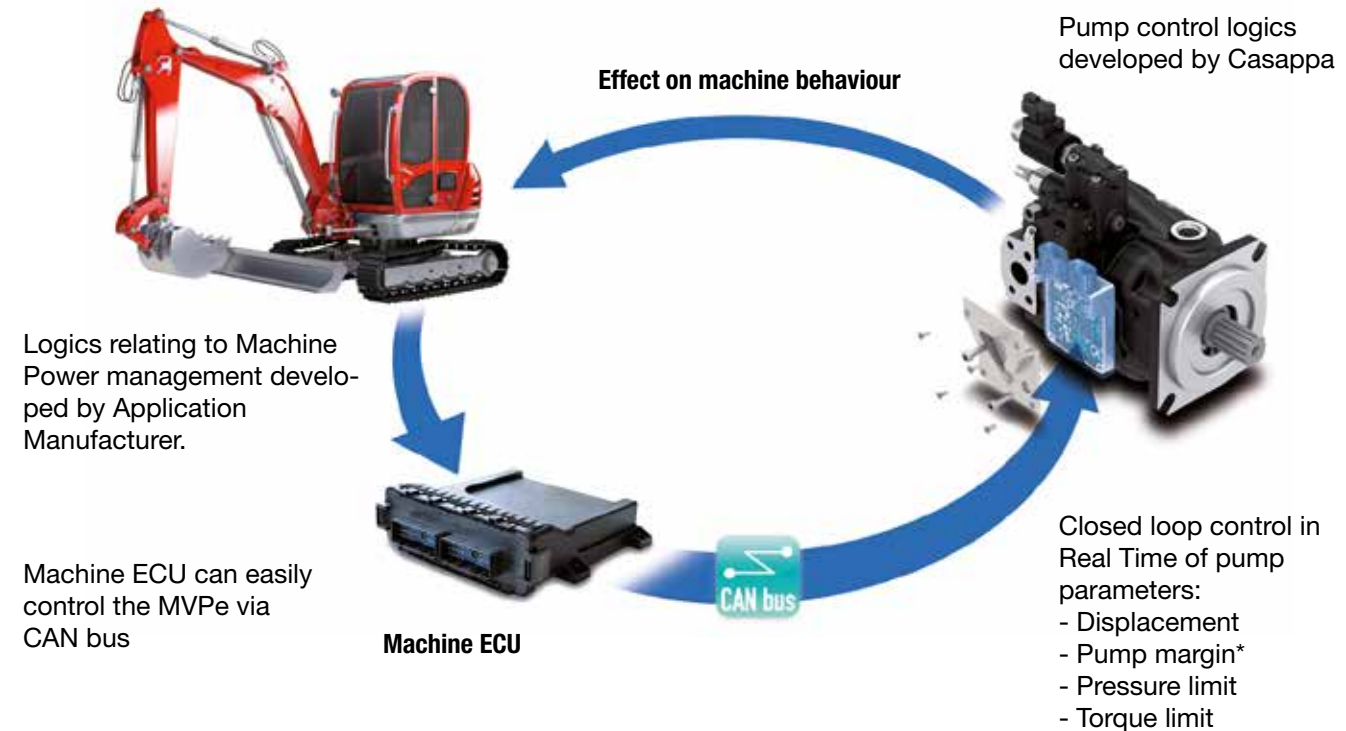

## smartEASY SOFTWARE ADVANTAGES

### Flexibility in controlling the pump.

- ▶ Easy interface with pump acting on different parameters (torque, pump margin\*, pressure and displacement) to optimize the machine setpoint logics defined by customer.

### Fine optimization of the pump functioning in relation to the desired behaviour of the machine.

- ▶ Confidence to interact with pump parameters without compromising the pump optimized working mode.
- ▶ More accurate torque management thanks to Casappa hydraulic expertise (efficiency map).

02/02.2023

\* For this feature 2 pressure sensors (pump outlet pressure and Load Sensing pressure) are required.

## smartFULL SOFTWARE

### Pump & System control logics

In addition to the pump logics, the smartFULL software also includes logics relating to the power management strategies of the machine.

These logics are developed by Casappa and customized in cooperation with customer. They define the optimal setpoints for the MVPe through different ready-to-use modules, which can be combined each other.

This software allows the definition of the desired behaviour of the pump in relation to the desired behaviour of the machine in terms of power management using ready-to-use software modules developed by Casappa thanks to its broaden experience in the field.



Ready-to-use modules developed by Casappa to link and optimize machine power management strategies with pump logics.

Replaces: 01/08.2022

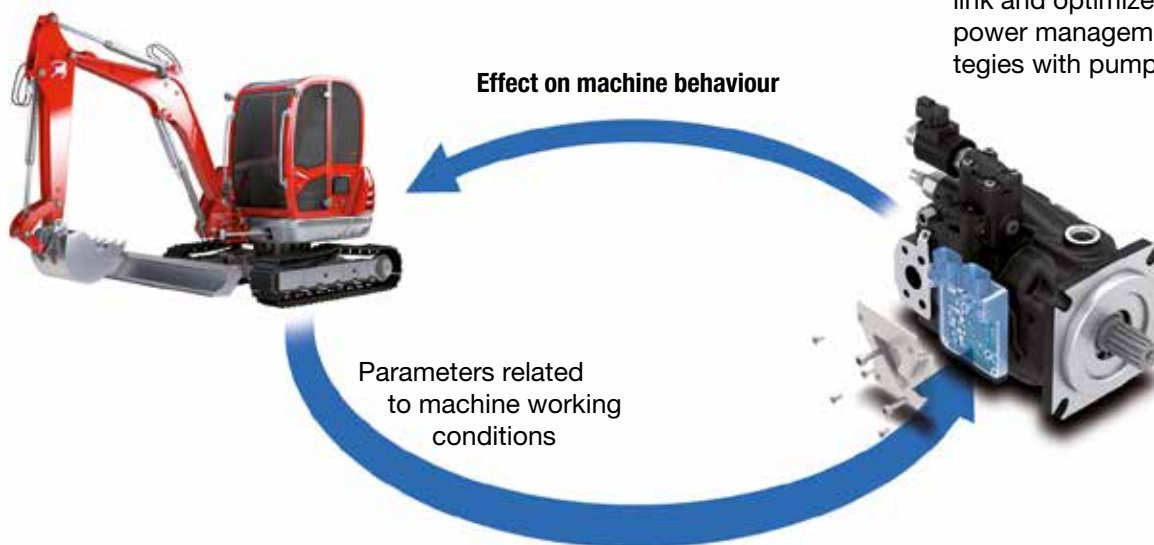

- eLS - electronic Load Sensing
- eAS - electronic AntiStall
- eTC - electronic Torque Control
- eATC - electronic Adaptive Torque Control
- Working Modes

## smartFULL SOFTWARE ADVANTAGES

### Ready-to-use and already developed modules

- ▶ No need for CUSTOMER to invest in any logics development.

### Optimization of the machine power management strategies with pump logics leading to:

- ▶ **SAVING:** possible better sizing of the engine and consequent machine cost savings.
- ▶ **USABILITY:** higher sensitivity in using the machine thanks to the electronic Load Sensing.
- ▶ **PRODUCTIVITY:** possibility to exploit full engine potential in terms of performances.
- ▶ **EMISSIONS:** optimum use of the engine and reduction of emissions thanks to electronic Torque Control.
- ▶ **FLEXIBILITY:** adaptability to different working conditions using the Working Modes module (standard, economy, power).

02/02.2023

Variable pump margin, controlled in closed loop, for maximum joystick sensitivity and adjustable machine velocity. For this feature 2 pressure sensors (pump outlet pressure and Load Sensing pressure) are required.

**Hydraulic Load sensing: fixed setting**

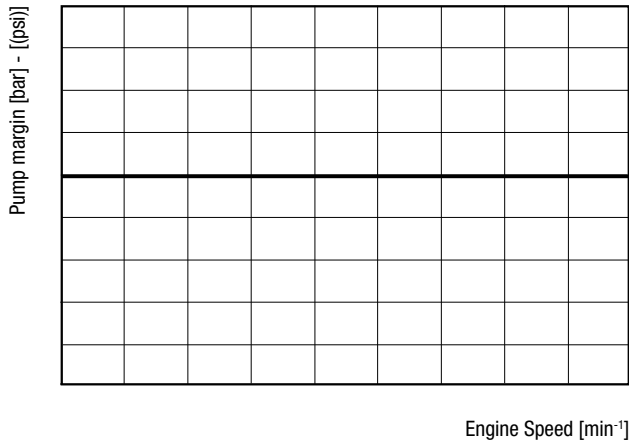

**Electronic Load Sensing: variable setting**



In an application with a hydraulic load sensing system, the setting of the LS regulator is fixed and represents a compromise between the speed of the machine and the wasted power.

Thanks to the eLS module, the pump flow will be functional to the real needs of the application at a given time. The controllability and maneuverability of the machine will be superior for low speed movements. At the same time the maximum flow rate will be greater, and therefore the speed of the movements will be higher when requested by the operator.

- The pump margin is controlled in closed loop by the ECU. The “speed” of the machine can be changed according to the working conditions.
- Accurate flow control.
- The maximum sensitivity of the joystick can always be maintained.
- Reduced pump margin for precise movement and less wasted power.
- Higher pump margin for higher movement speed.

01/08.2022

The Anti-stall function is suitable for wheeled machines, with power shared between the hydraulic circuit and the transmission. Both systems draw power from the engine, with priority given to the transmission. When the transmission is running, the power available to the hydraulic pump is limited and therefore the pump must be regulated accordingly.

By reading the information of the engine speed, the eAS monitors any drops: as the speed decreases with respect to the requested one (engine stall occurring), the pump displacement is reduced until the absorbed power does match the available power.

When the transmission stops running, all the available power can be drawn by the pump.

**PHASE 1**

No power is absorbed by the transmission, the power absorbed by the pump is less than the total available from the motor.

**PHASE 2**

The transmission requests power and the sum with the power absorbed by the pump exceeds the total available. A decrease of the engine speed starts.

**PHASE 3**

The transmission has the priority. In order to avoid the engine stop, the electronic control reduces the pump displacement so that the total absorbed power is less than the total available power from the engine.

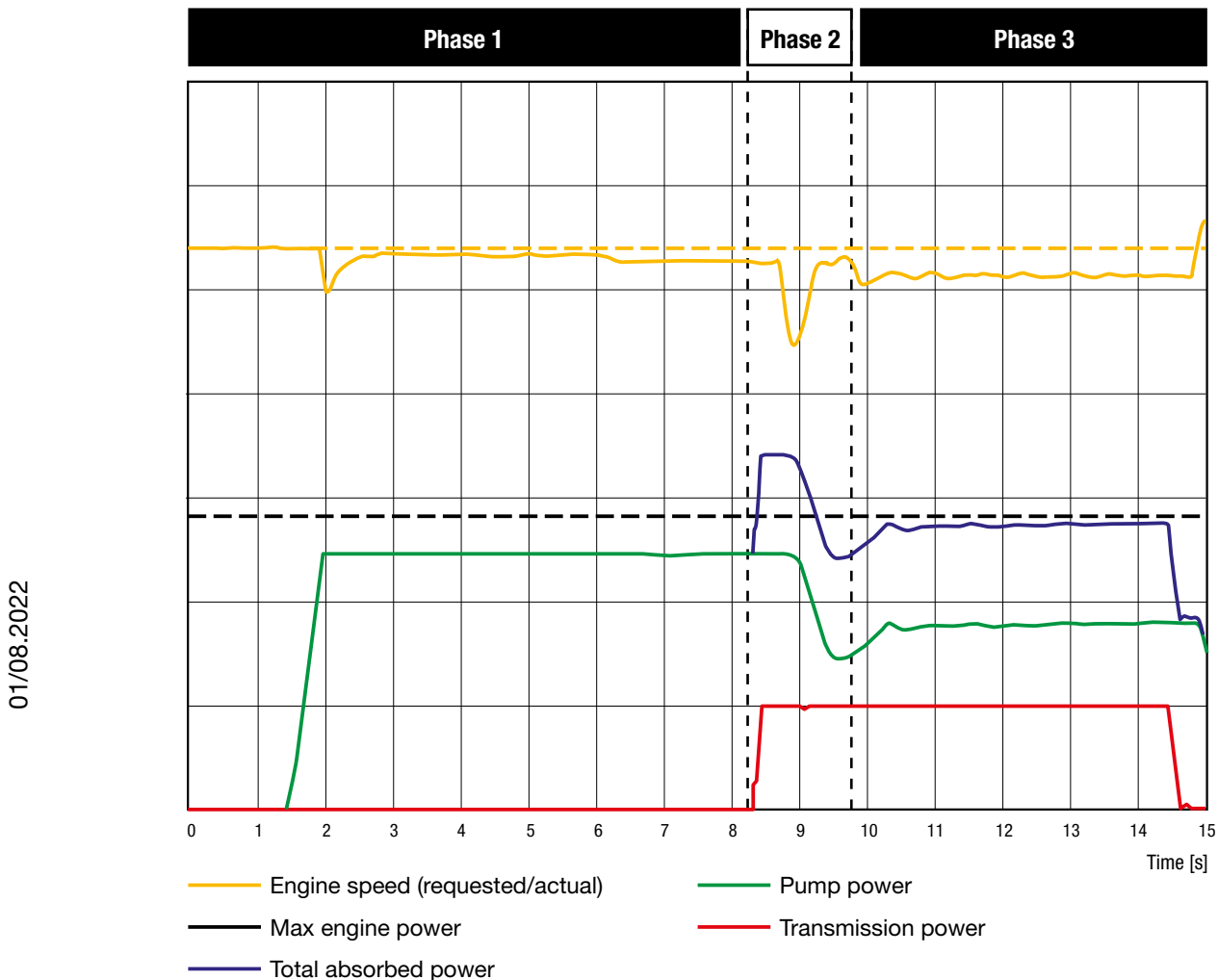

Electronic torque control is suitable for crawler machines where the entire engine power is absorbed by the hydraulic pump. Compared to the hydraulic solution, the eTC module allows to exploit all the available torque in all the different working conditions.

**Hydraulic torque control**

The pump torque setting must match the minimum available torque of the motor to prevent shutdown (red line) -> 100% of the available engine torque is not actually used.

**Electro-hydraulic torque control**

The absorbed torque is electronically adjusted to a variable limit, depending on the working conditions. The pump torque can accurately match the engine torque -> Better use of engine performances.

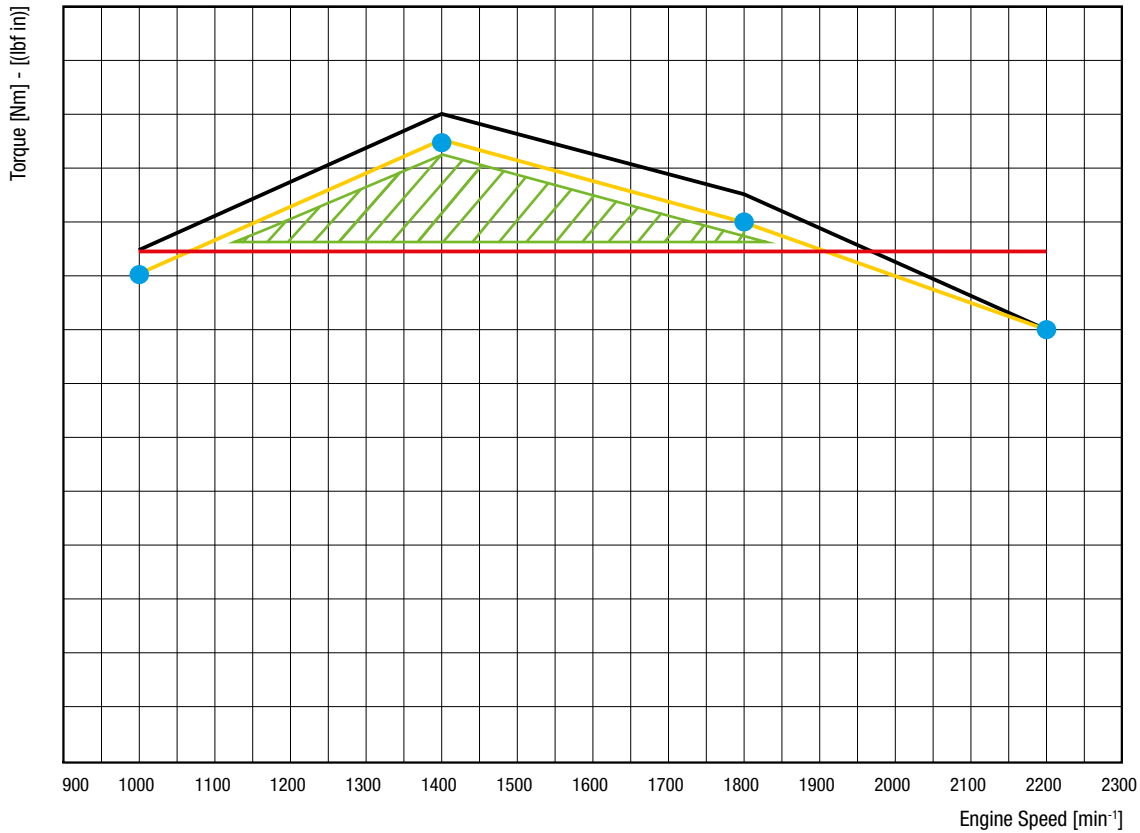

- Engine available torque
- Torque eTC
- Torque hydraulic regulator
- Gained torque exploited by the eTC module with respect to hydraulic torque control.

01/08.2022

The combination of the advantages of electronic torque and electronic antistall controls makes the eATC module suitable both for wheeled and tracked applications.

The absorbed torque is electronically adjusted to a variable limit, depending on the working conditions, as for the eTC module, but if the engine speed drops, the torque is automatically reduced. To detect stall conditions, the motor speed is continuously compared to the requested one.

Same application models can have different performances based on:

- Type of use (more or less intense)
- Place of work (altitude)
- Specificity of the single application

The “adaptive” system allows to adapt the hydraulic system to different conditions in a precise, continuous and immediate way, always exploiting the maximum power available for the hydraulic pump.

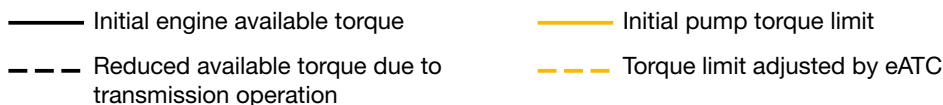
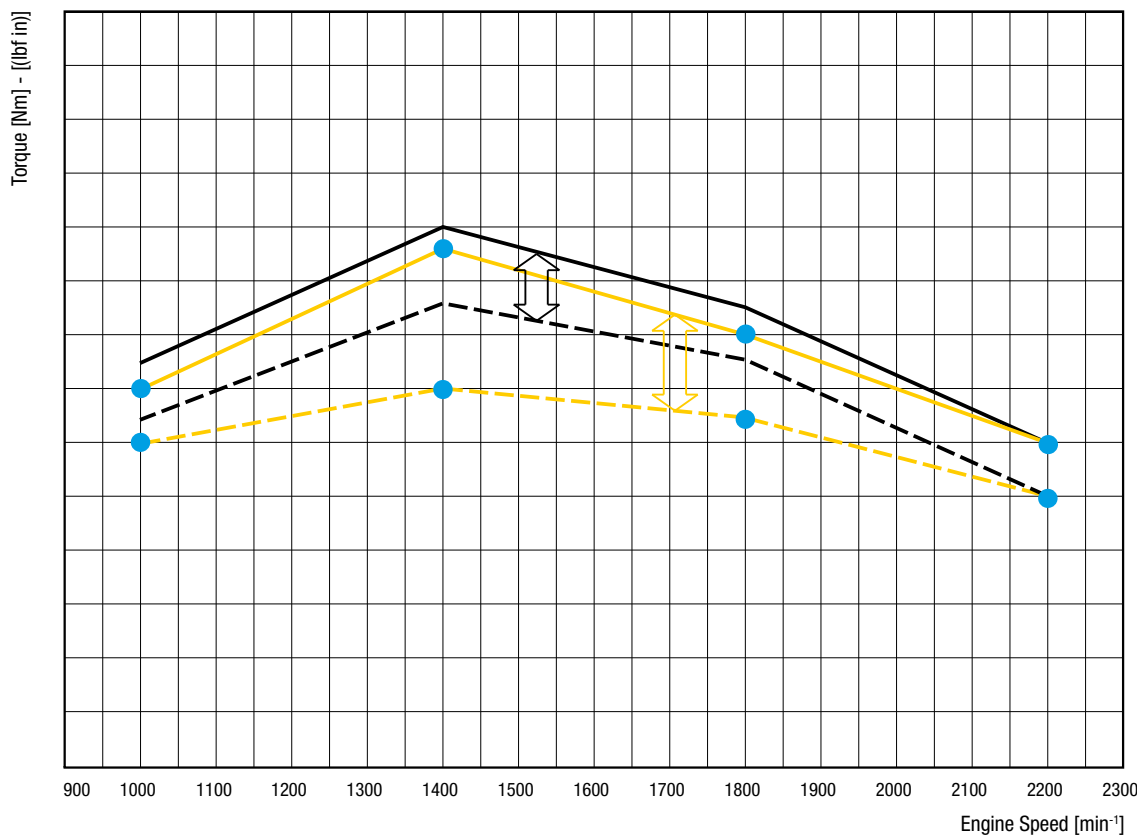

01/08.2022

Thanks to the Working Modes module it is possible to set different system parameters (engine speed, pump margin, torque limit) so that the user can select the desired mode during machine operation, according to specific needs. Typical working modes are: Standard Mode, Economy Mode, Power Mode.

**STANDARD MODE**

Hydraulic system is set for standard operations, engine speed can be manually set.

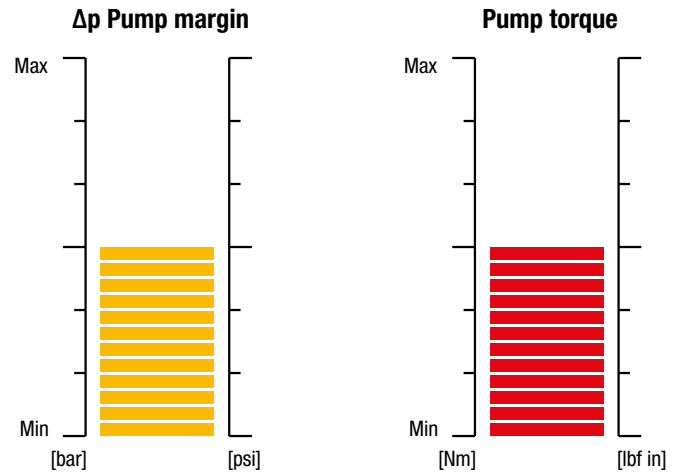

**ECONOMY MODE**

Engine speed and hydraulic system are set for minimum fuel consumption.

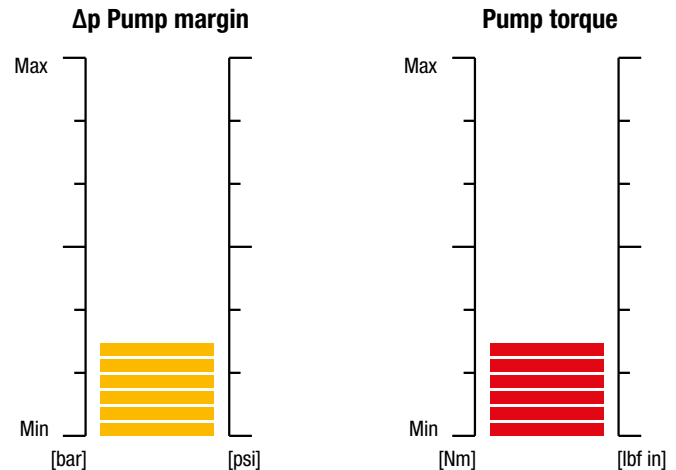

**POWER MODE**

Engine speed and hydraulic system are set for maximum productivity.

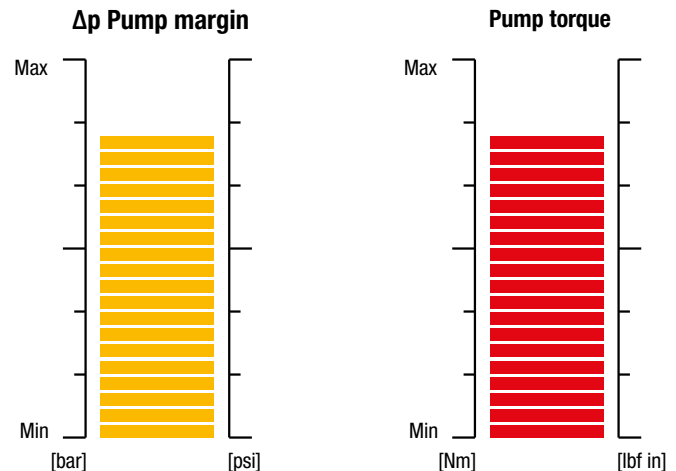

The working modes are customized based on customer requests, additional working modes can be introduced.

01/08.2022

## CASAPPA SERVICE TOOL

**Real time monitoring & set up**  
Control by Tablet - Smartph



**Casappa service tool for smartEASY**  
Monitoring of pump working conditions.



**Casappa service tool for smartFULL**  
Monitoring of pump working conditions and software configuration of system parameters.

01/08.2022



## MVPe PISTON PUMP - INTRODUCTION

Variable displacement axial piston pumps swash plate design ideally suited for open circuit in mobile hydraulic applications.

MVPe series piston pump is an evolution of the MVP series and represents the integration in one object of:

- MVP piston pump
- Angular sensor
- Pressure electronic compensator
- Electronic control unit

### DISPLACEMENTS

From 34,9 cm<sup>3</sup>/rev (2.13 in<sup>3</sup>/rev) ●

To 84,7 cm<sup>3</sup>/rev (5.17 in<sup>3</sup>/rev)

Available soon from 14 cm<sup>3</sup>/rev (0.85 in<sup>3</sup>/rev) to 53,7 cm<sup>3</sup>/rev (3.28 in<sup>3</sup>/rev)

### PRESSURE

Max. constant operating pressure 280 bar (4060 psi)

Max. system pressure (relief valve setting) 315 bar (4568 psi)

Max. peak of pressure 350 bar (5075 psi)

### SPEED

Max. 3000 min<sup>-1</sup>

### APPLICATION

Medium pressure

### SECTOR

Mobile



Replaces: 01/08.2022

### MVPe advantages

- ▶ Machine layout simplification leading to system cost savings if compared to solutions with ECU detached from the pump case.

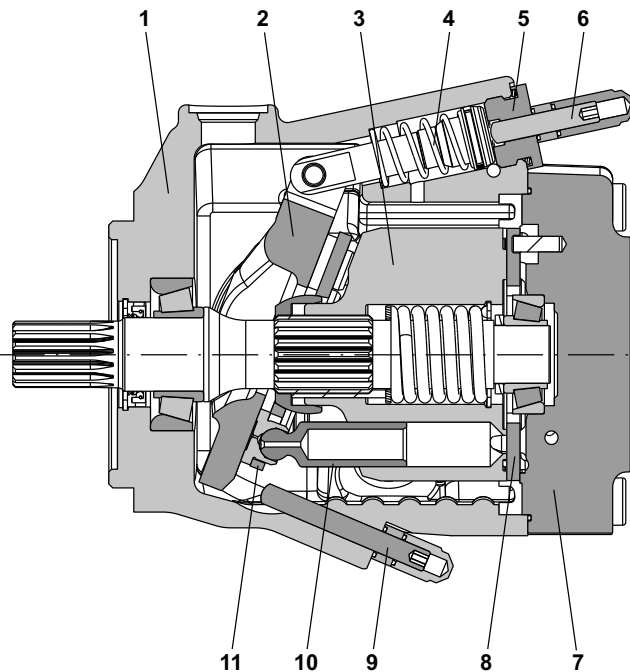

1	Pump body
2	Swash plate
3	Cylinders block
4	Counterbalancing spring
5	Plug
6	Max. displacement limiter
7	Cover
8	Valve plate
9	Min. displacement limiter
10	Piston
11	Piston guide plate

● 02/02.2023

## GENERAL INFORMATION / INSTRUCTIONS

### DIRECTION OF ROTATION

Clockwise or anti-clockwise defined looking at the drive shaft.

### HYDRAULIC FLUID

Mineral oil based hydraulic fluid conforming to DIN 51524, fire resistant fluids and biodegradable fluids according to the technical data shown in the tables on pages 16 ÷ 18. The system should be designed to prevent aeration of the hydraulic fluid.

### FLUID VISCOSITY

The fluid viscosity range for optimal use of MVPE pump is between 15 and 35 cSt (77 and 163 SSU).

Functional limit conditions are:

max.: 1500 cSt (6818 SSU) at start up at minimum temperature of -25 °C (-13 °F) with straight and short inlet line.  
 min.: 10 cSt (58 SSU) at maximum temperature of 110 °C (230 °F)

### FILTRATION

To ensure the optimal performance and the maximum life to the pump, the hydraulic fluid must have and maintain a fluid contamination within the values shown in the table below.

Working pressure bar (psi)	$\Delta p < 140$ (2030)	$140 < \Delta p < 210$ (2030) (3045)	$\Delta p > 210$ (3045)
Contamination class NAS 1638	9	8	7
Contamination class ISO 4406:1999	20/18/15	19/17/14	18/16/13
Achieved with filter $\beta_{x_{(0)}} \geq 75$ according to ISO 16889	10 $\mu\text{m}$	10 $\mu\text{m}$	10 $\mu\text{m}$

Casappa recommends to use its own production filters:



### STORAGE

The storage must be in a dry environment.  
 Max storage time in ideal conditions is 24 months.  
 The ideal storage temperature is between 5 °C (41 °F) and 20 °C (68 °F). No problem in case of temperature between -40 °C (-40 °F) and 50 °C (122 °F). Below -40 °C (-40 °F) please consult our pre-sales department.

### INSTALLATION

Check that the maximum coupling eccentricity stays within 0,25 mm (0.0098 in) to reduce shaft loads due to misalignment. It is advised to use a flexible coupling suitable to absorb eventual rotational shocks. For applications with axial and radial loads exceeding published standards, consult our sales department. The direction of rotation of the pump must agree with the prime mover rotation. Before installation, the case of the pump must be filled with fluid.

### LINES

The lines must have a major diameter which is at least as large as the diameter of pump ports, and must be perfectly sealed. To reduce loss of power, the lines should be as short as possible, reducing the sources of hydraulic resistance (elbow, throttling, gate valves, etc.) to a minimum. A length of flexible tubing is recommended to reduce the transmission of vibrations. Before connecting the lines, remove any plug and make sure that the lines are perfectly clean. Check that the drain line is dimensioned in a way to guarantee a case pressure lower than 1,5 bar (22 psi) absolute. The drain line must be connected directly (no filter, no valves, no oil cooler) to the tank and must terminate below the oil level. Check that the dimensions of the suction line guarantee a pressure equal or superior to 0,8 bar (12 psi). Inlet pressure less than 0,8 bar (12 psi) could cause an increase of noise emission, the decrease of the pump performances and a reduction of its life expectancy.

### STARTING UP

Check that all connections are secure and that the entire system is completely clean. Add oil to the tank always using a filter. Bleed the air from the circuit to help the filling. Turn on the system for a few moments at minimum speed, then bleed the circuit again and check the level of oil in the tank. Gradually increase the pressure and speed of rotation up to the pre-set operating levels, which must stay within the stated limits as specified in the catalogue.

### FOR VERY LOW TEMPERATURE

### STARTING UP

We strongly recommend to warm up the oil before running the machine. If this is not possible, the warm up of the oil and of the pump should be carried out following these instructions:

- Start the pump in stand-by condition at minimum speed. Keep this working condition until the pump case reaches -20 °C (-4 °F)
- Increase slowly the displacement. Max pressure permitted: 50 bar (725 psi). The maximum permitted speed is strictly connected to the layout of the inlet circuit; check that there is no cavitation before increasing the speed.
- Keep this working condition until the oil temperature in the whole system is -10 °C (14 °F).
- Maximum pressure can be achieved from now on.
- Always check the outlet flow to prevent cavitation damage.

All the temperature are referred to oil with viscosity ISO VG 32 according to DIN 51 519.

### SUGGESTIONS

To prevent cavitation at low temperature we suggest:

- To warm up the tank
- To pressurize the tank
- To oversize the inlet hose

01/08.2022

## MOUNTING POSITIONS

Standard pump is supplied with D1 drain hole open and D2, D3, D4 plugged (◆ if available).

Before installation fill the pump with hydraulic oil for at least 3/4 of the volume keeping it in horizontal position.

The pump can be mounted in a horizontal or vertical position. The highest of the case drain ports must be used to keep the required filling oil.

If D1 is not the highest drain port it must be closed by moving the plug from the hole chosen for the drain line.

The pump can be located above the oil level if the absolute pressure at the inlet port stays within the stated limits.

With exception of pump mounted below the oil level, we recommend to interpose a baffle plate between inlet and drain line.

To reduce further noise emission, we recommend to mount the pump below the oil level and avoid suction lines with sharp restrictions.

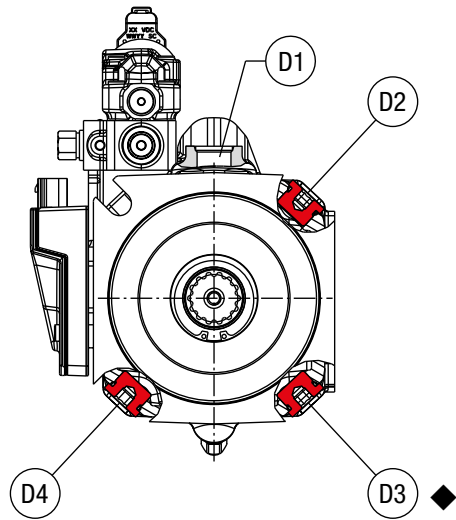

HORIZONTAL MOUNTING		VERTICAL MOUNTING	
	<p><b>Arrangement outside the tank above oil level.</b></p> <p>Min. inlet pressure= 0,8 bar abs (24 in Hg)</p> <p>B ≤ 800 mm (31.4961 in)</p> <p>C = 200 mm (7.874 in)</p>		<p><b>Arrangement outside the tank above oil level.</b></p> <p>Min. inlet pressure= 0,8 bar abs (24 in Hg)</p> <p>B ≤ 800 mm (31.4961 in)</p> <p>C = 200 mm (7.874 in)</p>
	<p><b>Arrangement outside the tank below oil level.</b></p> <p>C = 200 mm (7.874 in)</p>		

IN= inlet line - D1= drain line - B+C= permissible suction height - C= line immersion depth

01/08.2022

## PRESSURE DEFINITION

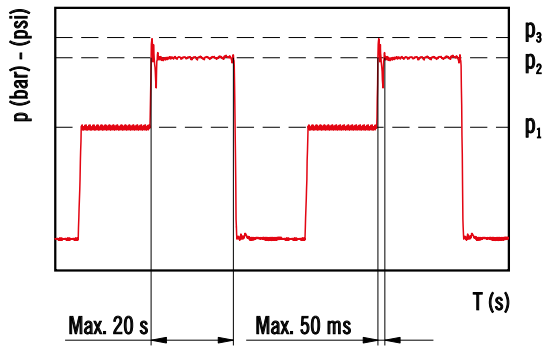

- $p_1$  Constant operating pressure
- $p_2$  System pressure (relief valve setting)
- $p_3$  Peak of pressure

The peak of pressure is the max pressure allowed and it corresponds to the overshoot of the relief valve.

Please note that both relief valve setting and overshoot must be lower than their limits.

If the relief setting is compliant but the overshoot is higher than the limit, the relief setting must be decreased until the overshoot is compliant to Casappa limit.

Please contact us for high frequency applications.

01/08.2022

## FEATURES

### Technical data with mineral oil

**HL or HLP** mineral oil based hydraulic fluid to DIN 51524

Pump type MVPE			48-45	48-53	60-60	60-72	60-84
Max. displacment (theor.) $V_{max}$	cm <sup>3</sup> /rev (in <sup>3</sup> /rev)		45 (2.75)	53,7 (3.28)	60 (3.66)	72 (4.39)	84,7 (5.17)
	Inlet pressure	bar abs. (in Hg)	min.		0,8 (24)		
bar abs. (psi)		max.		25 (363)			
Max. outlet pressure $p_{max}$	bar (psi)	$p_1$	280 (4060)	250 (3625)	280 (4060)	280 (4060)	250 (3625)
		$p_2$	315 (4568)	280 (4060)	315 (4568)	315 (4568)	280 (4060)
		$p_3$	350 (5075)	315 (4568)	350 (5075)	350 (5075)	315 (4568)
Max. drain line pressure	bar abs. (psi)				2 (29)		
Max. speed $n_{max}$	min <sup>-1</sup>	@ $V_{max}$ (1)	3000	2500	3000	2700	2300
		@ $n_{max}$	135 (35.7)	134 (35.4)	180 (47.6)	194 (51.3)	194 (51.3)
Max. delivery (theor.)	l/min (US gpm)	@ 2000 min <sup>-1</sup>	90 (23.8)	107 (28.3)	120 (31.7)	144 (38.0)	169 (44.7)
		@ 1500 min <sup>-1</sup>	68 (18.0)	81 (21.4)	90 (23.8)	108 (28.5)	127 (33.6)
		@ $n_{max}$	63 (84.4)	55,9 (74.9)	84 (112.6)	90,7 (121.5)	81 (108.5)
Max. power (theor.) ( $\Delta p = p_{max}$ cont.)	kW (HP)	@ 2000 min <sup>-1</sup>	42 (56.3)	44,8 (60.0)	56 (75.0)	67,2 (90.0)	70,6 (94.6)
		@ 1500 min <sup>-1</sup>	31,5 (42.2)	33,6 (45.0)	42 (56.3)	50,4 (67.5)	52,9 (70.9)
		@ $p_{max}$ cont.	200,5 (1775)	213,7 (1891)	267,4 (2367)	320,9 (2840)	337 (2983)
Max. torque (theor.)	Nm (lbf in)	@ 100 bar (1450 psi)	71,6 (634)	85,5 (757)	95,5 (845)	114,6 (1014)	134,8 (1193)
		Moment of inertia rotary group	kgm <sup>2</sup> (ft <sup>2</sup> lbs)	0,003 (0.07)	0,003 (0.07)	0,008 (0.19)	0,008 (0.19)
Fill volume	l (US gallons)		1 (0.26)	1 (0.26)	1,3 (0.34)	1,3 (0.34)	1,3 (0.34)
Mass (approx.)	kg (lbs)		19 (41.9)	19 (41.9)	22 (48.5)	22 (48.5)	22 (48.5)
Seals			N= Buna		V= Viton		
Operating temperature	°C (°F)	min.			-25 (-13)		-15 (5)
		max. cont.			80 (176)		110 (230)
		max. peak			100 (212)		125 (257)

Replaces: 01/08.2022

02/02.2023

(1) = with an inlet pressure of 1 bar abs (14.5 psi) and viscosity between 15 and 35 cSt (77 and 163 SSU).  
 Reducing the displacement or increasing the inlet pressure the max. speed changes. See table at page 19.  
 Max. speed limit are: MVPE48: 3000 min<sup>-1</sup> - MVPE60: 3000 min<sup>-1</sup>  
 Please contact us for different working conditions.

## FEATURES

### Technical data restrictions with fire resistant fluid

(1) = with an inlet pressure of 1 bar abs (14.5 psi) and viscosity between 15 and 35 cSt (77 and 163 SSU).

Replaces: 01/08.2022

<b>HFA - Oil emulsion in water (5 ÷ 15 % of oil)</b>							
Pump type MVPE			<b>48-45</b>	<b>48-53</b>	<b>60-60</b>	<b>60-72</b>	<b>60-84</b>
Max. outlet pressure $p_{max}$	bar (psi)	$p_1$	140 (2030)				
		$p_2$	150 (2175)				
		$p_3$	160 (2320)				
Max. speed $n_{max}$	min <sup>-1</sup>	@ $V_{max}$ (1)	2000	1700	2000	1700	1500
Seals			N= Buna				
Operating temperature	°C (°F)	min.	2 (36)				
		max.	55 (131)				
Bearing life (ref. mineral oil)	%		20 %				

<b>HFB - Water emulsion in oil (40 % of water)</b>							
Pump type MVPE			<b>48-45</b>	<b>48-53</b>	<b>60-60</b>	<b>60-72</b>	<b>60-84</b>
Max. outlet pressure $p_{max}$	bar (psi)	$p_1$	160 (2320)				
		$p_2$	170 (2465)				
		$p_3$	180 (2610)				
Max. speed $n_{max}$	min <sup>-1</sup>	@ $V_{max}$ (1)	2150	1800	2150	1800	1600
Seals			N= Buna				
Operating temperature	°C (°F)	min.	2 (36)				
		max.	60 (140)				
Bearing life (ref. mineral oil)	%		40 %				

02/02.2023

<b>HFC - Water-glycol (35 ÷ 55 % of water)</b>							
Pump type MVPE			<b>48-45</b>	<b>48-53</b>	<b>60-60</b>	<b>60-72</b>	<b>60-84</b>
Max. outlet pressure $p_{max}$	bar (psi)	$p_1$	180 (2610)				
		$p_2$	195 (2828)				
		$p_3$	210 (3045)				
Max. speed $n_{max}$	min <sup>-1</sup>	@ $V_{max}$ (1)	2150	1800	2150	1800	1600
Seals			N= Buna				
Operating temperature	°C (°F)	min.	-10 (14)				
		max.	60 (140)				
Bearing life (ref. mineral oil)	%		40 %				

## FEATURES

### Technical data restrictions with fire resistant fluid

(1) = with an inlet pressure of 1 bar abs (14.5 psi) and viscosity between 15 and 35 cSt (77 and 163 SSU).

#### HFD - Phosphate ester

Pump type MVPE			48-45	○	48-53	60-60	60-72	60-84
Max. outlet pressure $p_{max}$	bar (psi)	$p_1$	200 (2900)					
		$p_2$	220 (3190)					
		$p_3$	240 (3480)					
Max. speed $n_{max}$	min <sup>-1</sup>	@ $V_{max}$ (1)	2150	1800	2150	1800	1600	
Seals			N= Buna					
Operating temperature	°C (°F)	min.	-10 (14)					
		max.	80 (176)					
Bearing life (ref. mineral oil)	%		90 %					

### Technical data restrictions with biodegradable fluids

#### HETG - Natural based fluid (the water content must never exceed 0,1 %)

Pump type MVPE			48-45	○	48-53	60-60	60-72	60-84
Max. outlet pressure $p_{max}$	bar (psi)	$p_1$	180 (2610)					
		$p_2$	195 (2828)					
		$p_3$	210 (3045)					
Max. speed $n_{max}$	min <sup>-1</sup>	@ $V_{max}$ (1)	2150	1800	2150	1800	1600	
Seals			N= Buna					
Operating temperature	°C (°F)	min.	-10 (14)					
		max.	60 (140)					
Bearing life (ref. mineral oil)	%		50 %					

#### HEPG - Polyglycol based synthetic fluid (the water content must never exceed 0,1 %)

Pump type MVPE			48-45	○	48-53	60-60	60-72	60-84
Max. outlet pressure $p_{max}$	bar (psi)	$p_1$	180 (2610)					
		$p_2$	195 (2828)					
		$p_3$	210 (3045)					
Max. speed $n_{max}$	min <sup>-1</sup>	@ $V_{max}$ (1)	2150	1800	2150	1800	1600	
Seals			N= Viton					
Operating temperature	°C (°F)	min.	-15 (5)					
		max.	90 (194)					
Bearing life (ref. mineral oil)	%		75 %					

#### HEES - Synthetic esters (the water content must never exceed 0,1 %)

Pump type MVPE			48-45	○	48-53	60-60	60-72	60-84
Seals			N= Viton					
Operating temperature	°C (°F)	min.	-15 (5)					
		max.	80 (176)					
Bearing life (ref. mineral oil)	%		100 %					

Replaces: 01/08.2022

○ 02/02.2023

## FEATURES

### Design calculations for pump

Replaces: 01/08.2022

<b>Q</b>	l/min (US gpm)	Flow
<b>M</b>	Nm (lbf in)	Torque
<b>P</b>	kW (HP)	Power
<b>V</b>	cm <sup>3</sup> /rev (in <sup>3</sup> /rev)	Displacement
<b>n</b>	min <sup>-1</sup>	Speed
<b>Δp</b>	bar (psi)	Pressure
$\eta_v = \eta_v(V, \Delta p, n)$		Volumetric efficiency
$\eta_{hm} = \eta_{hm}(V, \Delta p, n)$		Hydro-mechanical efficiency
$\eta_t = \eta_v \cdot \eta_{hm}$		Overall efficiency

$$Q = Q_{theor.} \cdot \eta_v$$

$$Q_{theor.} = \frac{V \text{ (cm}^3\text{/rev)} \cdot n \text{ (min}^{-1}\text{)}}{1000} \quad [l/min]$$

$$M = \frac{M_{theor.}}{\eta_{hm}} \quad [Nm]$$

$$M_{theor.} = \frac{\Delta p \text{ (bar)} \cdot V \text{ (cm}^3\text{/rev)}}{62,83}$$

$$P_{in} = \frac{P_{out}}{\eta_t} \quad [kW]$$

$$P_{out} = \frac{\Delta p \text{ (bar)} \cdot Q \text{ (l/min)}}{600}$$

### Max. permissible load on drive shaft

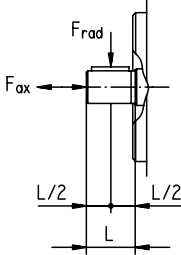
Pump type		<b>○</b>	<b>○</b>	<b>○</b>	<b>○</b>	<b>○</b>	
		<b>MVPE</b>	<b>MVPE</b>	<b>MVPE</b>	<b>MVPE</b>	<b>MVPE</b>	
		<b>48•45</b>	<b>48•53</b>	<b>60•60</b>	<b>60•72</b>	<b>60•84</b>	
$F_{ax}$ Axial force	 <small>D037-D41/0196</small>	N (lbf)	1500 (337)	1500 (337)	2000 (450)	2000 (450)	2000 (450)
$F_{rad}$ Radial force	@ L/2	N (lbf)	1500 (337)	1500 (337)	3000 (675)	3000 (675)	3000 (675)

### % Variation of the max. speed in relation of the inlet pressure and/or displacement reduction

**○** 02/02.2023

Inlet pressure	Displacement %					% Variation of the max. speed
	psi (bar abs)	65	70	80	90	
12 (0,8)	120	115	105	97	90	
13 (0,9)	120	120	110	103	95	
14.5 (1,0)	120	120	115	107	100	
17 (1,2)	120	120	120	113	106	
20 (1,4)	120	120	120	120	112	
23 (1,6)	120	120	120	120	117	
29 (2,0)	120	120	120	120	120	

Max. speed must not exceed the limits specified at page 16.

#### Example 1

Displacement: 100 %  
 Speed: 100 %  
 Inlet pressure: 1,0 bar abs. (14.5 psi)

#### Example 2

Displacement: 80 %  
 Inlet pressure: 1,0 bar abs. (14.5 psi)  
 Speed: 115 %

## FEATURES

### Definition of rotation direction looking at the drive shaft

#### Anti-clockwise rotation

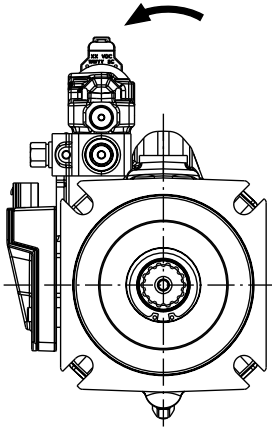

#### Side ports

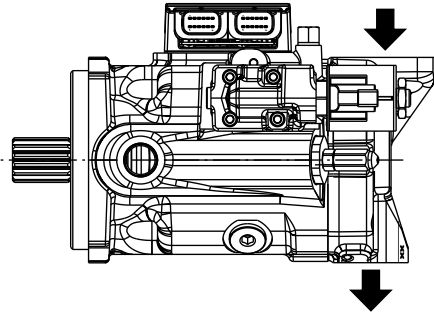

#### Rear ports

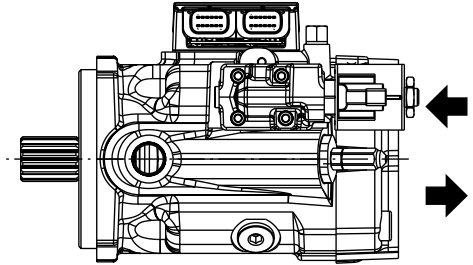

#### Clockwise rotation

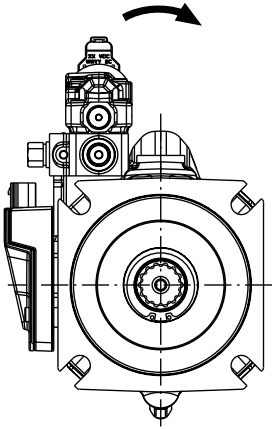

#### Side ports

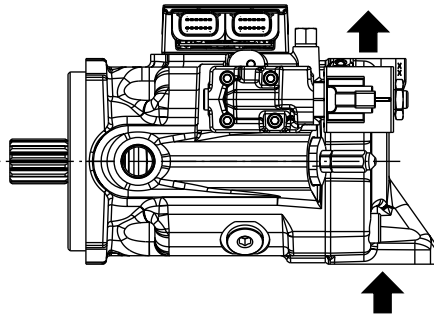

#### Rear ports

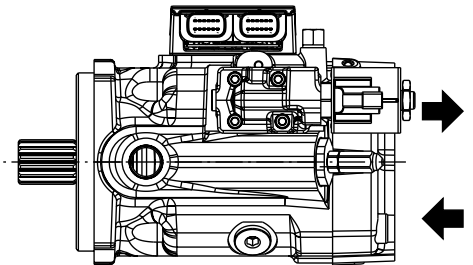

Replaces: 01/08.2022

## DOUBLE SHAFT SEAL OPTION

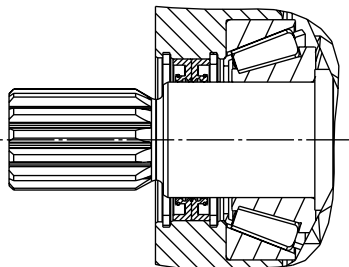

The double shaft seal is available for the following configuration:

Pump type	MOUNTING FLANGES		
	S5	S7	S8
<b>MVPE48</b>	X		
<b>MVPE60</b>		X	X

X Available combination

02/02.2023

## DISPLACEMENT SETTING

Replaces: 01/08.2022

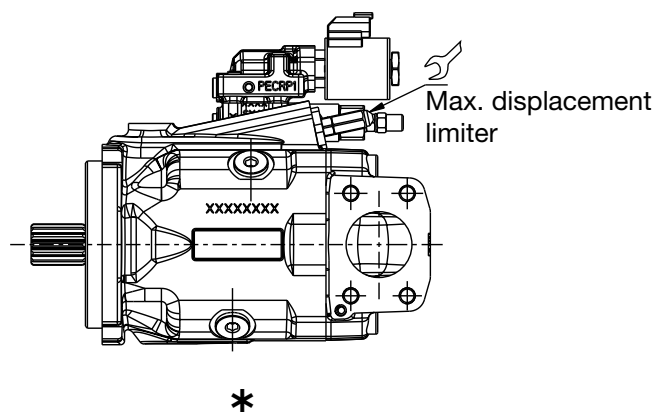
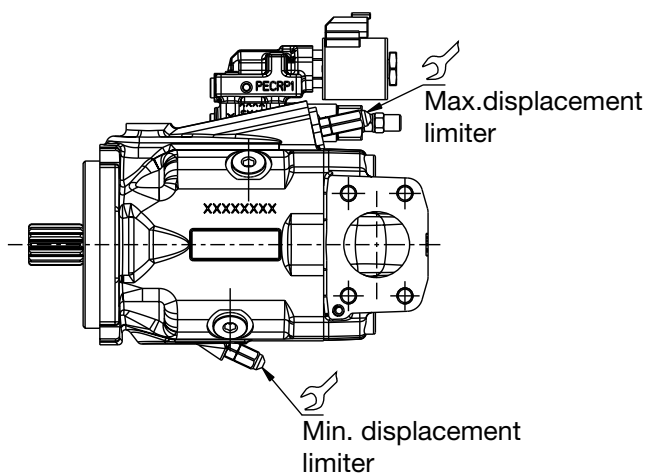

- E:** Max. displacement limiter (Min displacement limiter is plugged)
- G:** Min. and Max. displacement limiter

\* Special body without Min. displacement limiter is available only on request, please contact us for more information

Tightening torque  $15^{\pm 1}$  Nm (124 ÷ 142 lbf in)

		<b>o</b>		<b>MVPE48</b>	<b>MVPE60</b>
Max. displacement setting range	cm <sup>3</sup> /rev (in <sup>3</sup> /rev)	from		34,9 (2.13)	55 (3.36)
		to		53,7 (3.28)	84,7 (5.17)
Min. displacement setting range	cm <sup>3</sup> /rev (in <sup>3</sup> /rev)	from		0	0
		to		10,7 (0.65)	38,1 (2.32)
One turn of screw changes pump displacement by approximately	cm <sup>3</sup> /rev (in <sup>3</sup> /rev)	E		3,2 (0.20)	5,0 (0.31)
		F		3,0 (0.18)	4,2 (0.26)

Please contact us for different setting range.

**o** 02/02.2023

**MVPE48**

**SIDE PORTS - DIMENSIONS**

**L**

Drive shafts: see page 30  
 Mounting flanges: see page 32  
 Ports: see page 34 ÷ 36

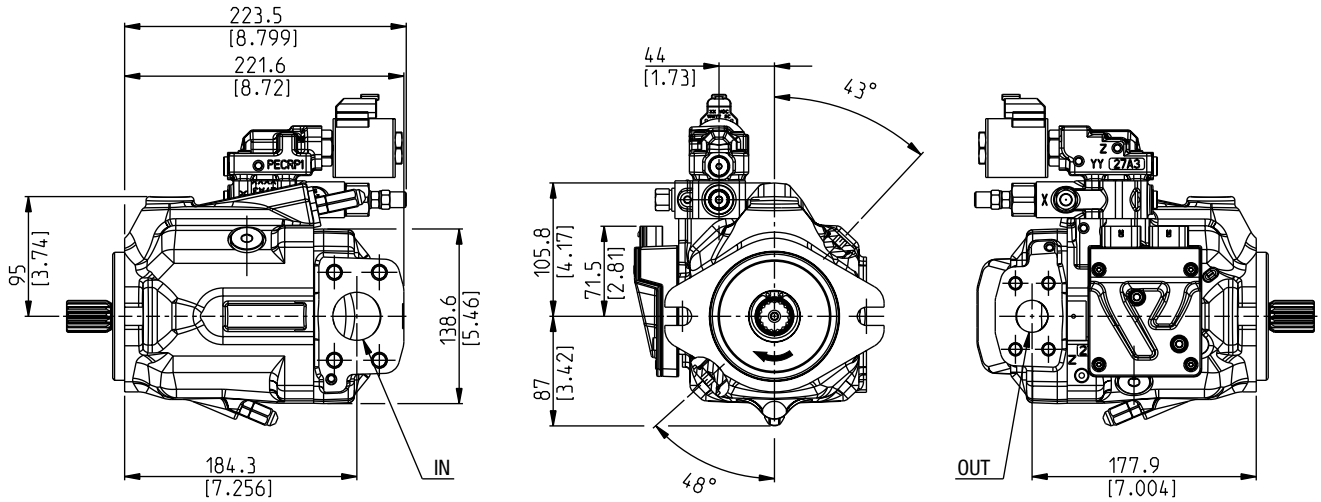

DCAT\_066\_017

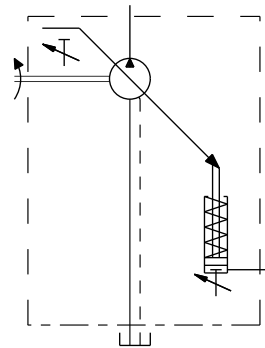
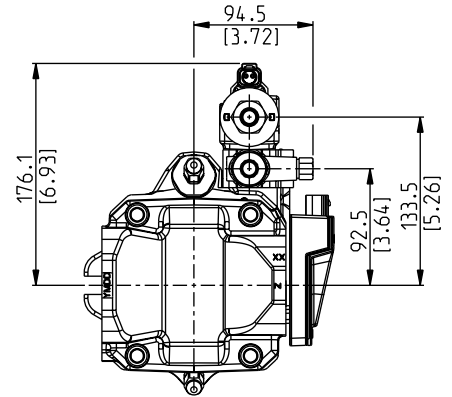
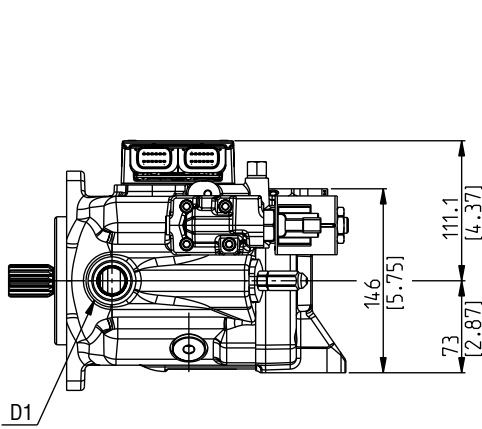

02/02.2023

**MVPE48**

**REAR PORTS - DIMENSIONS**

**P**

Drive shafts: see page 30  
 Mounting flanges: see page 32  
 Ports: see page 34 ÷ 36

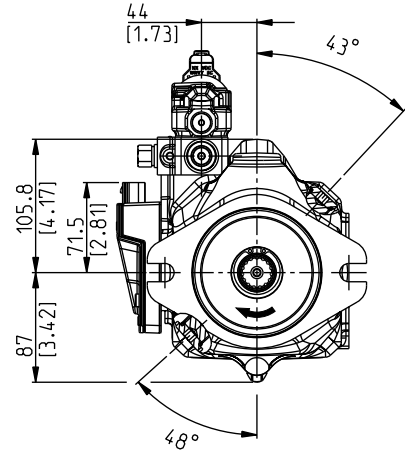
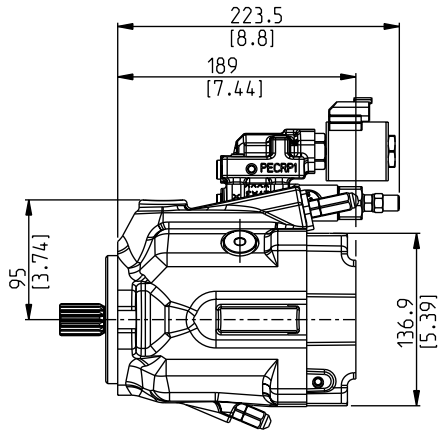
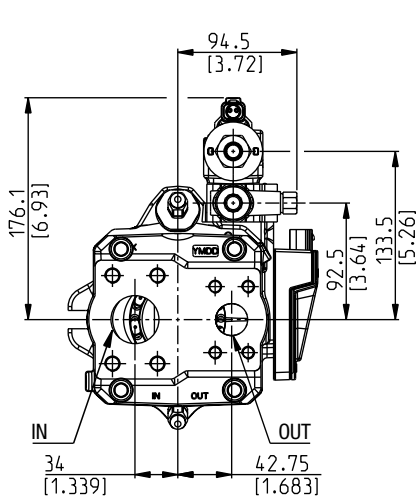

DCAT\_066\_018

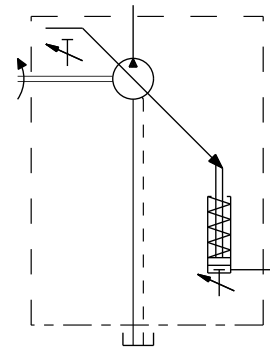
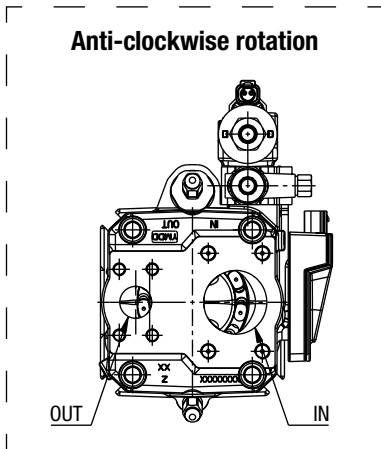
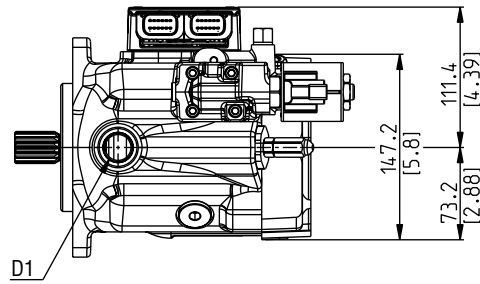

02/02.2023

**MVPE48/KP20**

**MULTIPLE PUMPS - DIMENSIONS**

**L**

Common inlet intermediate flange:  
MVPE code **P7**  
KP20 code **N5**

Drive shafts: see page 30  
Mounting flanges: see page 32  
Ports: see page 34 ÷ 36

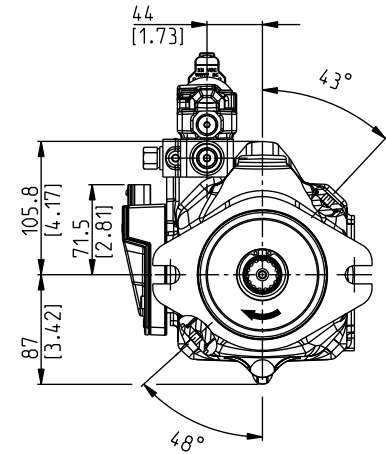
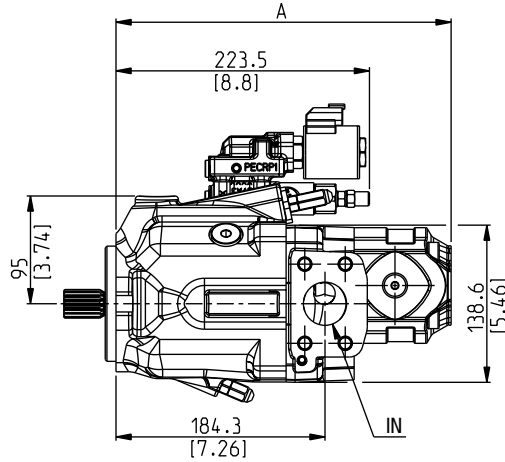
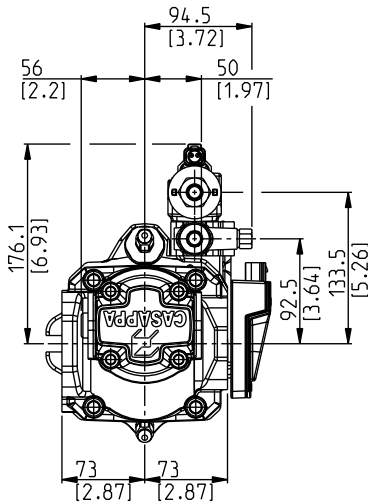

DCAT\_066\_019

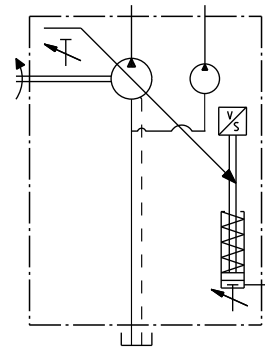
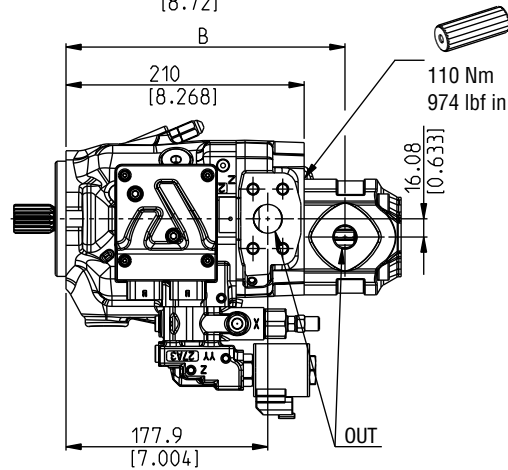
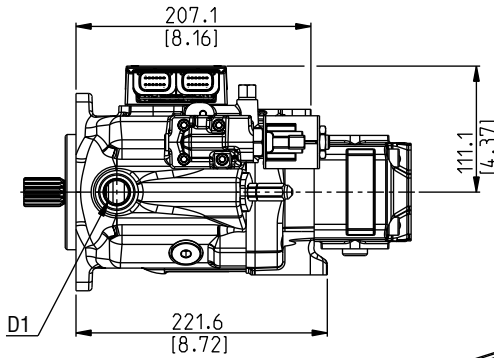

Gear pump KAPPA 20 (for more information please see the respective technical catalogue)

Pump type	<b>4</b>	<b>6,3</b>	<b>8</b>	<b>11,2</b>	<b>14</b>	<b>16</b>	<b>20</b>	Dimensions
<b>MVPE48</b>	263 (10.35)	265,5 (10.45)	268 (10.55)	271,5 (10.69)	275,5 (10.85)	281 (11.06)	287,5 (11.32)	mm (in) <b>A</b>
	234 (9.21)	236,5 (9.31)	239 (9.41)	242,5 (9.55)	241 (9.49)	246,5 (9.70)	253 (9.96)	mm (in) <b>B</b>

02/02.2023

**MVPE48/PHP20**

**MULTIPLE PUMPS - DIMENSIONS**

**L**

Common inlet intermediate flange:  
MVPE code **I7**  
PHP20 code **S7**

Drive shafts: see page 30  
Mounting flanges: see page 32  
Ports: see page 34 ÷ 36

Also available in  
combination with PLP20

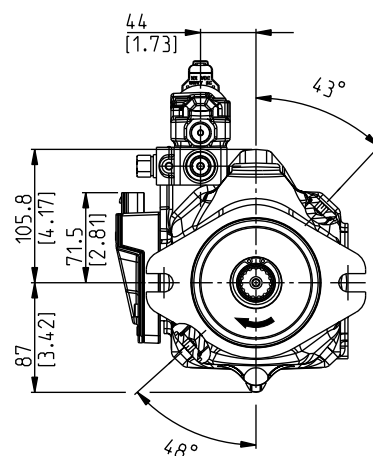
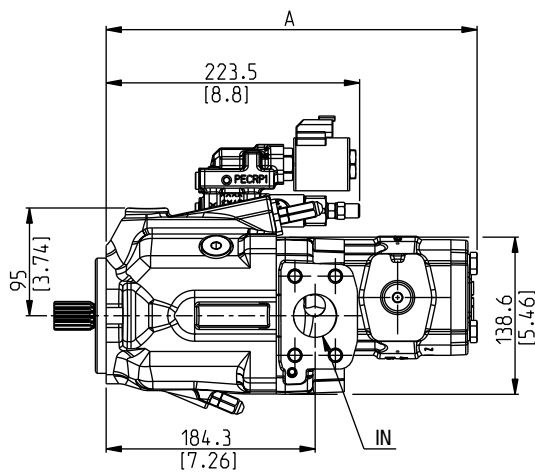
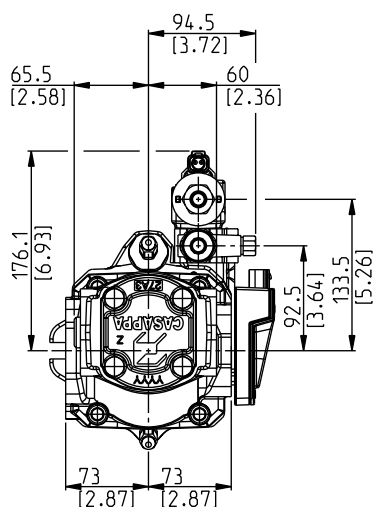

DCAT\_066\_020

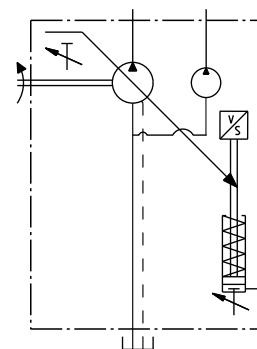
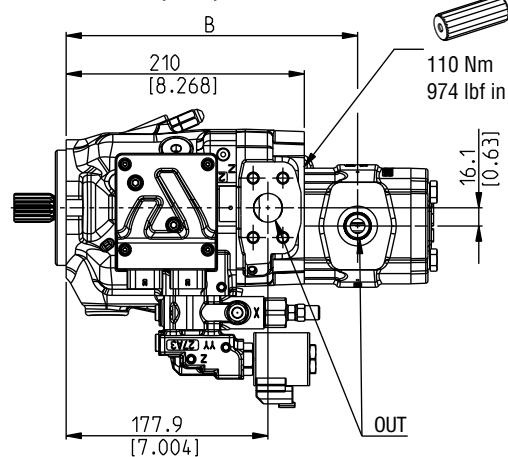
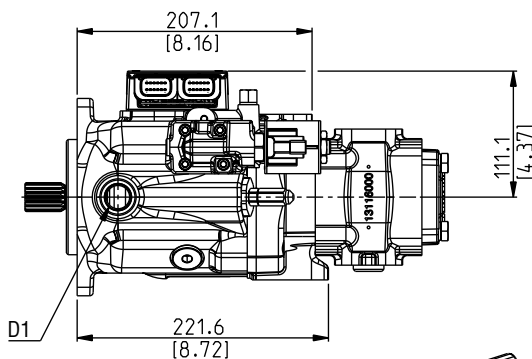

02/02.2023

Gear pump POLARIS PH20 (for more information please see the respective technical catalogue)

Pump type	8	10,5	11,2	14	16	18	19	20	23	24,5	25	27,8	31,5	Dimensions
<b>MVPE48</b>	290,1 (11.42)	294,1 (11.58)	294,6 (11.60)	299,6 (11.80)	303,1 (11.93)	305,3 (12.02)	306,5 (12.07)	309,6 (12.19)	313,1 (12.33)	315,4 (12.42)	317,1 (12.48)	319,9 (12.59)	327,1 (12.88)	mm (in)
	243,5 (9.59)	246,5 (9.70)	247 (9.72)	252 (9.92)	255 (10.04)	245,9 (9.68)	246,5 (9.70)	248 (9.76)	249,7 (9.83)	250,8 (9.87)	252 (9.92)	253,4 (9.97)	257 (10.12)	mm (in)

**MVPE60**

**SIDE PORTS - DIMENSIONS**

**L**

Drive shafts: see page 31  
 Mounting flanges: see page 32 ÷ 33  
 Ports: see page 34 ÷ 36

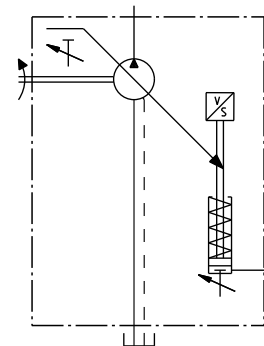
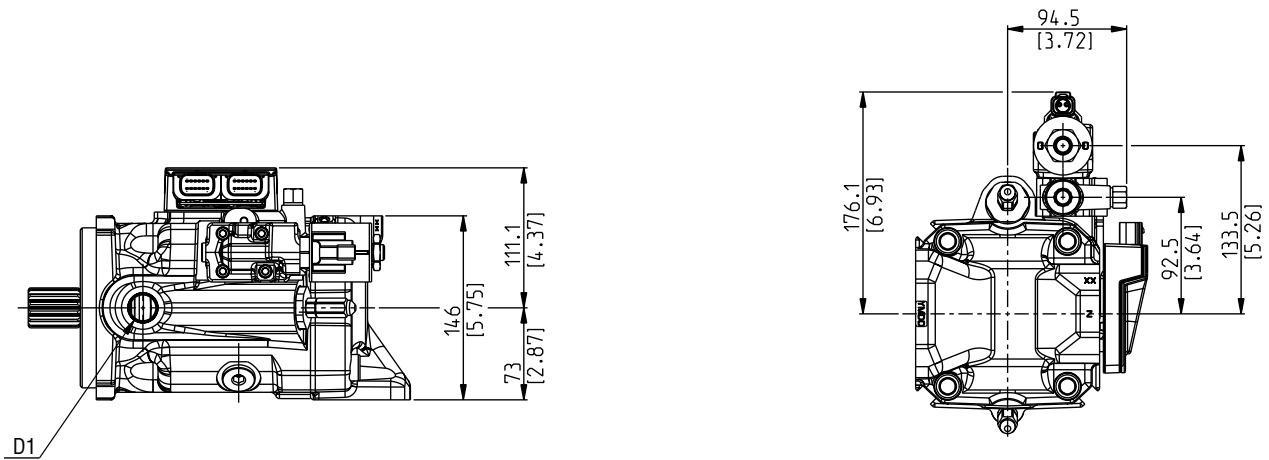
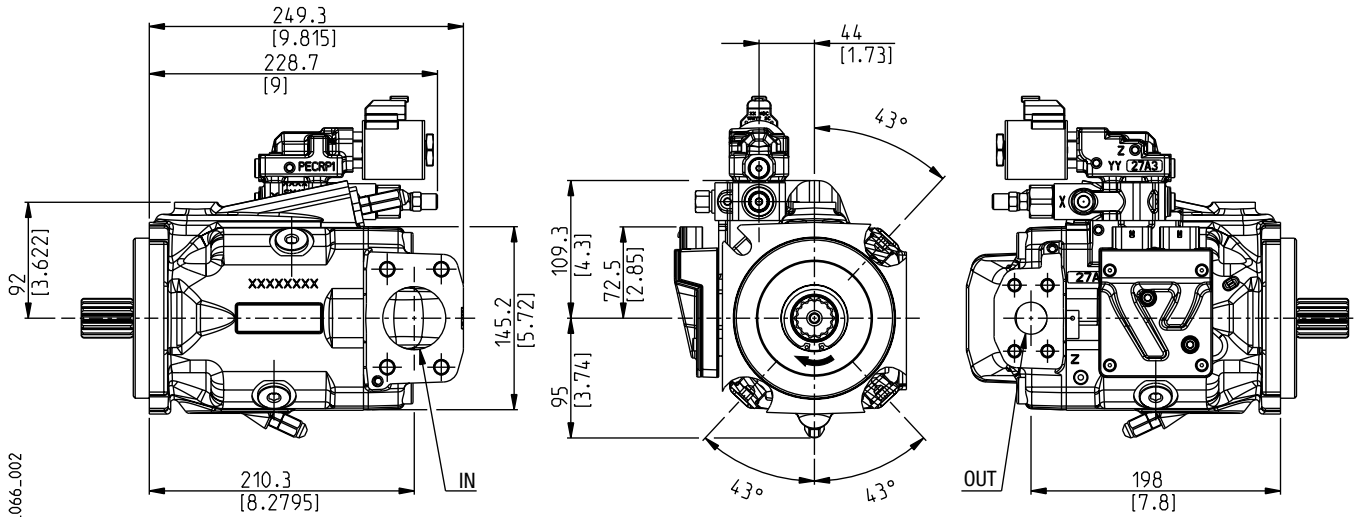

01/08.2022

**MVPE60**

**REAR PORTS - DIMENSIONS**

**P**

Drive shafts: see page 31  
 Mounting flanges: see page 32 ÷ 33  
 Ports: see page 34 ÷ 36

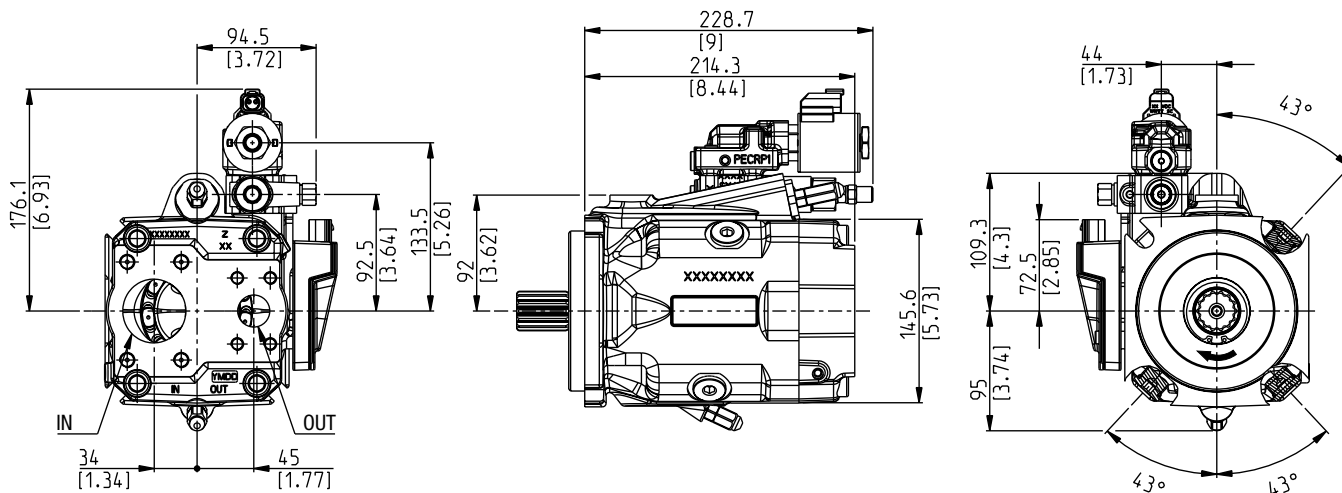

DCAT\_066\_003

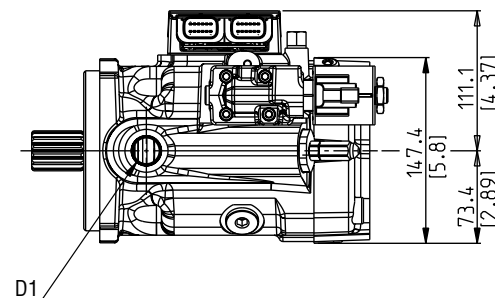

**Anti-clockwise rotation**

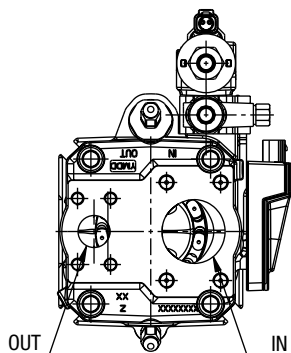

01/08.2022

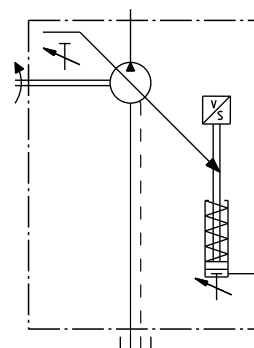

**MVPE60/KP20**

**MULTIPLE PUMPS - DIMENSIONS**

**L**

Common inlet intermediate flange:  
MVPE code **P7**  
KP20 code **N5**

Drive shafts: see page 31  
Mounting flanges: see page 32 ÷ 33  
Ports: see page 34 ÷ 36

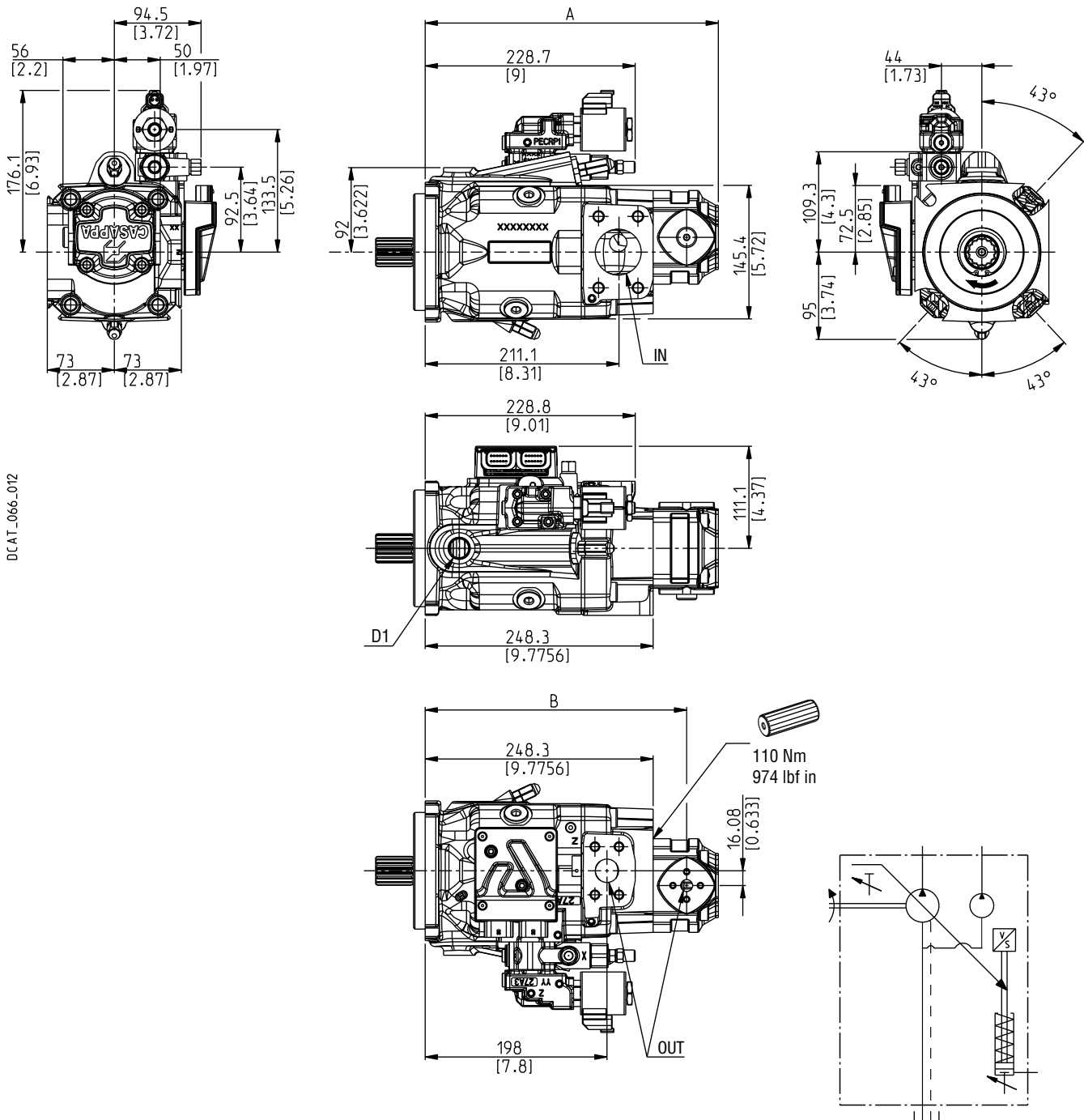

Gear pump KAPPA 20 (for more information please see the respective technical catalogue)

Pump type	4	6,3	8	11,2	14	16	20	Dimensions
<b>MVPE60</b>	301,3 (11.86)	303,8 (11.96)	306,3 (12.06)	309,8 (12.20)	313,8 (12.35)	319,3 (12.57)	325,8 (12.83)	mm (in) <b>A</b>
	272,3 (10.72)	274,8 (10.82)	277,3 (10.92)	280,8 (11.06)	279,3 (11.00)	284,8 (11.21)	291,3 (11.47)	mm (in) <b>B</b>

01/08.2022

**MVPE60/PHP20**

**MULTIPLE PUMPS - DIMENSIONS**

**L**

Common inlet intermediate flange:  
MVPE code **I7**  
PHP20 code **S7**

Drive shafts: see page 31  
Mounting flanges: see page 32 ÷ 33  
Ports: see page 34 ÷ 36

Also available in  
combination with PLP20

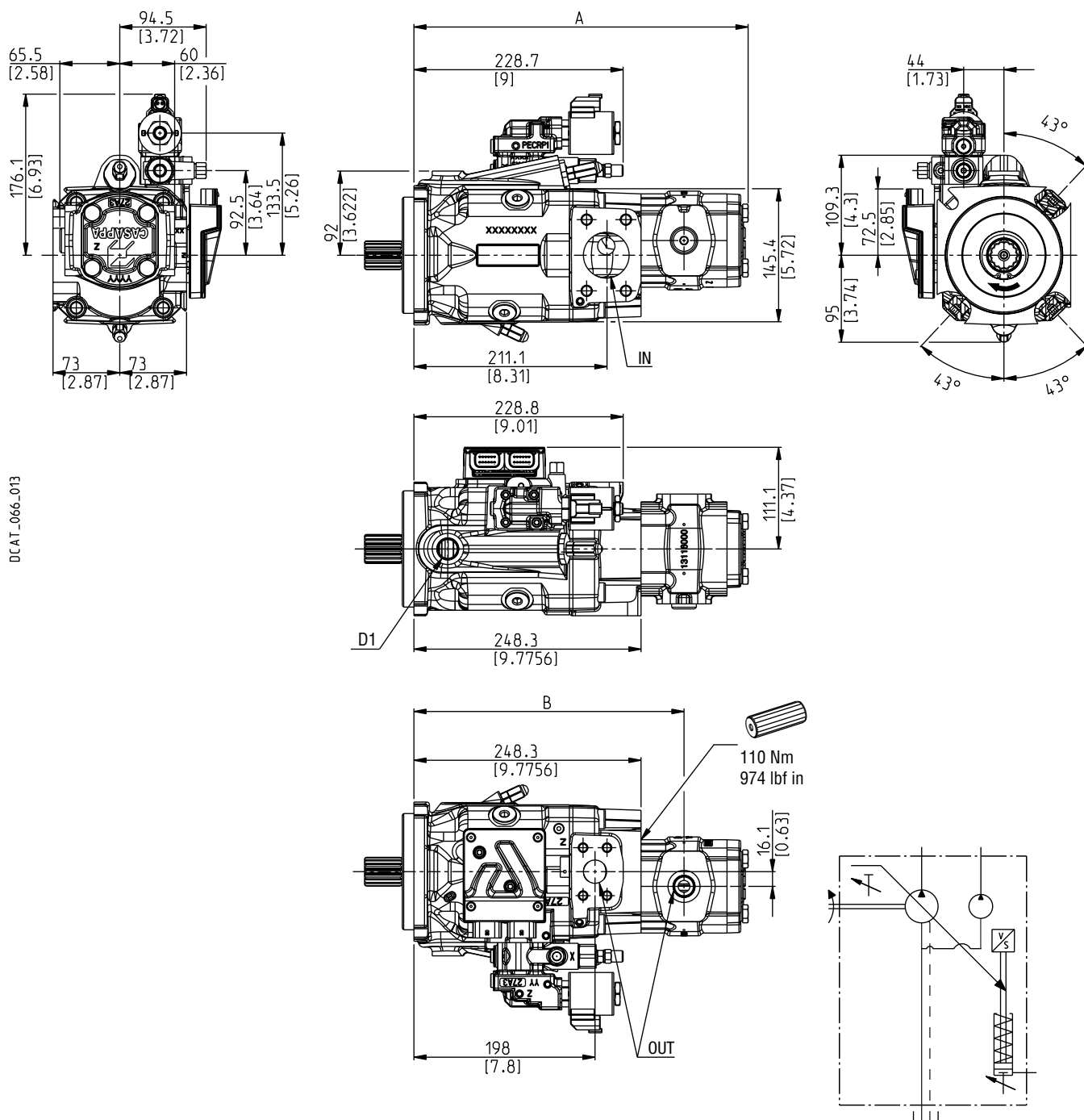

DCAT\_066\_013

01/08.2022

Gear pump POLARIS PH20 (for more information please see the respective technical catalogue)

Pump type	8	10,5	11,2	14	16	18	19	20	23	24,5	25	27,8	31,5	Dimensions
<b>MVPE60</b>	328,4 (12.93)	332,4 (13.09)	332,9 (13.11)	337,9 (13.30)	341,4 (13.44)	343,6 (13.53)	344,8 (13.57)	347,9 (13.70)	351,4 (13.83)	353,7 (13.93)	355,4 (13.99)	358,2 (14.10)	365,4 (14.39)	mm (in) <b>A</b>
	281,8 (11.09)	284,8 (11.21)	285,3 (11.23)	290,3 (11.43)	293,3 (11.55)	284,2 (11.19)	284,8 (11.21)	286,3 (11.27)	288 (11.34)	289,1 (11.38)	290,3 (11.43)	291,7 (11.48)	295,3 (11.63)	mm (in) <b>B</b>

**MVPE48**

**DRIVE SHAFTS**

**SAE "B" SPLINE**

**04**

Mounting face refers to flange code **S5**

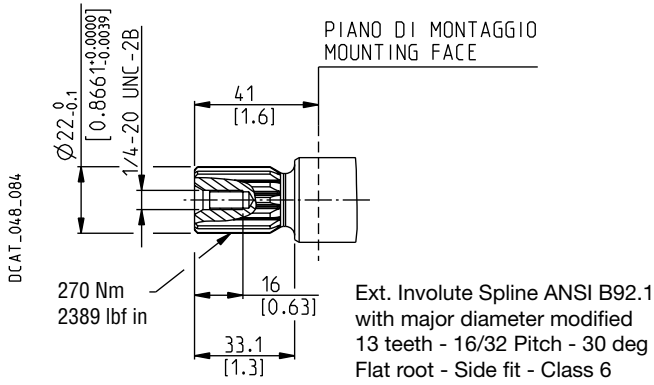

**SAE "B" SPLINE**

**4R**

Mounting face refers to flange code **S5**

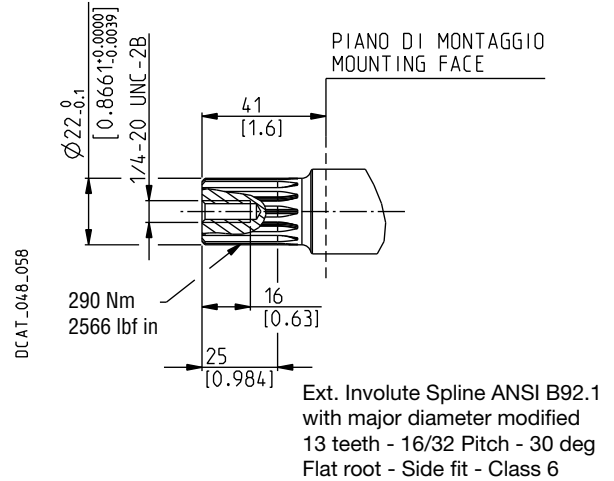

**SAE "BB" SPLINE**

**05**

Mounting face refers to flange code **S5**

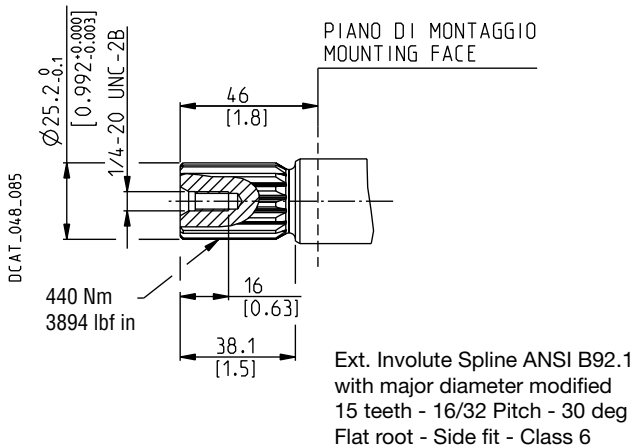

**SAE "BB" SPLINE**

**5R**

Mounting face refers to flange code **S5**

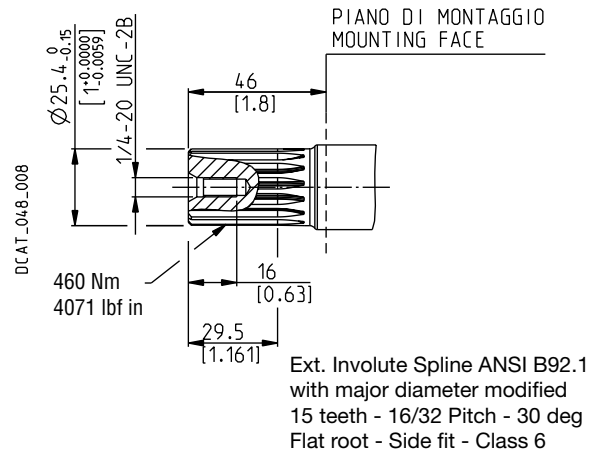

**SAE "B" STRAIGHT**

**32**

Mounting face refers to flange code **S5**

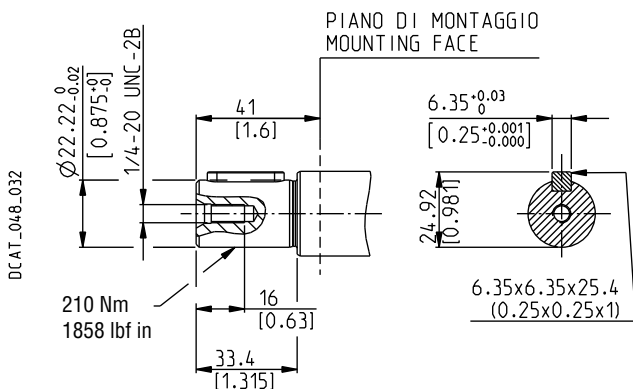

Please contact us for different drive shafts.

02/02.2023

**MVPE60**

**DRIVE SHAFTS**

**SAE "B" SPLINE**

**04**

Mounting face refers to flange code **S5**

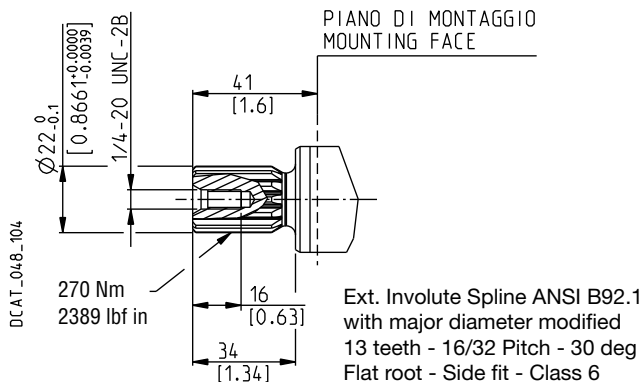

**SAE "BB" SPLINE**

**05**

Mounting face refers to flange code **S5**

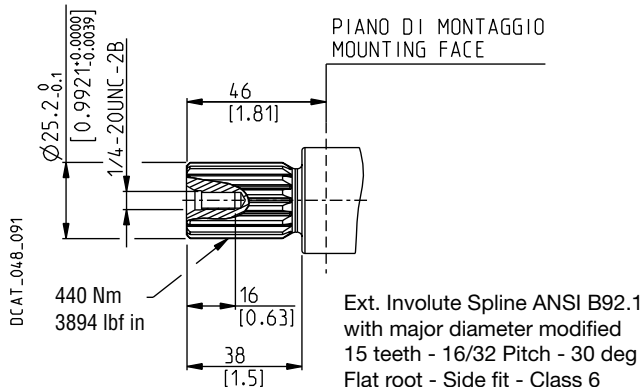

**SAE "BB" SPLINE**

**5R**

Mounting face refers to flange code **S5**

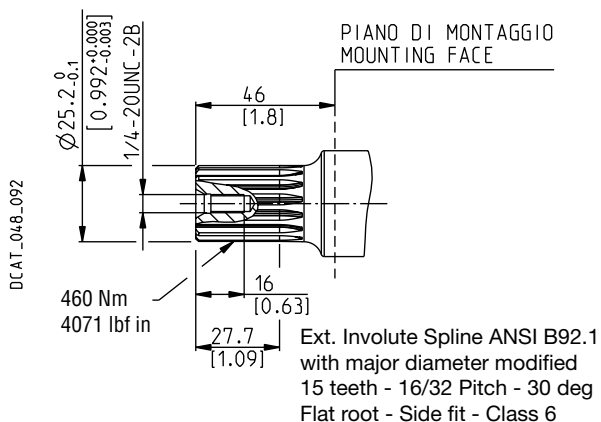

**SAE "C" SPLINE**

**06**

Mounting face refers to flange code **S7** and **S8**

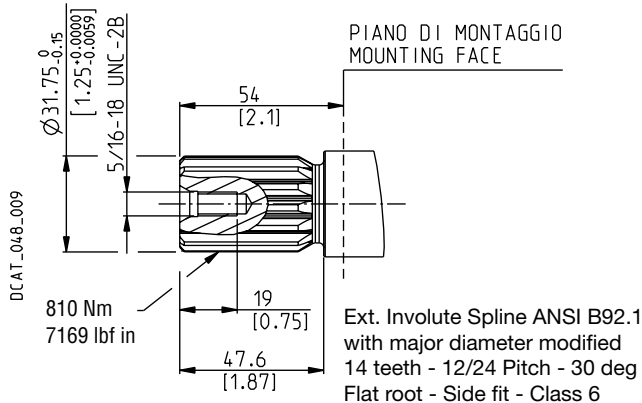

**SAE "C" SPLINE**

**6R**

Mounting face refers to flange code **S7** and **S8**

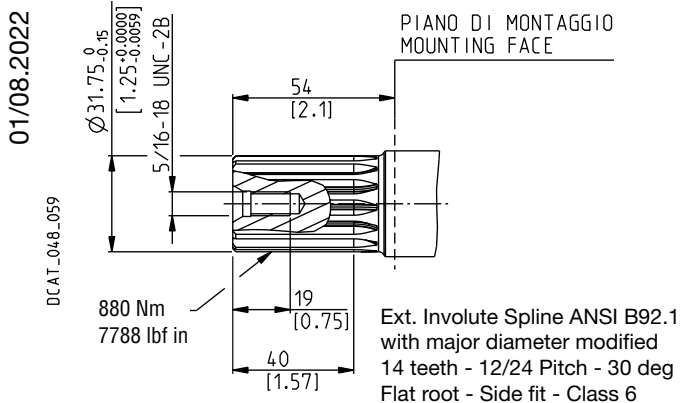

**SAE "C" STRAIGHT**

**34**

Mounting face refers to flange code **S8**

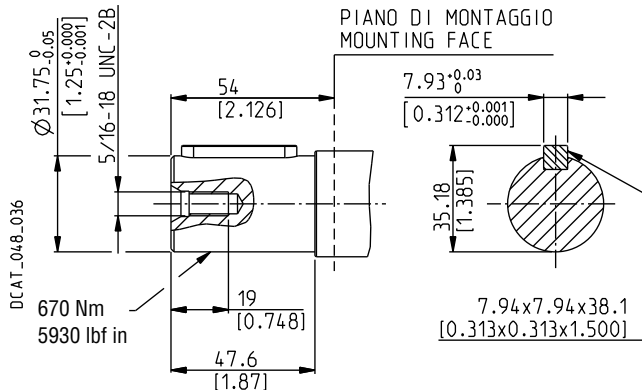

Please contact us for different drive shafts.

# MOUNTING FLANGES AND TABLE OF COMPATIBILITY

## SAE "B" 2 HOLES

**S5**

Conforms to SAE J744

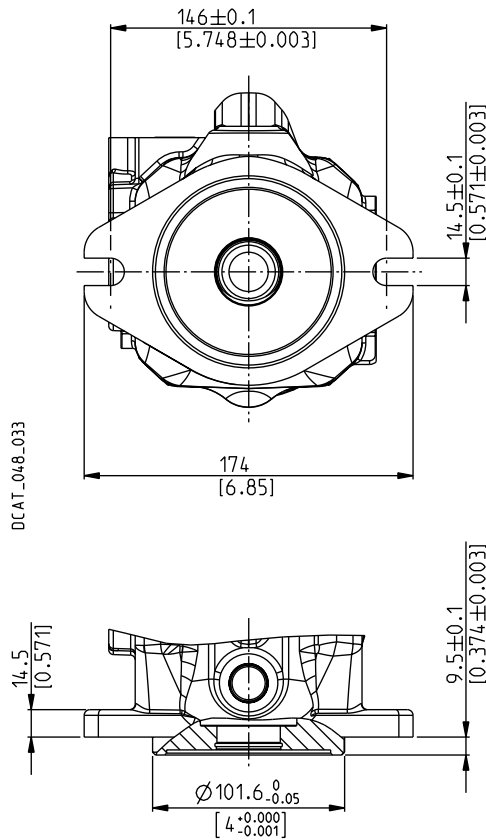

## SAE "C" 2 HOLES

**S7**

Conforms to SAE J744

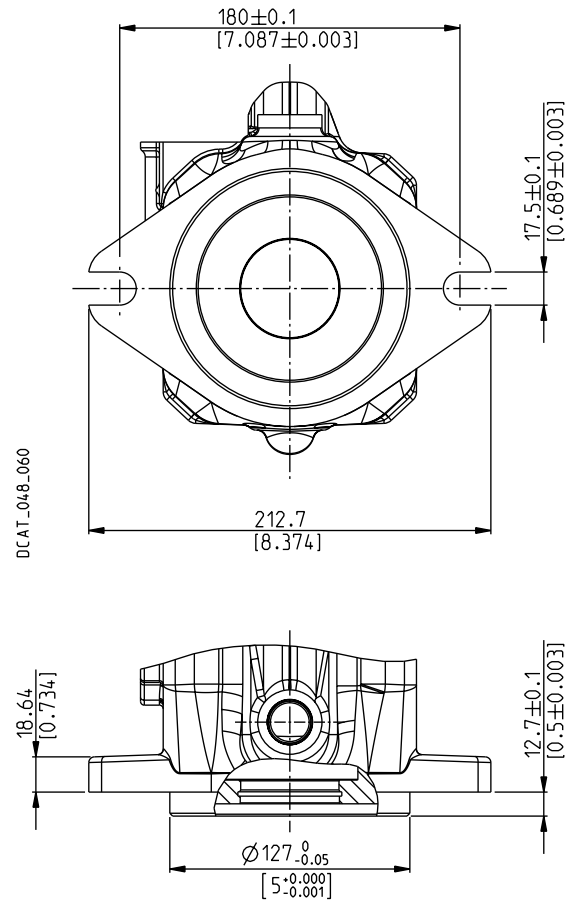

Replaces: 01/08.2022

### DRIVE SHAFTS

See page 30 ÷ 31

Pump type	04	4R	32	05	5R	06	6R	34
<b>MVPE48</b>	X	X	X	X	X			
<b>MVPE60</b>	X			X	X	X	X	X

X Available combination

### DRIVE SHAFTS

See page 31

Pump type	04	05	5R	06	6R	34
<b>MVPE60</b>	X	X	X	X	X	X

X Available combination

02/02.2023

## MOUNTING FLANGES AND TABLE OF COMPATIBILITY

### SAE "C" 4 HOLES

**S8**

Conforms to SAE J744

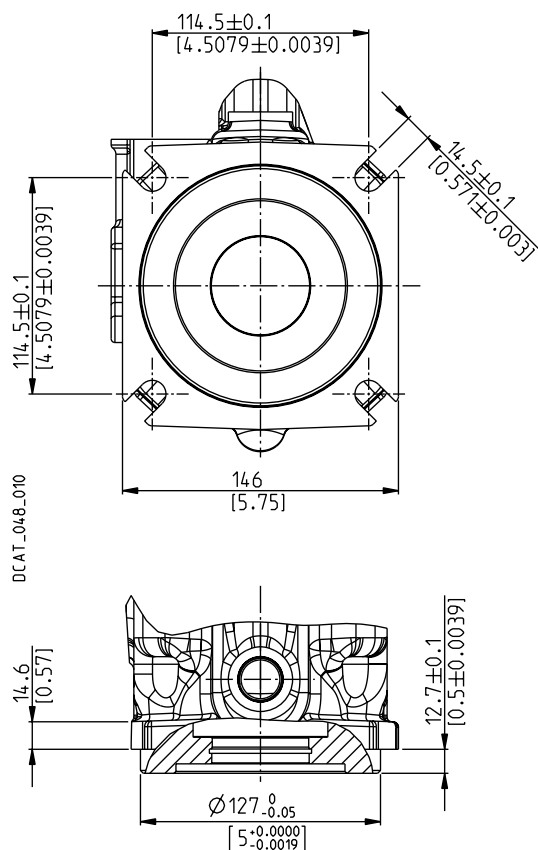

#### DRIVE SHAFTS

See page 31

Pump type	04	05	5R	06	6R	34
<b>MVPE60</b>	X	X	X	X	X	X

X Available combination

01/08.2022

## PORTS TYPE

Ports type	INLET / OUTLET PORTS						DRAIN PORTS		LOAD SENSING PORTS (X)		KP20 / PHP20 GEAR PUMPS	
	Split SSM		Split SSS		SAE ODT		Gas BSPP	SAE ODT (●)	Gas BSPP (●)	SAE ODT	Gas BSPP	SAE ODT
	IN	OUT	IN	OUT	IN	OUT	D1 - D2 - D3 - D4		X	X	OUT	OUT
<b>MVPE48</b>	ME	MC	SE	SC	OH (■)	OF (■)	GD	OC	GA	03	GD	OC
<b>MVPE60</b>	MF	MC	SF	SC	MF	OF	GD	OC	GA	03	GD	OC

(X) Load sensing port. Please contact us for more information.

(●) Standard.

(■) Only for rear ports.

Replaces: 01/08.2022

## DRAIN PORTS POSITION

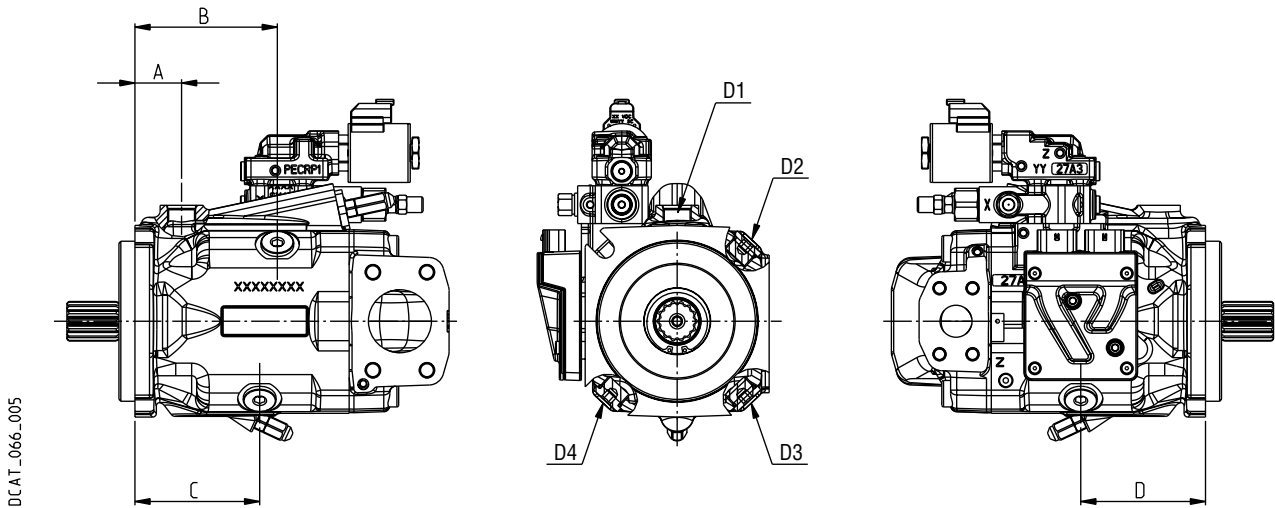



DCAT\_066\_005

02/02.2023

Pump type	A	B	C	D
	mm (in)	mm (in)	mm (in)	mm (in)
<b>MVPE48</b>	36 (1.42)	97 (3.82)	—	97 (3.82)
<b>MVPE60</b>	37 (1.46)	113 (4.45)	99 (3.90)	99 (3.90)

**PORTS TYPE**

 Tightening torque for low pressure side port

 Tightening torque for high pressure side port



Replaces: 01/08.2022

**SAE FLANGED PORTS J518 - Standard pressure series 3000 psi - Code 61**

**SSM**

Metric thread ISO 60° conforms to ISO/R 262

○

CODE	Nominal size	A	B	C	D		
		mm (in)	mm (in)	mm (in)	Thread Depth mm (in)	Nm (lbf in)	Nm (lbf in)
<b>MC</b>	1"	25,4 (1.00)	52,4 (2.06)	26,2 (1.03)	M 10 17 (0.67)	—	30 <sup>+2,5</sup> (266 ÷ 288)
<b>ME</b>	1" 1/2	38,1 (1.50)	69,8 (2.75)	35,7 (1.41)	M 12 20 (0.79)	30 <sup>+2,5</sup> (266 ÷ 288)	—
<b>MF</b>	2"	51 (2.01)	77,8 (3.06)	42,9 (1.69)	M 12 20 (0.79)	30 <sup>+2,5</sup> (266 ÷ 288)	—

DCAT\_006\_025\_21064252

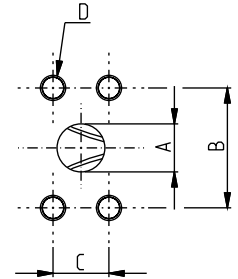



**SAE FLANGED PORTS J518 - Standard pressure series 3000 psi - Code 61**

**SSS**

American straight thread UNC-UNF 60° conforms to ANSI B 1.1

○

CODE	Nominal size	A	B	C	D		
		mm (in)	mm (in)	mm (in)	Thread Depth mm (in)	Nm (lbf in)	Nm (lbf in)
<b>SC</b>	1"	25,4 (1.00)	52,4 (2.06)	26,2 (1.03)	3/8 - 16 UNC-2B 17 (0.67)	—	35 <sup>+2,5</sup> (310 ÷ 332)
<b>SE</b>	1" 1/2	38,1 (1.50)	69,8 (2.75)	35,7 (1.41)	1/2 - 13 UNC-2B 20 (0.79)	30 <sup>+2,5</sup> (266 ÷ 288)	—
<b>SF</b>	2"	51 (2.01)	77,8 (3.06)	42,9 (1.69)	1/2 - 13 UNC-2B 20 (0.79)	30 <sup>+2,5</sup> (266 ÷ 288)	—

DCAT\_006\_025\_21064252

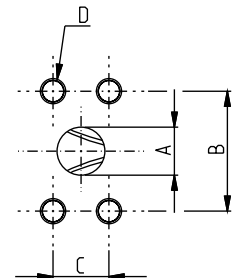

○ 02/02.2023

**PORTS TYPE**

 Tightening torque for low pressure side port

 Tightening torque for high pressure side port

**SAE STRAIGHT THREAD PORTS J514**

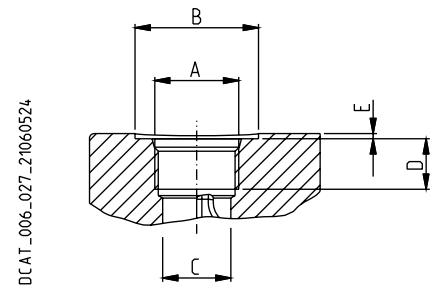

**ODT**

American straight thread UNC-UNF 60° conforms to ANSI B 1.1



Replaces: 01/08.2022

○

CODE	Nominal size	A	Ø B	Ø C	D	E		
							Nm (lbf in)	Nm (lbf in)
<b>03 (X)</b>	1/4"	7/16" - 20 UNF - 2B	—	9,5 (0.37)	—	—	—	12 <sup>+1</sup> (106 ÷ 115)
<b>0C (●)</b>	5/8"	7/8" - 14 UNF - 2B	35 (1.38)	20,5 (0.81)	—	2 (0.08)	30 +2,5 (266 ÷ 288)	—
<b>0C (◆)</b>			34 (1.34)	20,5 (0.81)	17 (0.67)	0,5 (0.02)	—	70 <sup>+5</sup> (620 ÷ 664)
<b>0F</b>	1"	1 5/16" - 12 UNF - 2B	—	30,5 (1.20)	20 (0.79)	—	—	170 <sup>+10</sup> (1505 ÷ 1593)
<b>0H</b>	1" 1/2	1 7/8" - 12 UNF - 2B	—	45 (1.77)	20 (0.79)	—	100 <sup>+5</sup> (885 ÷ 929)	—

(X) = Load sensing port - (●) = Drain port - (◆) = KP20 / PHP20 outlet port



**GAS STRAIGHT THREAD PORTS**

**BSPP**

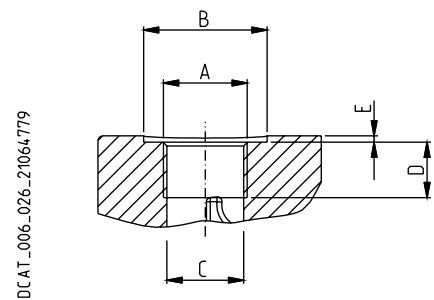
British standard pipe parallel (55°) conforms to UNI - ISO 228



○ 02/02.2023

CODE	Nominal size	A	Ø B	Ø C	D	E		
							Nm (lbf in)	Nm (lbf in)
<b>GA (X)</b>	1/8"	G 1/8	—	8,75 (0.34)	12 (0.47)	—	—	5 <sup>+0,25</sup> (44 ÷ 46)
<b>GD (●)</b>	1/2"	G 1/2	30 (1.18)	19 (0.75)	17 (0.67)	2 (0.08)	20 <sup>+1</sup> (177 ÷ 186)	—
<b>GD (◆)</b>			—	19 (0.75)	17 (0.67)	—	—	50 <sup>+2,5</sup> (443 ÷ 465)

(X) = Load sensing port - (●) = Drain port - (◆) = KP20 / PHP20 outlet port

## INTEGRATED ELECTRONIC CONTROL UNIT

- 32 bit floating point Power-PC running at 120 Mhz
- 12 bit A/D converter
- CAN 2.0B port
- 2 Output stages with pulse-width-modulated current regulation (PWM)
- Download the software from a PC to the flash memory
- Can be used in all type of mobile operating machines (agriculture, forestry, building construction)
- The CAN BUS is available with CAN open and SAE J1939 standard

### Working conditions

Power supply	8 ÷ 32 V DC
Operating temperature	-40 ÷ 105 °C (-40 ÷ 221 °F)
Max output current	3 A - 12 V DC
Current consumption	< 200 mA
Short circuit immunity	Against ground Against Vbb
Reverse polarity protection	Power supply lines

### EMC protection

Radiated emission	Reference standards: UNI EN 14982 • Frequency range: 30 MHz ÷ 1 GHz
Radiated immunity	Reference standards: ISO11452-2 • Frequency range: 200 MHz ÷ 1 GHz Test level: 100 V/m • Frequency range: 1 GHz ÷ 2 GHz Test level: 50 V/m
Conducted immunity	Reference standards: ISO11452-4 • Frequency range: 20 MHz ÷ 220 MHz Test level: 100 mA
Load dump protection	Reference standards: ISO 7637-2 • Test level: 151 V
Electrostatic discharge	Reference standards: ISO 10605 • ±4, ±6, ±8, ±15 kV (Indirect discharge) • ±4, ±6, ±8, ±15 kV (Air discharge)

### Input / Output

Analog input	4
Temperature sensor input	1
Digital/Frequency input	1
CAN BUS	1
Bluetooth	No
Proportional output	2 High Side drive 2A 2 Low Side drive 2A with current feedback

### Swashplate angular sensor

Output signal	Proportional to swashplate angular position
Angular sensor resolution	0,025 % Vcc
Angular sensor repeatability	0,2°

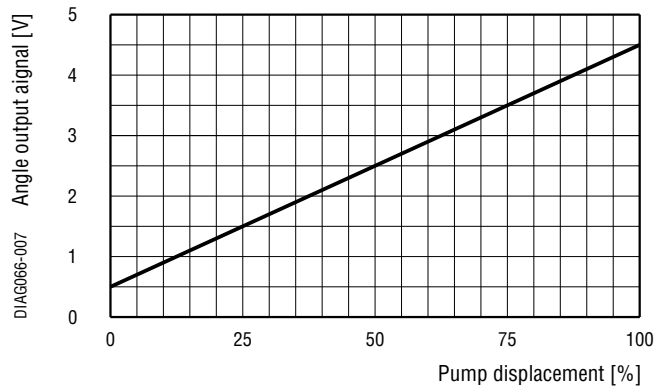

### Environmental resistance

Random noise	Reference standards: EN 60068-2-64 • ASD = 0.1g <sup>2</sup> (RMS 3,3 g) • f = 10...1000Hz • Duration per axis (xyz): 8 h
Mechanical shock	Reference standards: EN 60068-2-29 • Type of shock: Half sine • Acceleration amplitude: = 40 g • Shock duration: 6 ms • 100 positive shocks for each axes • 100 negative shocks for each axes
IP67 Protection	Reference standards: EN 60529
IP6K9K Protection	Reference standards: ISO 20653
Temperature cycle test	Reference standards: ISO 16750-4 • Temperature: -40 ÷ 115 °C (-40 ÷ 239 °F) • Number of cycles: 30
Temperature shock test	Reference standards: ISO 16750-4 • 60min @ -40 °C (-40 °F) • 20min @ 115 °C (239 °F) • Number of cycles: 20
Low temperature test	Reference standards: ISO 16750-4 • Temperature: -40 °C (-40 °F) • Test duration: 24 h
High temperature test	Reference standards: ISO 16750-4 • Temperature: 115 °C (239 °F) • Test duration: 48 h

01/08.2022

## INTEGRATED ELECTRONIC CONTROL UNIT

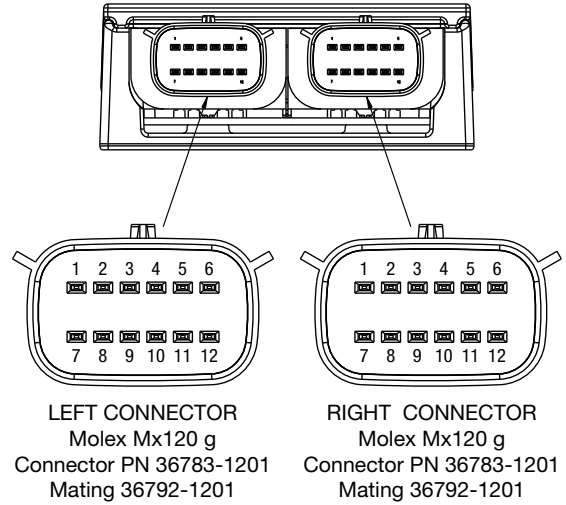
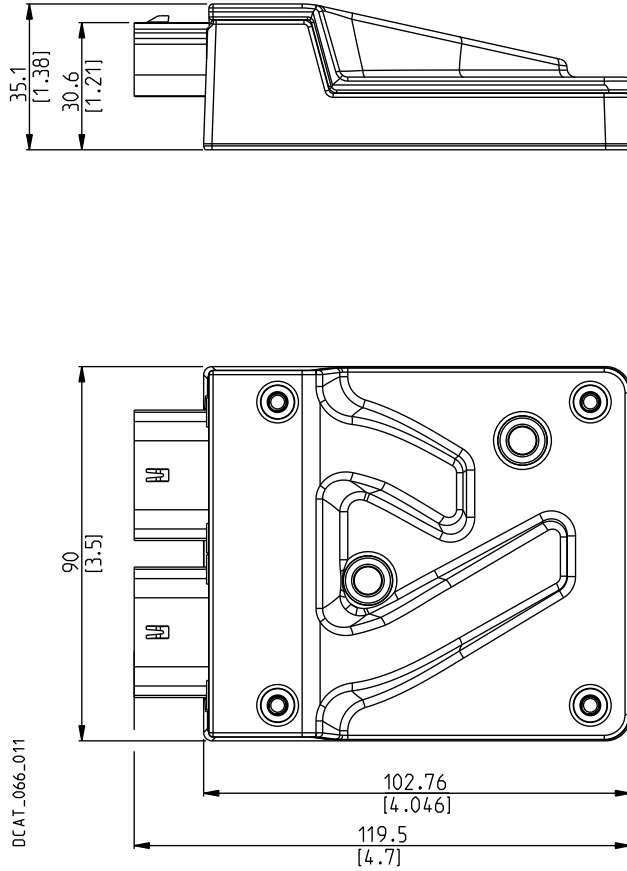

### LEFT CONNECTOR - Pinout

Pin	Function
1	Analog input 0
2	Analog input 1
3	Digital input
4	CAN termination
5	CAN LOW
6	GND
7	CAN LOW
8	CAN HIGH
9	Analog Ground
10	Machine Key signal
11	CAN HIGH
12	Power VBB

### RIGHT CONNECTOR - Pinout

Pin	Function
1	Resistive input 0
2	Analog input 2
3	Proportional output PWM B-
4	Proportional output PWM B+
5	Proportional output PWM A-
6	Proportional output PWM A+
7	Analog Ground
8	Angle out
9	5 V
10	Analog input 3
11	Analog input 4
12	Power VBB

01/08.2022

**PRESSURE ELECTRONIC COMPENSATOR PLUS ANGULAR SENSOR**

**PECA**

Regulates the pump displacement automatically to maintain the pressure below the variable limit set through a command current signal. The swivel angular sensor converts the actual position of the swashplate into a voltage output signal that can be used for different purposes. This signal and the proportional relief valve allow to realise the following different control logics by means of an external control unit:

- Variable maximum pressure limiter
- Electronic flow compensator with variable setting (variable Load-Sensing)
- Electronic torque limiter with variable torque setting
- Power limiter
- Flow control
- Working e-modes

**OPERATING CURVES**

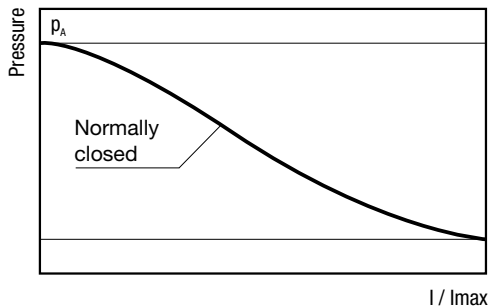

Valve code	Arrangement	Voltage
<b>1</b>	Normally closed	12 V DC
<b>2</b>	Normally closed	24 V DC

Connector type	DIN 43650/		DEUTSCH DT04-2P	
	12 V DC	24 V DC	12 V DC	24 V DC
Voltage	12 V DC	24 V DC	12 V DC	24 V DC
Power	18 W	19 W	18 W	19 W
Resistance @ 20 °C (68 °F)	8 Ω	30 Ω	8 Ω	30 Ω
Limit current	1500 mA	800 mA	1500 mA	800 mA
Dither frequency	200 Hz			
Operating temperature	-40 ÷ 100 °C (-40 ÷ 212 °F)			

01/08.2022

**NOTES**

X: Load-sensing port. Dimensions at page 34 ÷ 36.  
Please contact us for more information.

**PECA - LS2 (with flow control)**

Not included in supply

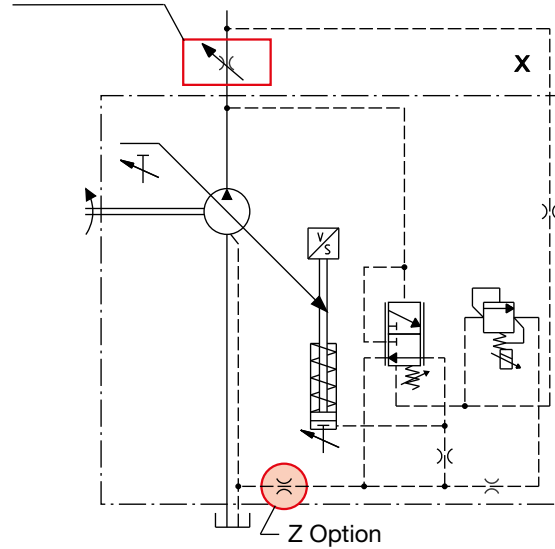

**Z OPTION**

Damping restrictor for critical applications. In case of system instability or pressure oscillations, the additional damping restrictor slows down the pump control system, damping the regulation transients. The pump recovery time increases. The use of the damping restrictor must be evaluated and approved by Casappa technical sales department for the specific application.

---

## NOTES

---

01/08.2022

## MULTIPLE PUMPS WITH THROUGH DRIVE

### THROUGH DRIVE

MVPE through drive axial piston pumps offer the flexibility to obtain different groups able to supply several hydraulic systems. The operating characteristics of each assembled pumps are the same as the corresponding single pumps according to the following conditions:

- 1) Do not exceed the maximum transmissible torque.
- 2) The maximum rotational speed is that of the lowest rated speed of the single unit incorporated.

Replaces: 01/08.2022

<b>M</b>	Nm (lbf in)	Torque
<b>V</b>	cm <sup>3</sup> /rev (in <sup>3</sup> /rev)	Displacement
<b>Δp</b>	bar (psi)	Pressure
$\eta_{hm} = \eta_{hm}(V, \Delta p, n)$		Hydro-mechanical efficiency

$$M = \frac{\Delta p \text{ (bar)} \cdot V \text{ (cm}^3\text{/rev)}}{62,83 \cdot \eta_{hm}} \quad [\text{Nm}]$$

Notes: The torque absorbed from the shaft of the first pump results from the sum of the torques due to all the single stages. The achieved value must not exceed the maximum torque limit given for the shaft of the first pump.

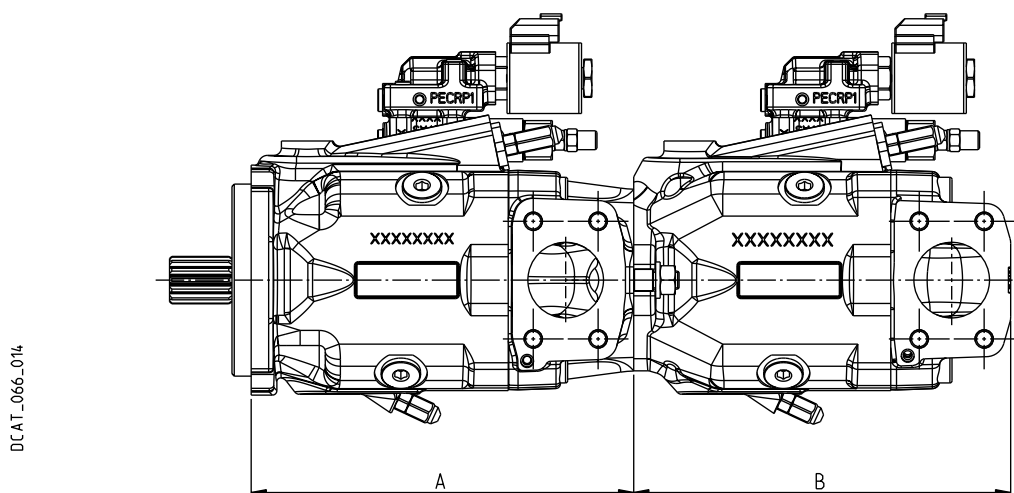

DCAT\_066\_014

- A:** Front section (through drive)  
**B:** MVPE Rear pump (the same of single pump with side or rear ports)  
 Gear rear pump are also available, please see the respective technical catalogues.

02/02.2023

Pump type	A	
	Flanged for	Code
<b>MVPE48</b>	SAE B	<b>AS5</b>
<b>MVPE60</b>	SAE B	<b>AS5</b>

**MVPE48**

**FRONT SECTION - DIMENSIONS**

**AS5**

Through drive SAE B

Drive shafts: see page 30  
Mounting flanges: see page 32  
Ports: see page 34 ÷ 36

The drawing shows a front section with clockwise rotation

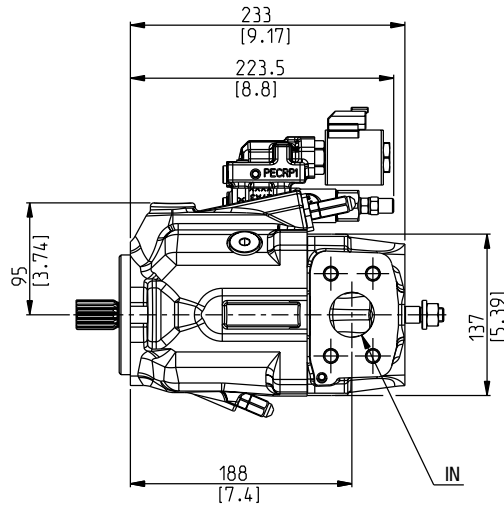
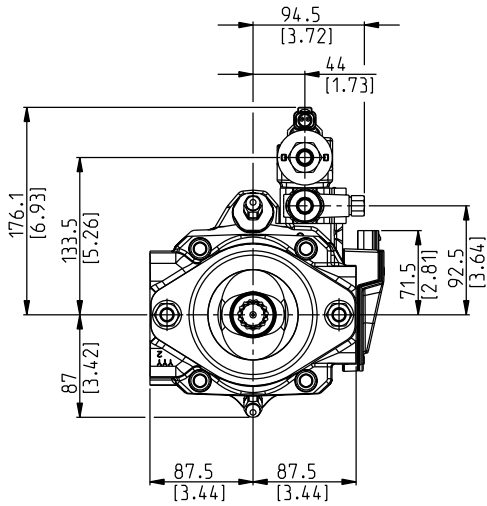

DCAT\_066\_021

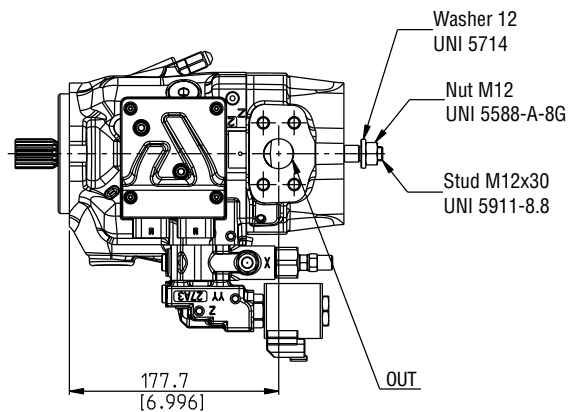
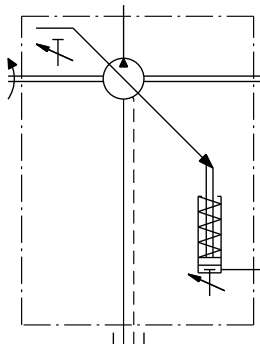
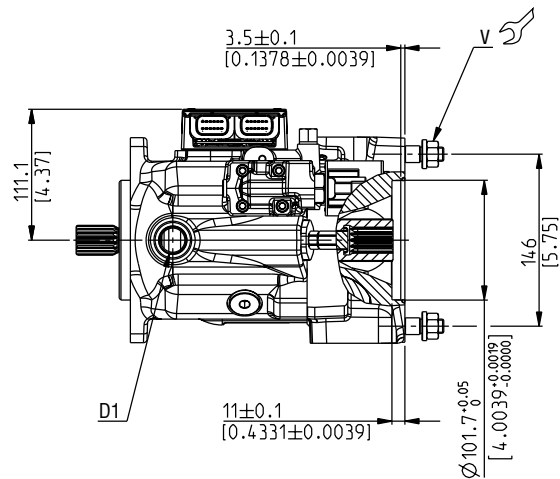

Screws tightening torque Nm (lbf in)

**V**

100 ±10  
(797 ÷ 974)

02/02.2023

**MVPE48**

**COUPLINGS - DIMENSIONS**

**SAE "B" SPLINE**

**04**

Available with flange code **AS5**

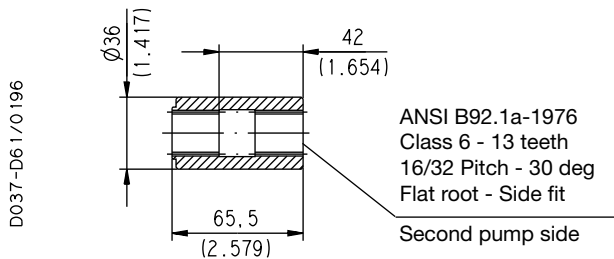

**MAX 200 Nm (1770 lbf in)**

**SAE "BB" SPLINE**

**05**

Available with flange code **AS5**

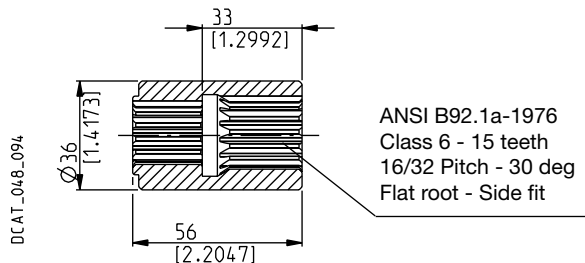

**MAX 250 Nm (2213 lbf in)**

**SAE "B" STRAIGHT**

**32**

Available with flange code **AS5**

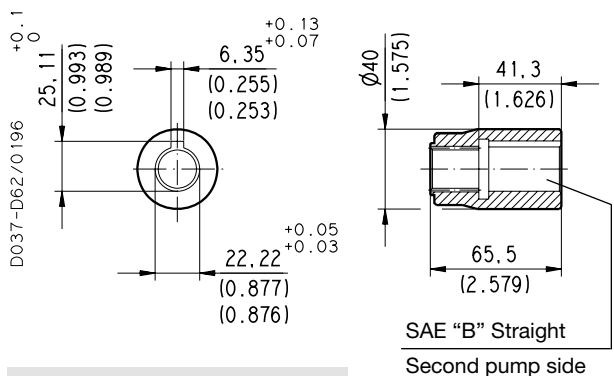

**MAX 250 Nm (2213 lbf in)**

**SAE "BB" STRAIGHT**

**33**

Available with flange code **AS5**

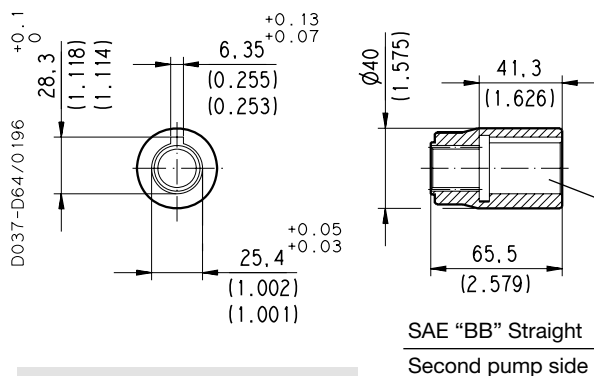

**MAX 250 Nm (2213 lbf in)**

02/02.2023

**MVPE60**

**FRONT SECTION - DIMENSIONS**

**AS5**

Through drive SAE B

Drive shafts: see page 31

Mounting flanges: see page 32 ÷ 33

Ports: see page 34 ÷ 36

The drawing shows a front section with clockwise rotation

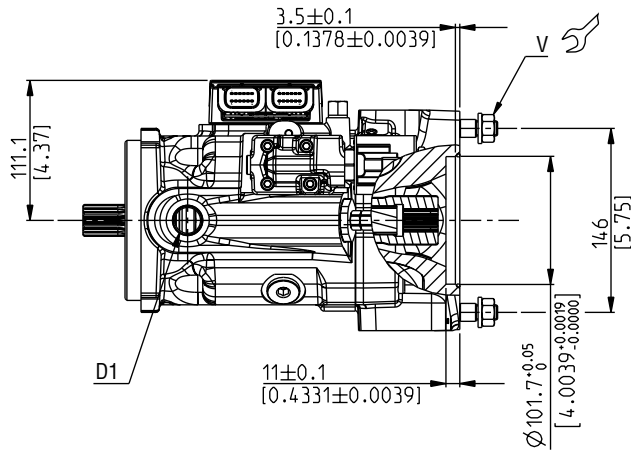
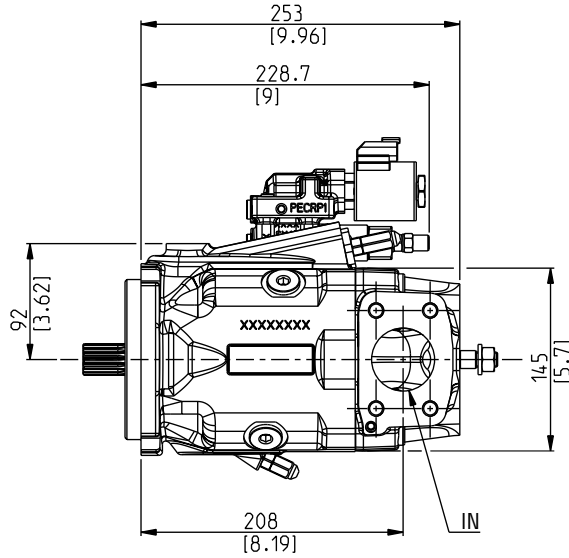
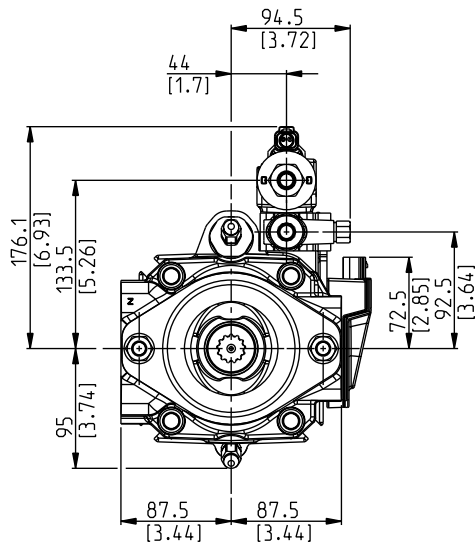

DCAT\_066\_015

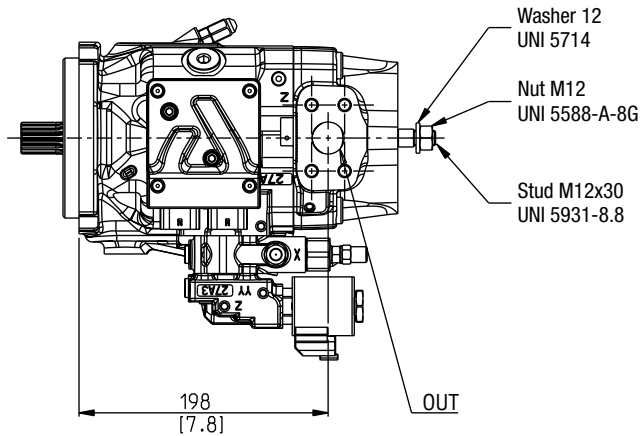
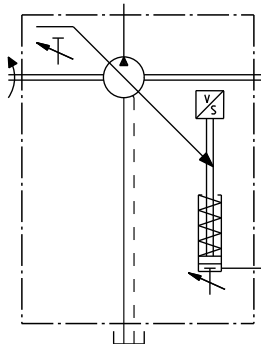

Screws tightening torque Nm (lbf in)

V
100 ±10 (797 ÷ 974)

01/08.2022

**MVPE60**

**COUPLINGS - DIMENSIONS**

**SAE "B" SPLINE**

**04**

Available with flange code **AS5**

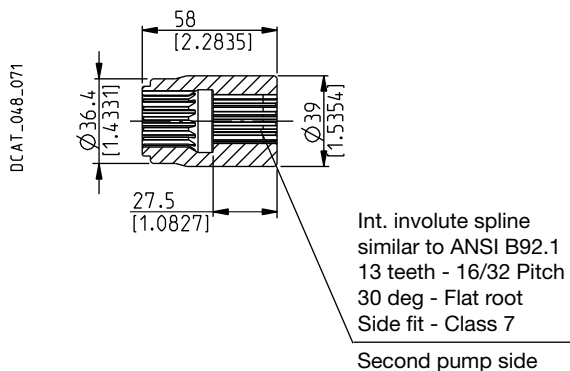

**MAX 200 Nm (1770 lbf in)**

**SAE "BB" SPLINE**

**05**

Available with flange code **AS5**

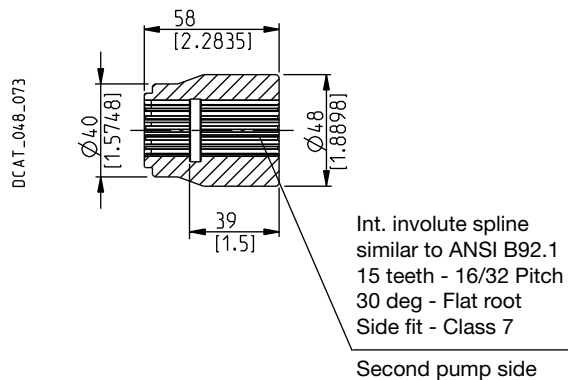

**MAX 250 Nm (2213 lbf in)**

**SAE "C" SPLINE**

**06**

Available with flange code **AS5**

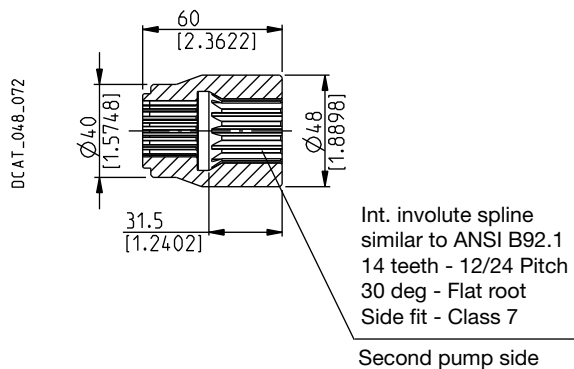

**MAX 430 Nm (3806 lbf in)**

01/08.2022

## FRONT SECTION KIT COVER

Kit cover is available to obtain single pumps starting from the front sections of multiple pumps.  
Before closing the intermediate flange check that the coupling has been removed.

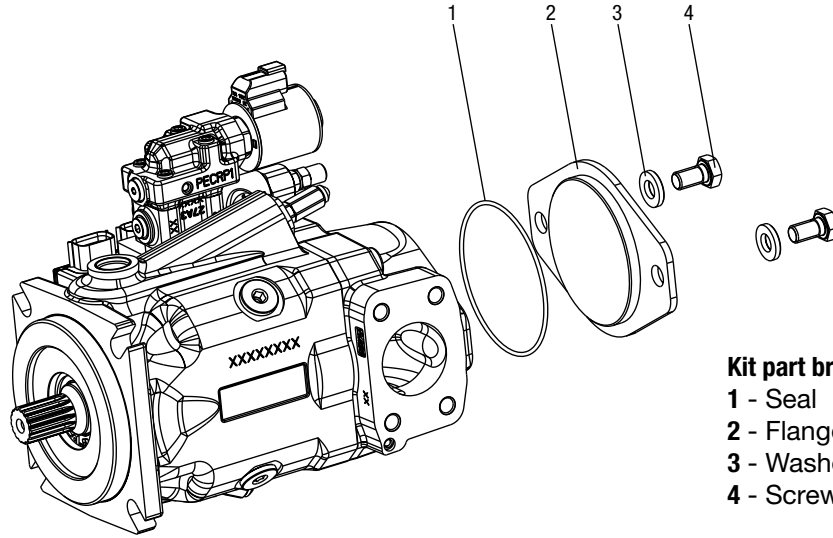

**Kit part brake down**

- 1 - Seal
- 2 - Flange
- 3 - Washers
- 4 - Screws

DCAT\_066\_016

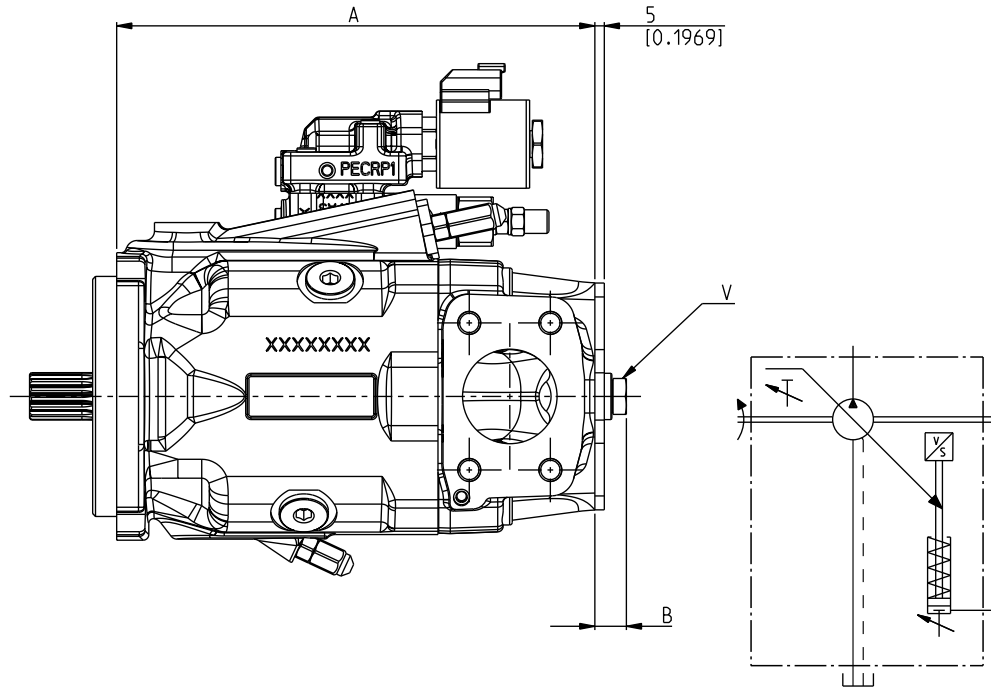

Replaces: 01/08.2022

02/02.2023

Pump type	Flanged for	Code	Front section		Code	Screws tightening torque Nm (lbf in)
			A mm (in)	B mm (in)		
<b>MVPE48</b>	SAE B	AS5	233 (9.1732)	16 (0.6299)	<b>62100007</b>	20 <sup>+1</sup> (159 ÷ 195)
<b>MVPE60</b>	SAE B	AS5	253 (9.9606)	16 (0.6299)		

---

## NOTES

---

01/08.2022

## HOW TO ORDER SINGLE PUMPS

1	2	3	4	5	6	7	8 ...
<b>MVPE60-60</b>	<b>S</b>	-	<b>06</b>	<b>S8</b>	-	<b>L</b>	<b>MF/MC</b> - <b>N</b> - ...

1	Pump type (max. displacement) 	Code
45 cm <sup>3</sup> /rev (2.75 in <sup>3</sup> /rev)		<b>MVPE48-45</b>
53,7 cm <sup>3</sup> /rev (3.28 in <sup>3</sup> /rev)		<b>MVPE48-53</b>
60 cm <sup>3</sup> /rev (3.66 in <sup>3</sup> /rev)		<b>MVPE60-60</b>
72 cm <sup>3</sup> /rev (4.39 in <sup>3</sup> /rev)		<b>MVPE60-72</b>
84,7 cm <sup>3</sup> /rev (5.17 in <sup>3</sup> /rev)		<b>MVPE60-84</b>

2	Rotation	Code
Anti-clockwise		<b>S</b>
Clockwise		<b>D</b>

3	Drive shaft (a) 	Code
SAE "B" spline (13 teeth)		<b>04</b>
SAE "B" spline (13 teeth)		<b>4R</b>
SAE "B" straight		<b>32</b>
SAE "BB" spline (15 teeth)		<b>05</b>
SAE "BB" spline (15 teeth)		<b>5R</b>
SAE "C" spline (14 teeth)		<b>06</b>
SAE "C" spline (14 teeth)		<b>6R</b>
SAE "C" straight		<b>34</b>

4	Mounting flange (a) 	Code
SAE "B" 2 holes		<b>S5</b>
SAE "C" 2 holes		<b>S7</b>
SAE "C" 4 holes		<b>S8</b>

5	Ports position	Code
Side		<b>L</b>
Rear		<b>P</b>

Code		Inlet/outlet ports	6
Nominal size			
		Inlet IN      Outlet OUT	Pump type
		SAE 3000      SAE 3000	

### SAE FLANGED PORTS METRIC THREAD (SSM)

<b>ME/MC</b>	1" 1/2	1"	MVPE48
<b>MF/MC</b>	2"	1"	MVPE60

### SAE FLANGED PORTS UNC THREAD (SSS)

<b>SE/SC</b>	1" 1/2	1"	MVPE48
<b>SF/SC</b>	2"	1"	MVPE60

### SAE STRAIGHT THREAD PORTS (ODT)

<b>OH/OF (b)</b>	1" 1/2	1"	MVPE48
<b>MF/OF</b>	2"	1"	MVPE60

Code	Seals	7
<b>N</b>	Buna (standard)	
<b>V</b>	Viton	

Code	Regulators	8
...	See how to order at page 49	

- (a) Drive shafts availability at pages 30 ÷ 31 and mounting flanges availability at pages 32 ÷ 33
- (b) Only for rear ports

Replaces: 01/08.2022

 02/02.2023

## HOW TO ORDER REGULATORS

### PRESSURE ELECTRONIC COMPENSATOR

Pressure electronic compensator plus angular sensor with flow control	8      9      10      11      12      13      14      15      16      17																			
	<table style="width: 100%; border-collapse: collapse;"> <tr> <td style="border: 1px solid black; padding: 2px; text-align: center;">PECA</td> <td style="padding: 0 5px;">-</td> <td style="border: 1px solid black; padding: 2px; text-align: center;">1</td> <td style="padding: 0 5px;">-</td> <td style="border: 1px solid black; padding: 2px; text-align: center;">A</td> <td style="padding: 0 5px;">-</td> <td style="border: 1px solid black; padding: 2px; text-align: center;">LS2</td> <td style="padding: 0 5px;">-</td> <td style="border: 1px solid black; padding: 2px; text-align: center;">Z</td> <td style="padding: 0 5px;">/</td> <td style="border: 1px solid black; padding: 2px; text-align: center;">...</td> <td style="padding: 0 5px;">-</td> <td style="border: 1px solid black; padding: 2px; text-align: center;">...</td> <td style="padding: 0 5px;">-</td> <td style="border: 1px solid black; padding: 2px; text-align: center;">D</td> <td style="padding: 0 5px;">-</td> <td style="border: 1px solid black; padding: 2px; text-align: center;">G</td> <td style="padding: 0 5px;">-</td> <td style="border: 1px solid black; padding: 2px; text-align: center;">DP</td> </tr> </table>	PECA	-	1	-	A	-	LS2	-	Z	/	...	-	...	-	D	-	G	-	DP
PECA	-	1	-	A	-	LS2	-	Z	/	...	-	...	-	D	-	G	-	DP		

<table style="width: 100%; border-collapse: collapse;"> <tr> <td style="width: 10%; text-align: center;"><b>8</b></td> <td style="width: 70%;"><b>Regulators type</b></td> <td style="width: 20%; text-align: right;">Code</td> </tr> <tr> <td colspan="2">Pressure electronic compensator and swashplate angular sensor</td> <td style="text-align: right;"><b>PECA</b></td> </tr> </table>	<b>8</b>	<b>Regulators type</b>	Code	Pressure electronic compensator and swashplate angular sensor		<b>PECA</b>	<table style="width: 100%; border-collapse: collapse;"> <tr> <td style="width: 20%; text-align: right;">Code</td> <td style="width: 60%;"><b>Min. pressure setting</b></td> <td style="width: 20%; text-align: right;">13</td> </tr> <tr> <td style="text-align: right;">...</td> <td>Please specify the requested value in bar</td> <td></td> </tr> </table>	Code	<b>Min. pressure setting</b>	13	...	Please specify the requested value in bar							
<b>8</b>	<b>Regulators type</b>	Code																	
Pressure electronic compensator and swashplate angular sensor		<b>PECA</b>																	
Code	<b>Min. pressure setting</b>	13																	
...	Please specify the requested value in bar																		
<table style="width: 100%; border-collapse: collapse;"> <tr> <td style="width: 10%; text-align: center;"><b>9</b></td> <td style="width: 70%;"><b>Valve type</b></td> <td style="width: 20%; text-align: right;">Code</td> </tr> <tr> <td colspan="2">Normally closed 12 V DC</td> <td style="text-align: right;"><b>1</b></td> </tr> <tr> <td colspan="2">Normally closed 24 V DC</td> <td style="text-align: right;"><b>2</b></td> </tr> </table>	<b>9</b>	<b>Valve type</b>	Code	Normally closed 12 V DC		<b>1</b>	Normally closed 24 V DC		<b>2</b>	<table style="width: 100%; border-collapse: collapse;"> <tr> <td style="width: 20%; text-align: right;">Code</td> <td style="width: 60%;"><b>Max. pressure setting</b></td> <td style="width: 20%; text-align: right;">14</td> </tr> <tr> <td style="text-align: right;">...</td> <td>Please specify the requested value in bar</td> <td></td> </tr> </table>	Code	<b>Max. pressure setting</b>	14	...	Please specify the requested value in bar				
<b>9</b>	<b>Valve type</b>	Code																	
Normally closed 12 V DC		<b>1</b>																	
Normally closed 24 V DC		<b>2</b>																	
Code	<b>Max. pressure setting</b>	14																	
...	Please specify the requested value in bar																		
<table style="width: 100%; border-collapse: collapse;"> <tr> <td style="width: 10%; text-align: center;"><b>10</b></td> <td style="width: 70%;"><b>Position</b></td> <td style="width: 20%; text-align: right;">Code</td> </tr> <tr> <td colspan="2">Position 0°</td> <td style="text-align: right;"><b>A</b></td> </tr> <tr> <td colspan="2">Position 90°</td> <td style="text-align: right;"><b>B</b></td> </tr> </table>	<b>10</b>	<b>Position</b>	Code	Position 0°		<b>A</b>	Position 90°		<b>B</b>	<table style="width: 100%; border-collapse: collapse;"> <tr> <td style="width: 20%; text-align: right;">Code</td> <td style="width: 60%;"><b>Connector type</b></td> <td style="width: 20%; text-align: right;">15</td> </tr> <tr> <td style="text-align: right;"><b>S</b></td> <td>DIN 43650</td> <td></td> </tr> <tr> <td style="text-align: right;"><b>D</b></td> <td>Deutsch DT04-2P</td> <td></td> </tr> </table>	Code	<b>Connector type</b>	15	<b>S</b>	DIN 43650		<b>D</b>	Deutsch DT04-2P	
<b>10</b>	<b>Position</b>	Code																	
Position 0°		<b>A</b>																	
Position 90°		<b>B</b>																	
Code	<b>Connector type</b>	15																	
<b>S</b>	DIN 43650																		
<b>D</b>	Deutsch DT04-2P																		
<table style="width: 100%; border-collapse: collapse;"> <tr> <td style="width: 10%; text-align: center;"><b>11</b></td> <td style="width: 70%;"><b>Flow control option</b></td> <td style="width: 20%; text-align: right;">Code</td> </tr> <tr> <td colspan="2">Flow compensator for remote control</td> <td style="text-align: right;"><b>LS2</b></td> </tr> </table>	<b>11</b>	<b>Flow control option</b>	Code	Flow compensator for remote control		<b>LS2</b>	<table style="width: 100%; border-collapse: collapse;"> <tr> <td style="width: 20%; text-align: right;">Code</td> <td style="width: 60%;"><b>Displacement limiter</b></td> <td style="width: 20%; text-align: right;">16</td> </tr> <tr> <td style="text-align: right;"><b>E</b></td> <td>Max. displacement limiter</td> <td></td> </tr> <tr> <td style="text-align: right;"><b>G</b></td> <td>Min. and Max. displacement limiter</td> <td></td> </tr> </table>	Code	<b>Displacement limiter</b>	16	<b>E</b>	Max. displacement limiter		<b>G</b>	Min. and Max. displacement limiter				
<b>11</b>	<b>Flow control option</b>	Code																	
Flow compensator for remote control		<b>LS2</b>																	
Code	<b>Displacement limiter</b>	16																	
<b>E</b>	Max. displacement limiter																		
<b>G</b>	Min. and Max. displacement limiter																		
<table style="width: 100%; border-collapse: collapse;"> <tr> <td style="width: 10%; text-align: center;"><b>12</b></td> <td style="width: 70%;"><b>Restrictor option</b></td> <td style="width: 20%; text-align: right;">Code</td> </tr> <tr> <td colspan="2">Without restrictor (standard - no code)</td> <td></td> </tr> <tr> <td colspan="2">Damping restrictor (only for critical applications)</td> <td style="text-align: right;"><b>Z</b></td> </tr> </table>	<b>12</b>	<b>Restrictor option</b>	Code	Without restrictor (standard - no code)			Damping restrictor (only for critical applications)		<b>Z</b>	<table style="width: 100%; border-collapse: collapse;"> <tr> <td style="width: 20%; text-align: right;">Code</td> <td style="width: 60%;"><b>Double shaft seal option</b></td> <td style="width: 20%; text-align: right;">17</td> </tr> <tr> <td></td> <td>Without double shaft seal (standard - no code)</td> <td></td> </tr> <tr> <td style="text-align: right;"><b>DP</b></td> <td>Double shaft seal (availability at page 20)</td> <td></td> </tr> </table>	Code	<b>Double shaft seal option</b>	17		Without double shaft seal (standard - no code)		<b>DP</b>	Double shaft seal (availability at page 20)	
<b>12</b>	<b>Restrictor option</b>	Code																	
Without restrictor (standard - no code)																			
Damping restrictor (only for critical applications)		<b>Z</b>																	
Code	<b>Double shaft seal option</b>	17																	
	Without double shaft seal (standard - no code)																		
<b>DP</b>	Double shaft seal (availability at page 20)																		

01/08.2022

#### ORDER EXAMPLE

MVPE60 pump with pressure electronic compensator plus angular sensor and flow control:

**MVPE60.60S-06S8-LMF/MC-N-PECA-1-A-LS2-100/300-D-G-DP**

## HOW TO ORDER MULTIPLE PUMPS - PISTON PUMP/GEAR PUMP

### COMMON INLET

1	2	3	4	5	6	7	8 ...	9	10	11	7	12									
MVPE60-60	S	-	06	S8	-	L	MF/MC	-	N	-	...	-	G	-	DP	-	P7	-	A	/	
Front section																					
KP20-6,3	S	-					L	**	GD	-							N5	-	N	-	P
Rear section																					

1	Pump type (max. displacement)	Code
	Front section - The same of single pumps	<b>MVPE ...</b>
	Rear section - KAPPA 20 gear pumps (a)	<b>KP 20 ...</b>
	Rear section - POLARIS PH gear pumps (b)	<b>PHP 20 ...</b>

2	Rotation	Code
	Anti-clockwise	<b>S</b>
	Clockwise	<b>D</b>

3	Drive shaft (c)	Code
	SAE "B" spline (13 teeth)	<b>04</b>
	SAE "B" spline (13 teeth)	<b>4R</b>
	SAE "B" straight	<b>32</b>
	SAE "BB" spline (15 teeth)	<b>05</b>
	SAE "BB" spline (15 teeth)	<b>5R</b>
	SAE "C" spline (14 teeth)	<b>06</b>
	SAE "C" spline (14 teeth)	<b>6R</b>
	SAE "C" straight	<b>34</b>

4	Mounting flange (c)	Code
	SAE "B" 2 holes	<b>S5</b>
	SAE "C" 2 holes	<b>S7</b>
	SAE "C" 4 holes	<b>S8</b>

5	Ports position	Code
	Side	<b>L</b>

6	Inlet/outlet ports (a) - (b)	Code
	Nominal size	
	Pump type	Inlet IN      Outlet OUT
		SAE 3000      SAE 6000
<b>SAE FLANGED PORTS METRIC THREAD (SSM)</b>		
	MVPE48	1" 1/2      1" <b>ME/MC</b>
	MVPE60	2"      1" 1/4 <b>MF/MC</b>
<b>SAE FLANGED PORTS UNC THREAD (SSS)</b>		
	MVPE48	1" 1/2      1" <b>SE/SC</b>
	MVPE60	2"      1" <b>SF/SC</b>
<b>SAE STRAIGHT THREAD PORTS (ODT)</b>		
	MVPE48	—      —
	MVPE60	2"      1" <b>MF/OF</b>

Code	Seals	7
<b>N</b>	Buna (standard)	
<b>V</b>	Viton	

Code	Regulators	8
<b>...</b>	See how to order on page 49	

Code	Displacement limiter	9
<b>E</b>	Max. displacement limiter	
<b>G</b>	Min. and Max. displacement limiter	

Code	Double shaft seal option	10
	Without double shaft seal (standard - no code)	
<b>DP</b>	Double shaft seal (availability at page 20)	

Code	Intermediate flange	11
<b>FRONT SECTION</b>		
<b>P7</b>	Flanged for KP20	
<b>I7</b>	Flanged for PHP20	
<b>REAR SECTION</b>		
<b>N5</b>	Kappa 20 (common inlet)	
<b>S7</b>	Polaris PHP 20 (common inlet)	

Code	Sections	12
<b>A</b>	Front	
<b>P</b>	Rear	

-  Omit code only if ordering assembled multiple pumps
- (a) KAPPA 20 gear pumps: displacements at page 24 and 28 ports at page 34. For more information, please see the respective technical catalogue
  - (b) POLARIS PH gear pumps: displacements at page 25 and 29 ports at page 34. For more information, please see the respective technical catalogue
  - (c) Drive shafts availability at pages 30 ÷ 31 and mounting flanges availability at pages 32 ÷ 33

Replaces: 01/08.2022

02/02.2023

---

## HOW TO ORDER MULTIPLE PUMPS - PISTON PUMP/GEAR PUMP

---

### ORDER EXAMPLE

Common inlet double pump MVPE60 with pressure electronic compensator plus angular sensor and flow control + PHP20 gear pump.

### INDIVIDUAL SECTIONS

Front section

**MVPE60.60S-06S8-LMF/MC-N-PECA-1-A-LS2-100/300-D-G-DP-I7-A**

Rear section

**PHP 20.23S-L \*\*/GD-S7-N-P**

### ASSEMBLED DOUBLE PUMP

**MVPE60.60S-06S8-LMF/MC-N-PECA-1-A-LS2-100/300-D-G-DP/PHP 20.23-L\*\*/GD**

01/08.2022

## HOW TO ORDER MULTIPLE PUMPS - PISTON PUMP/PISTON PUMP

### Through drive

1	2	3	4	5	6	7	8 ...	9	10	11	12									
MVPE60-60	S	-	06	S8	-	L	MF/MC	-	N	-	...	-	G	-	AS5	-	04	-	DP	/
Front section (through drive)																				

MVPE60-60	S	-	04	S5	-	L	MF/MC	-	N	-	...	-	G
Rear section (single pump)													

<b>1</b>	<b>Pump type (max. displacement)</b>	<input checked="" type="radio"/>	Code
	Front section MVPE (the same of single pumps) (a)		<b>MVPE ...</b>
	Rear section MVPE (the same of single pumps) (a)		<b>MVPE ...</b>

<b>2</b>	<b>Rotation</b>	Code
	Anti-clockwise	<b>S</b>
	Clockwise	<b>D</b>

<b>3</b>	<b>Drive shaft (b)</b>	<input checked="" type="radio"/>	Code
	SAE "B" spline (13 teeth)		<b>04</b>
	SAE "B" spline (13 teeth)		<b>4R</b>
	SAE "B" straight		<b>32</b>
	SAE "BB" spline (15 teeth)		<b>05</b>
	SAE "BB" spline (15 teeth)		<b>5R</b>
	SAE "C" spline (14 teeth)		<b>06</b>
	SAE "C" spline (14 teeth)		<b>6R</b>
	SAE "C" straight		<b>34</b>

<b>4</b>	<b>Mounting flange (b)</b>	<input checked="" type="radio"/>	Code
	SAE "B" 2 holes		<b>S5</b>
	SAE "C" 2 holes		<b>S7</b>
	SAE "C" 4 holes		<b>S8</b>

<b>5</b>	<b>Ports position</b>	Code
	Side	<b>L</b>

<b>6</b>	<b>Inlet/outlet ports</b>	<input checked="" type="radio"/>	Code
	Nominal size		
	Pump type	Inlet IN	Outlet OUT
		SAE 3000	SAE 6000
<b>SAE FLANGED PORTS METRIC THREAD (SSM)</b>			
	MVPE48	1" 1/2	1" <b>ME/MC</b>
	MVPE60	2"	1" 1/4 <b>MF/MC</b>
<b>SAE FLANGED PORTS UNC THREAD (SSS)</b>			
	MVPE48	1" 1/2	1" <b>SE/SC</b>
	MVPE60	2"	1" <b>SF/SC</b>
<b>SAE STRAIGHT THREAD PORTS (ODT)</b>			
	MVPE48	—	—
	MVPE60	2"	1" <b>MF/OF</b>

Code	<b>Seals</b>	7
<b>N</b>	Buna (standard)	
<b>V</b>	Viton	

Code	<b>Regulators</b>	8
<b>...</b>	See how to order on page 41	

Code	<b>Displacement limiter</b>	9
<b>E</b>	Max. displacement limiter	
<b>G</b>	Min. and Max. displacement limiter	

Code	<b>Intermediate flange (c)</b>	10
<b>AS5</b>	SAE "B" 2 holes	

Code	<input checked="" type="radio"/> <b>Coupling (d)</b>	11
<b>04</b>	SAE "B" spline (13 teeth)	
<b>32</b>	SAE "B" straight	
<b>05</b>	SAE "BB" spline (15 teeth)	
<b>33</b>	SAE "BB" straight	
<b>06</b>	SAE "C" spline (14 teeth)	

Code	<b>Double shaft seal option</b>	12
	Without double shaft seal (standard - no code)	
<b>DP</b>	Double shaft seal (availability at page 20)	

Omit code only if ordering assembled multiple pumps

- (a) Displacements at page 48
- (b) Drive shafts availability at pages 30 ÷ 31 and mounting flanges availability at pages 32 ÷ 33
- (c) Intermediate flange availability at page 40
- (d) Couplings availability:  
MVPE48 on page 43  
MVPE60 on page 45

Replaces: 01/08.2022

02/02.2023

---

## HOW TO ORDER MULTIPLE PUMPS - PISTON PUMP/PISTON PUMP

---

### ORDER EXAMPLE

Through drive double pump MVPE60 with pressure electronic compensator plus angular sensor and flow control.

### INDIVIDUAL SECTIONS

Front section

**MVPE60.60S-06S8-LMF/MC-N-PECA-1-A-LS2-100/300-D-G-AS5/04-DP**

Rear section

**MVPE60.60S-04S5-LMF/MC-N-PECA-1-A-LS2-100/300-D-G**

### ASSEMBLED DOUBLE PUMP

**MVPE60.60S-06S8-LMF/MC-N-PECA-1-A-LS2-100/300-D-G-DP/ MVPE60.60S-04S5-LMF/MC-N-PECA-1-A-LS2-100/300-D-G**

01/08.2022

---

## NOTES

---

01/08.2022

Our policy is one of continuous improvement in product. Specification of items may, therefore, be changed without notice.

CSP 02 T A

Edition: 02/02.2023

Replaces: 01/08.2022



Headquarters:

**CASAPPA S.p.A.**

Via Balestrieri, 1

43044 Lemignano di Collecchio

Parma (Italy)

Tel. (+39) 0521 30 41 11

Fax (+39) 0521 80 46 00

E-mail: [info@casappa.com](mailto:info@casappa.com)

[www.casappa.com](http://www.casappa.com)

