

Hydraulics Network



1800-OILSOL
1800-645765

<https://oilsolutions.com.au/>

sales@oilsolutions.com.au



PISTON PUMPS

2023

V-Axial Piston Pumps

Part #	List Price \$	Displacement at 100psi (7 bar)			Pressure Adj. Range Bar	Speed RPM		Thread		Weight KG
		cm ³ /rev	1500rpm lpm	1800rpm lpm		Max	Min	Inlet	Outlet	
V15		15.0	22.5	27.0	1: 8~70 2: 15~140 3: 20~210 4: 20~250	1800	500	3/4" BSPP	3/4" BSPP	13
V23		23.0	35.4	41.4		1800	500	1" BSPP	3/4" BSPP	22
V38		37.8	56.7	68.0		1800	500	1.1/4" BSPP	1" BSPP	26
V50		51.5	77.2	92.7		1800	500	1.1/2" BSPP	1.1/4" BSPP	56
V70		69.7	104.5	125.4	1: 8~70 2: 15~140 3: 20~210	1800	500	1.1/2" BSPP	1.1/4" BSPP	56

Pump 2

Pump 1

Standard

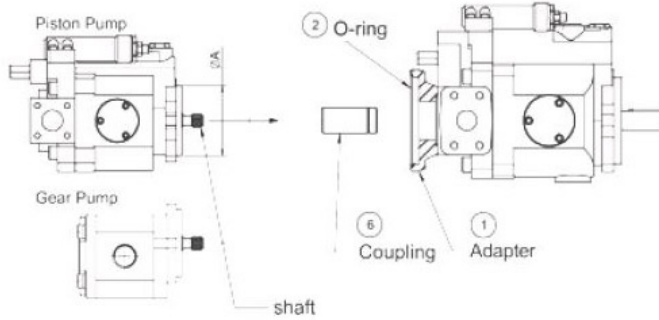

V15

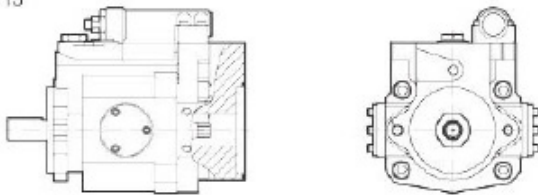

V23-V70

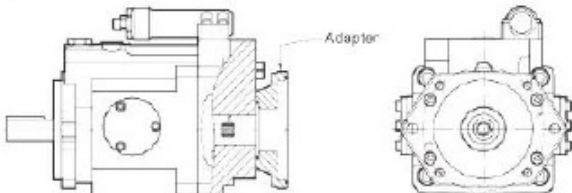

Thru Drive Coupler

ORDER CODES FOR PISTON PUMPS

1	2	3	4	5	6	-	7	8	9	10
V	15	A	3	R					40	

1	SERIES
	Axial piston pump Variable displacement High pressure version
	Nominal pressure: 175 bar Maximum pressure: 280 bar Single operation period: 250 bar (6ms), 315 bar (2.5ms)
	V

2	SIZE & DISPLACEMENT
	15 23 38 50 70
Size	1 2 3 4 4
Displacement cm ³ /rev	15 23 37.8 51.5 69.7

3	CONTROL DEVICE	List Price \$ (V15/23/38)	List Price \$ (V50/70)	
	Standard pressure control	-	-	A
	Remote pressure control			G
	Load-sensing control high pressure			HLC

CONTROLS	SYMBOL	CHARACTERISTIC	SPECIFICATIONS
A			<ol style="list-style-type: none"> When system pressure increases and reaches required pressure, the flow decreases automatically and the pressure is constant. Pressure and flow can be manually adjusted.
G			<ol style="list-style-type: none"> The same function of control type A. Pressure can be adjusted remotely by the remote control valve.
HLC			<ol style="list-style-type: none"> HL valve with two different pressures, control displacement. The flow can be changed by HL valve, the sensing feedback can reach low oil temperature and energy saving.

4 PRESSURE ADJUSTING	
8 - 70 bar	1
15 - 140 bar	2
20 - 210 bar	3
20 - 250 bar	4

5 ROTATION	
Clockwise ↻	R
Counter Clockwise ↻	L

6 DIRECTION OF PIPE CONNECTIONS			
Standard: side port (flange)			(blank)
Rear port (V15)		Rear Port (V23)	Rear Port (V38)
			B

7 SHAFT TYPE	Keyed (standard)	Spline (optional)
V15	Keyed 3/4" (blank)	13T 16/32 DP S
V23, V38	Keyed 7/8" (blank)	13T 16/32 DP S
V50, V70	Keyed 1.1/4" (blank)	14T 12/24 DP S

8 VOLTAGE - OPTION UNAVAILABLE

9 THREAD TYPE	
BSPP (G)	40

3 THRU DRIVE & SECOND PUMP	Part	List Price \$	
∅ 82.55mm, SAE A	V15, V23, V38		D
∅ 82.55mm, SAE A	V50, V70		D

Thru Drive Couplers

Part #	List Price \$	Piston Pump Displacement	Thru Drive Mount	Spline
COUPV15-15		V15-17	SAE A	9 Tooth
COUPV23-1		V23-25	SAE A	9 Tooth
COUPV38-1		V38-42	SAE A	9 Tooth
COUPV70-1		V50-70	SAE A	9 Tooth

V-Axial Piston Pump Seal Kits

Part #	List Price \$	Piston Pump
5E00033		V15-17
5E00035		V23-25
5E00037		V38-42
5E00042		V50-70

Hydraulics Network

MELBOURNE

VICTORIA

- 📍 23 Quinlan Road, Epping, VIC 3076
- ✉️ sales@hydraulicsnetwork.com.au
- ☎️ 03 9399 8957

BRISBANE

QUEENSLAND

- 📍 29 Annie Street, Coopers Plains, QLD 4108
- ✉️ salesqld@hydraulicsnetwork.com.au
- ☎️ 07 3277 5969

www.hydraulicsnetwork.com.au

AUSTRALIAN-OWNED
INDEPENDENT HYDRAULICS WHOLESALER