

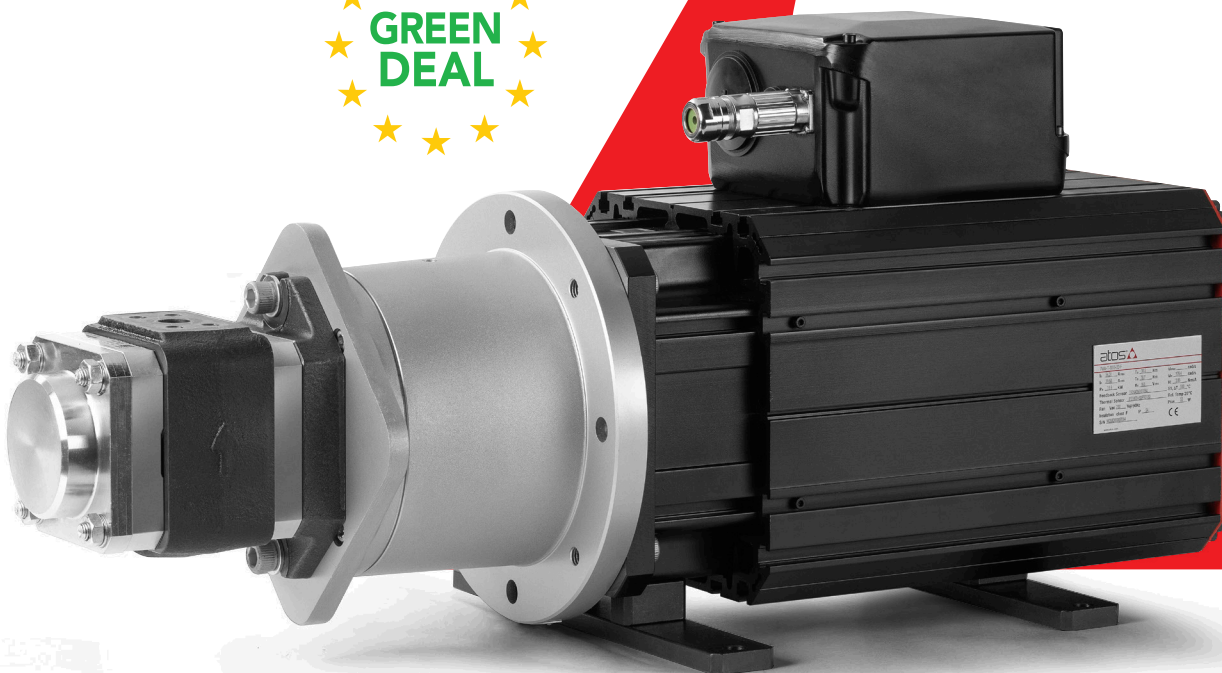

# SSP SERVOPUMPS

High performance and energy saving  
Smart Servopumps with P/Q control





atos   
GROUP

# ABOUT US

---

Established in 1957 from the concept of Luciano Crespi, in 60 years of experience we have written the history of electrohydraulics.

Now we are a Group operating in more than 80 countries, with 9 production sites in Italy, China, USA and India with over 750 professionals who share the same passion for innovation, technology and creativity.

We are specialists, 100% dedicated to electrohydraulics, in a constant search of innovative solutions for any application, from the industrial ones with our high-performance axis controls, to the explosion-proof line for hazardous locations and the stainless steel one for corrosive environments and fluids.



# THE SMART ELECTROHYDRAULICS

Smart Electrohydraulics is the vision that sums up the four values leading our actions: **responsibility**, **excellence**, **innovation** and **passion**.

For Atos, being Smart means courage and determination to define new standards of excellence. A new approach in which each process is analysed and optimized: from design to production, from delivery to after-sales service.

Smart Electrohydraulics is our response to market demands for advanced solutions that are easy to install and use.



**SMART**

## SMART COMPANY

- Technology and innovation drive the research into new sustainable and efficient solutions

## SMART PRODUCTS

- Atos products are unique in terms ease of use, intelligence and automation, always keeping the highest standards of reliability and safety

## SMART PEOPLE

- Our people act as a team, motivated to grow and encouraged to propose innovative ideas and improvements in all business fields

## SMART PARTNER

- Our relationships are transparent, reactive and proactive, in the spirit of collaboration which only a passionate approach can generate

# SSP SERVOPUMPS

The SSP servopumps are designed and engineered to efficiently and accurately deliver the necessary hydraulic power to manage the different phases of the machine cycle, through the modulation of the pump rotation speed.

The **drive** controls the rotation speed of the **motor-pump unit**, to regulate the flow rate and pressure of the system, based on the reference signals received from the machine central unit.

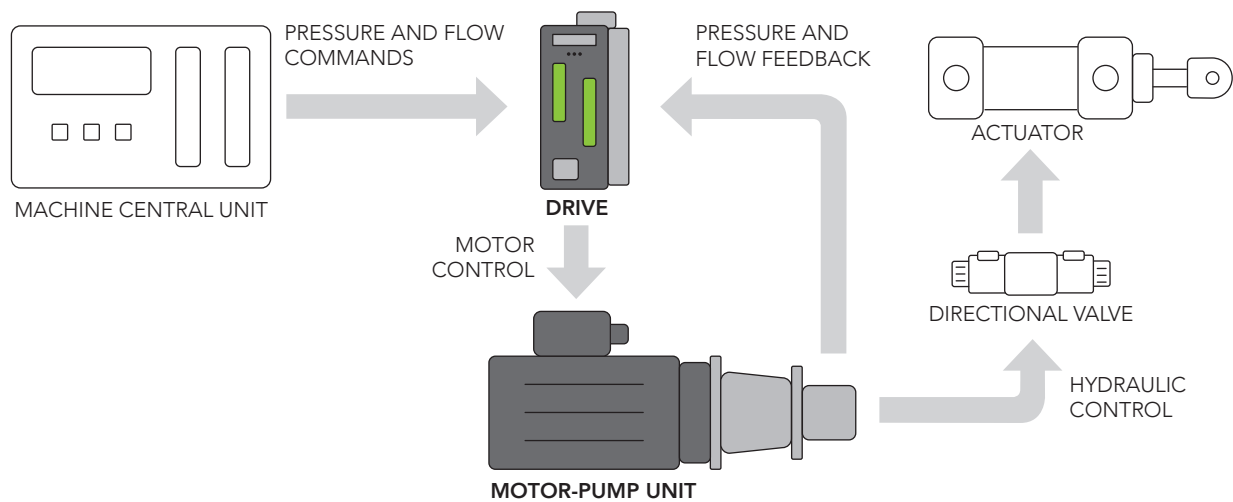

An angular position transducer, integrated in the motor-pump unit, provides the drive with the information on the flow rate generated by the pump. A pressure transducer installed on the pump outlet provides the information on the actual pressure of the hydraulic user line.

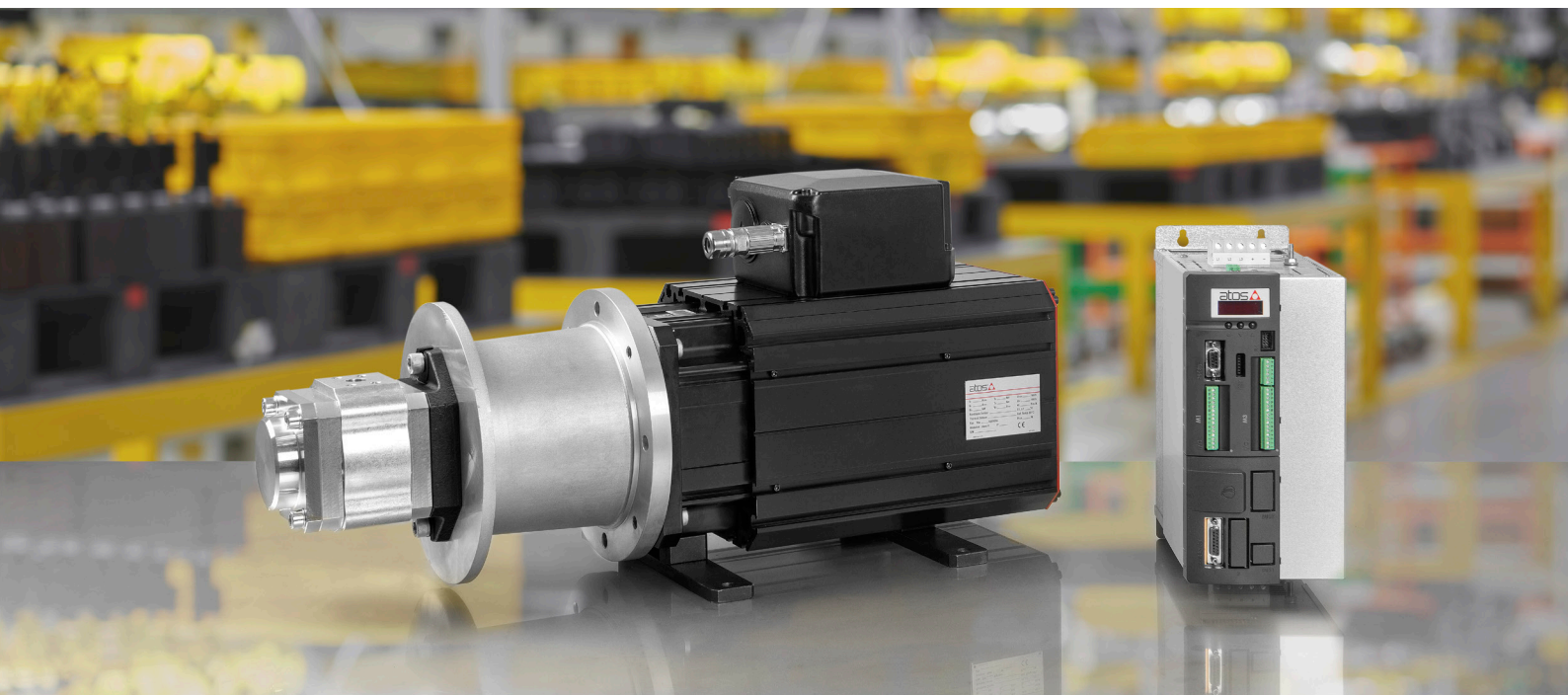

# BENEFITS

## ENERGY SAVING

SSP servopumps deliver hydraulic power only when required and in the quantity necessary to satisfy the work phase in progress.

Compared to systems that rely on a fixed displacement pump, SSP servopumps reduce the energy consumption by 60 ÷ 80%, depending on the machine cycle.

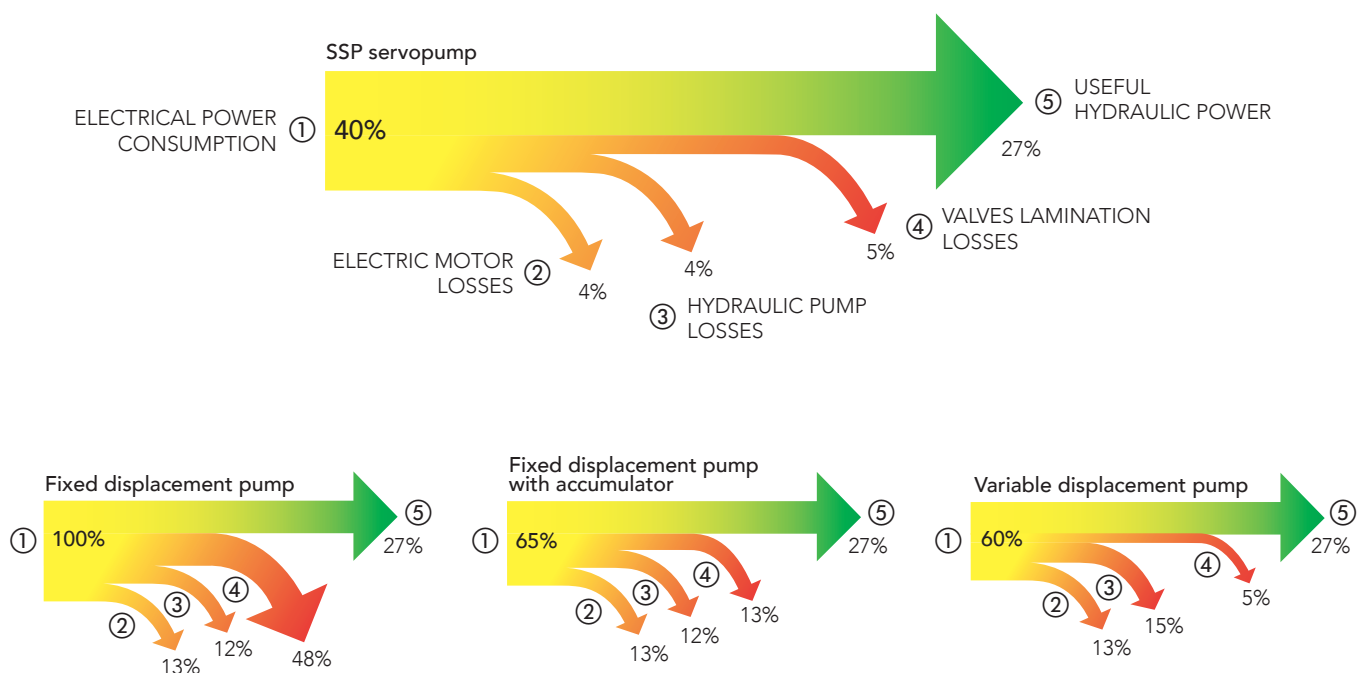

## DIMENSIONS REDUCTION

The capability of reaching rotation speeds up to 3000 rpm permits a reduction of the pump displacement, with the same flow rate delivered.

Furthermore, the lower energy dissipation allows a reduction of the tank dimensions and heat exchanger.

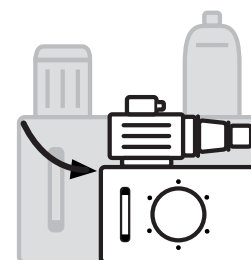

## NOISE REDUCTION

Due to low noise emissions of the internal gear pump and the capability to modulate the speed of the motor-pump unit, it is possible to reduce the noise emission up to 20 db, compared to traditional systems.



# SMART TECHNOLOGY

## SMART START-UP

The Smart Start-up feature simplifies the SSP servopump commissioning with a quick and intuitive 3 steps wizard procedure:

- **General configuration:** allows to select and configure the system communication and set up the protection functions
- **Servomotor test:** verifies the direction of rotation and sends an alarm to the central machine unit, if the direction is not correct
- **Autotuning:** performs the automatic parameterization of the servopump to obtain the best dynamic response, in order to guarantee accuracy and stability during the pressure control phases

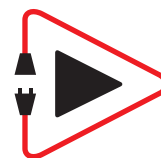

## SMART TUNING

It allows to refine the pressure control response, by choosing between 3 different levels of performance:

- **Dynamic:** fast response times to achieve maximum dynamic performance
- **Balanced:** intermediate response times suitable for most of applications
- **Smooth:** attenuated response times to improve control stability in critical applications

Each configuration can be further customized with dedicated settings.

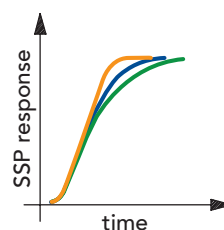

## P/Q CONTROL

Atos exploited its electrohydraulic know-how to develop a P/Q algorithm dedicated to the control of SSP servopumps and specifically designed for hydraulic axes, in order to satisfy the requirements of any application.

Hydraulic machinery manufacturers will be relieved of the development of their own control algorithm.

**P/Q**  
CONTROL

# SMART TECHNOLOGY

---

## MULTIPLE AXIS

---

The SSP servopumps allow to manage up to 4 independent parameter sets. This feature allows the real-time selection of optimal configuration of the axis to be controlled, ensuring the maximum performance for each axis of the machine.

Each set of parameters allows the customization of:

- flow and pressure limits
- flow and pressure ramps
- parameters for pressure control and P/Q logics

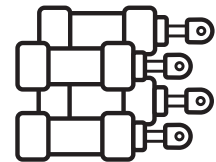

## PROGRAMMING SOFTWARE

---

SSP servopumps can be configured through the programming software S-SW-SETUP. This can be easily used by connecting the PC to the drive. All the main functionalities can be accessed and modified due to an intuitive and user-friendly graphics.

The software allows real-time monitoring of the signals managed by the drive, such as references, feedback and system parameters.

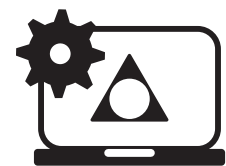

## CONNECTIVITY 4.0

---

The available fieldbuses allow real-time access to functional parameters, diagnostics, transducers and feedback.

CANopen

PROFI<sup>®</sup>  
BUS

EtherCAT<sup>®</sup>

PROFI<sup>®</sup>  
NET

## SIZING SOFTWARE

---

Developed by Atos, this software leads the users in the selection of the SSP servopump that best fits their needs.

By entering the desired machine cycle, an algorithm calculates the optimal servopump size to satisfy the system requirements, along with an energy saving estimation of this solution compared to traditional systems which use fixed or variable displacement pump.

The S-SW-SIZING software is available for download at [www.atos.com](http://www.atos.com)



# PROTECTION FUNCTIONS

## SMART COOLING

During extended phases of static pressure control, the pump tends to overheat due to internal leakage and reduced oil exchange.

The Smart Cooling function prevents the pump overheating due to a dedicated algorithm for temperature management which activates a drain for oil recirculation when necessary.

This function, available as an option, is actuated through a flanged block which offers a complete and ready-to-use solution.

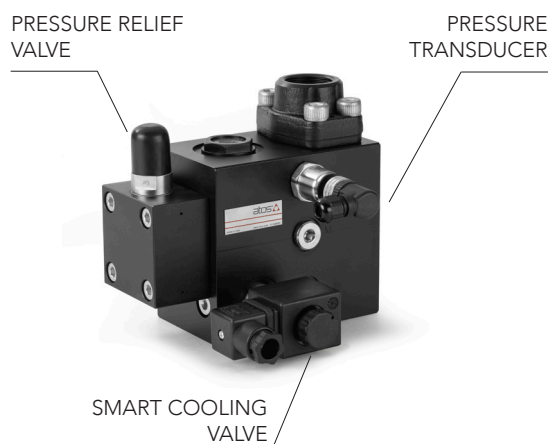
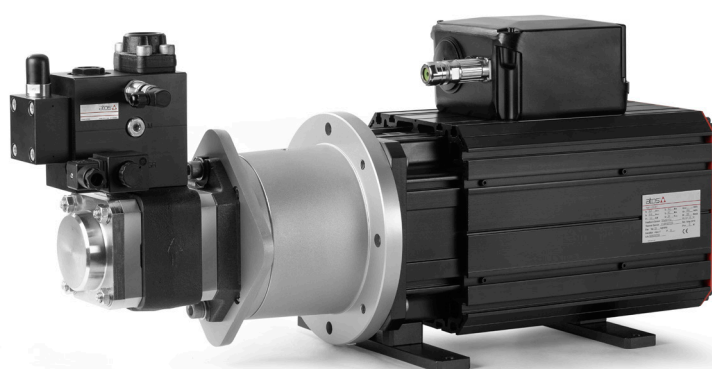

## CAVITATION PROTECTION

According to the geometry of the system suction line, this function allows to optimize the factory settings of servomotor angular acceleration limits, in order to avoid cavitation phenomena. To activate the function, simply enter the parameters of the suction geometry during the Smart Start-up procedure.

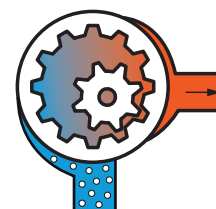

## OVERTEMPERATURE PROTECTION

Both the servomotor and the drive are equipped with an internal temperature transducer to avoid an eventual overheating due to incorrect installations or excessively harsh working conditions.



# COMPONENTS

---

## INTERNAL GEAR PUMP

---

Low noise, reduced pressure pulsation and a wide speed range, make it the optimal choice for the servopump application. Available in two versions:

- **PGI** continuous maximum pressure up to 330 bar
- **PGIL** continuous maximum pressure up to 250 bar

Both versions cover a wide range of displacements, from 11 to 125 cm<sup>3</sup>/rev with maximum flow rates up to 350 l/min.



## PERMANENT MAGNET MOTOR

---

Synchronous **PMM** servomotors are characterized by high dynamics and rotation precision. They differ from asynchronous motors by:

- high electrical efficiency, up to 94% in nominal conditions
- equal power level with reduced dimensions
- very high control dynamics

Sizes available from 9 kW to 100 kW, with 200% overload capacity.



## VECTOR CONTROL DRIVE

---

The **D-MP** drives represent the “brain” which manages the entire SSP servopump system. The exclusive Smart algorithms simplify commissioning and maximize the P/Q control efficiency.

The drive fully meets Industry 4.0 requirements, as it provides the access to all the hydraulic and electrical parameters of the system, enabling the user to simply monitor the machine status and performance.

Sizes available from 22 A to 210 A, with 200% overload capacity.



# SMART SSP SERVOPUMPS

FOR HIGH PERFORMANCE AND ENERGY SAVING P/Q CONTROLS

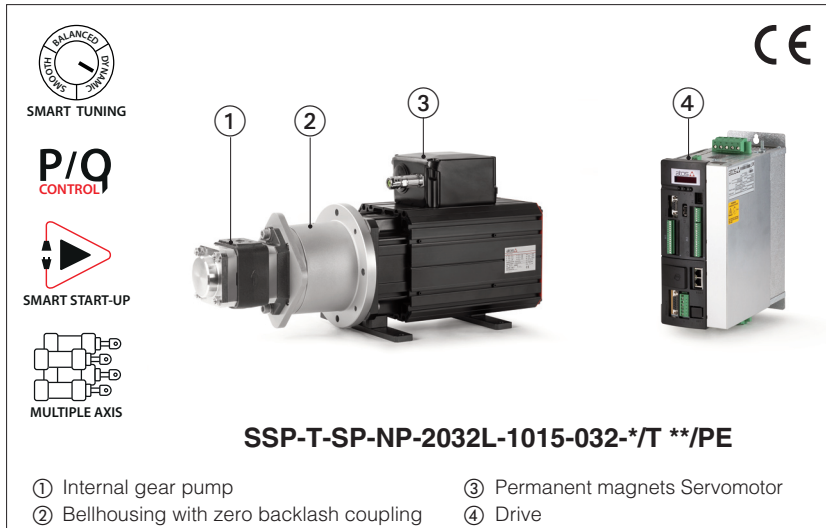

**SSP-T-SP-NP-2032L-1015-032-\*/T \*\*/PE**

- ① Internal gear pump
- ② Bellhousing with zero backlash coupling
- ③ Permanent magnets Servomotor
- ④ Drive

SSP systems combine the typical advantages of hydraulic power transmission with the ease of control and adjustment of an electric drive while also ensuring maximum levels of energy efficiency.

They are used in high performance machines mainly for the plastic, die-casting and deformation sectors.

Maximum flow: **350 l/min**  
 Maximum rated power: **100 kW**  
 Maximum continuous pressure:  
     cast iron pump **330 bar**  
     aluminium pump **250 bar**

They consist of a fixed displacement internal gear pump, driven by a permanent magnet synchronous servomotor controlled by an electronic drive. The latter controls the speed of the servomotor and therefore of the pump, to adjust the flow rate or pressure of the system based on the reference signals received from the PLC of the machine.

A dedicated algorithm optimizes the P/Q function by automatically selecting the activation of the flow or pressure control.

Compared to traditional systems, SSPs offer the following advantages:

- significant reduction in energy consumption, as the pump operates at the speed strictly necessary to generate the required flow rate / pressure
- high dynamics and precision of P/Q control thanks to a dedicated algorithm
- reduction of the noise level, thanks to the design of the pump and the variable speed
- maximum flexibility thanks to dedicated software
- simplified commissioning thanks to the Smart start-up and Smart tuning functions
- possibility of customization up to 4 axes with Multiple axis function

For more details see technical table AS050

## 1 MODEL CODE

<b>SSP</b>	-	<b>T-SP</b>	-	<b>NP</b>	-	<b>2020L</b>	-	<b>1024</b>	-	<b>046</b>	/	<b>C</b>	/	<b>T</b>	/	<b>*</b>	/	<b>PE</b>	
Smart servopump																Series number		Seals material <b>PE</b> = FKM	
<b>Control logic:</b> T-SP = alternated P/Q control with resolver																<b>Port orientation</b> see section [10]: T = standard U, V = optional			
<b>Fieldbus interface</b> , serial port always present: NP = Not present BC = CANopen      EH = EtherCAT BP = PROFIBUS DP    EP = PROFINET RT/IRT																<b>Hydraulic option</b> see section [8]: C = integrated block with relief valve and pressure transducer D = as option C plus Smart Cooling functionality <b>Electronic option</b> see section [9]: K = Drive with Safe Torque Off			
<b>Pump</b> PGI, cast iron pump, Pmax 330 bar (1) - see table AS300: 1011 = 10,9 cm <sup>3</sup> /rev    2050 = 50 cm <sup>3</sup> /rev    3080 = 80 cm <sup>3</sup> /rev 2020 = 20 cm <sup>3</sup> /rev    4050 = 50 cm <sup>3</sup> /rev    4080 = 80 cm <sup>3</sup> /rev 2032 = 32,1 cm <sup>3</sup> /rev    3064 = 64 cm <sup>3</sup> /rev    3100 = 100 cm <sup>3</sup> /rev 2040 = 40,1 cm <sup>3</sup> /rev    4064 = 64 cm <sup>3</sup> /rev    4100 = 100 cm <sup>3</sup> /rev																<b>Drive</b> D-MP - see table AS500: 022 = 22 A      060 = 57 A      140 = 140 A 032 = 32 A      090 = 87 A      165 = 165 A 046 = 46 A      100 = 100 A     210 = 210 A			
PGIL, aluminium pump, Pmax 250 bar - see table AS350: 2020L = 20 cm <sup>3</sup> /rev    2050L = 50 cm <sup>3</sup> /rev    3100L = 100 cm <sup>3</sup> /rev 2032L = 32,1 cm <sup>3</sup> /rev    3064L = 64 cm <sup>3</sup> /rev    4125L = 125 cm <sup>3</sup> /rev 2040L = 40,1 cm <sup>3</sup> /rev    3080L = 80 cm <sup>3</sup> /rev																<b>Motor</b> PMM - see table AS400: 1009 = 8,7 kW      1032 = 30 kW      2080 = 80 kW 1015 = 15 kW      2042 = 42 kW      2100 = 100 kW 1024 = 24 kW      2055 = 55 kW			

(1) Pmax depends on the pump displacement



For optimal sizing, download the sizing software from [www.atos.com](http://www.atos.com)



**8 HYDRAULIC OPTION**

**C** = This option provides a hydraulic block mounted directly on the pump delivery, which integrates a mechanical pressure relief valve with safety function on the maximum system pressure and a pressure transducer for the feedback of the actual pressure on the delivery line.

- ① Mechanical pressure relief valve; the valve is supplied with zero adjustment, and must be adjusted by the user at a pressure slightly higher than the maximum pressure required by the system.
- ② Pressure transducer E-ATR-8/400/I - see technical table GS465

**D** = This option allows to protect the pump from overheating when it is subjected to particularly heavy duty cycles, in particular in the prolonged phases of static pressure control.

This option includes a hydraulic block with relief valve and pressure transducer, as for the /C option, with also integrated:

- ③ Smart Cooling cartridge valve JO-DL-4-2/NC-X 24DC - see technical table E105

When a temperature considered critical is reached, the Smart Cooling valve opens ③ as to cause a small recirculation of oil through the pump which protects it from dangerous overheating.

The sizing software for SSP suggests the need for the /D option based on the machine cycle.

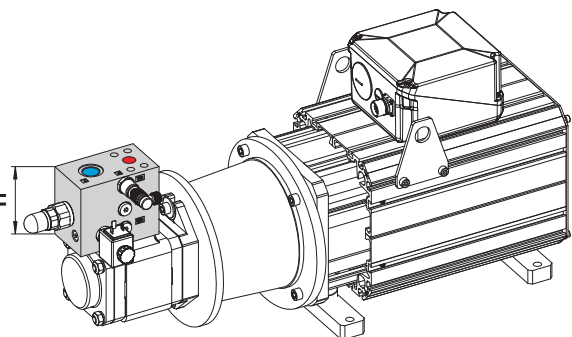
Options <b>C</b> and <b>D</b> dimensions	SSP CODE	OUTLET	Dr (drain)	H (mm)
	<b>SSP-T-SP**-1011*</b>	1/2" SAE3000	G1/2"	105
	<b>SSP-T-SP**-2020*</b>	3/4" SAE3000	G3/4"	110
	<b>SSP-T-SP**-2032*</b>			
	<b>SSP-T-SP**-2040*</b>	1" SAE3000	G1"	115
	<b>SSP-T-SP**-2050*</b>			
	<b>SSP-T-SP**-4050</b>	1" SAE6000	G1"	115
	<b>SSP-T-SP**-3064*</b>	1" SAE6000	G1 1/4"	125
	<b>SSP-T-SP**-4064</b>			
	<b>SSP-T-SP**-3080*</b>	1 1/4" SAE6000	G1 1/2"	140
	<b>SSP-T-SP**-4080*</b>			
	<b>SSP-T-SP**-3100*</b>			
	<b>SSP-T-SP**-4100</b>			
	<b>SSP-T-SP**-4125*</b>	1 1/2" SAE6000	G 2"	140

<p>Detail option <b>C</b></p> 	<p>Hydraulic scheme option <b>C</b></p> 
<p>Detail option <b>D</b></p> 	<p>Hydraulic scheme option <b>D</b></p> 

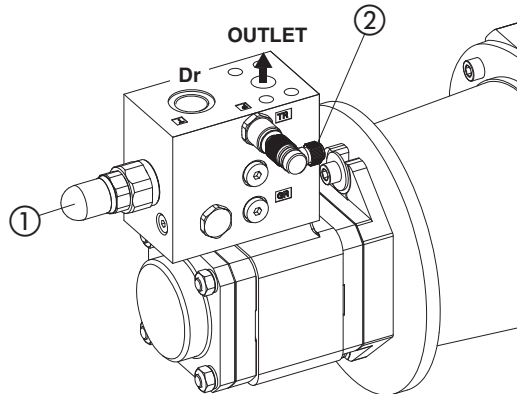
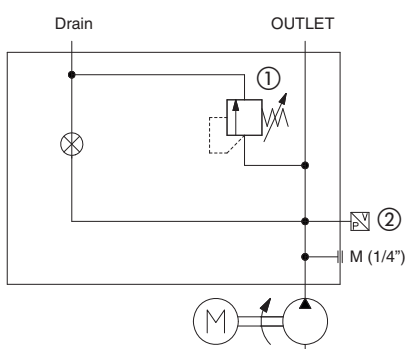
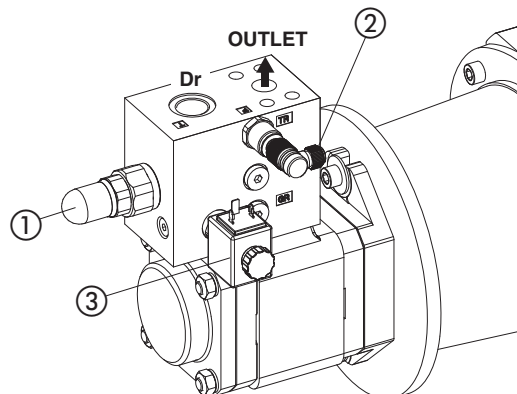
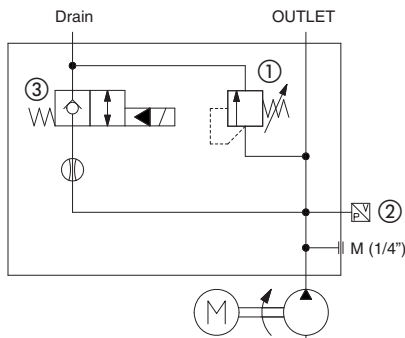
## 9 ELECTRONIC OPTION

**K** = Safe Torque Off (STO) safety function to prevent accidental starting of the servo pump, in accordance with the Machinery Directive 2006/42/EC (MD) - standard EN 61800-5-2

The STO function is implemented in the D-MP Drive and is activated by two digital signals sent by the control unit of the machine that allow to remove the power supply to the servomotor in order to prevent unwanted start-up.

At the same time, two digital signals are generated by the Drive to confirm that the power supply to the motor has been removed and the absence of other anomalies. These signals are read by the machine control unit for safety management.

For more information see the S-MAN-STO manual.

### Possible combined option:

/CK, /DK

## 10 PORTS ORIENTATION

The pump can be supplied with inlet and outlet ports oriented in different configurations, as shown in the figure (seen from the bottom of the pump)

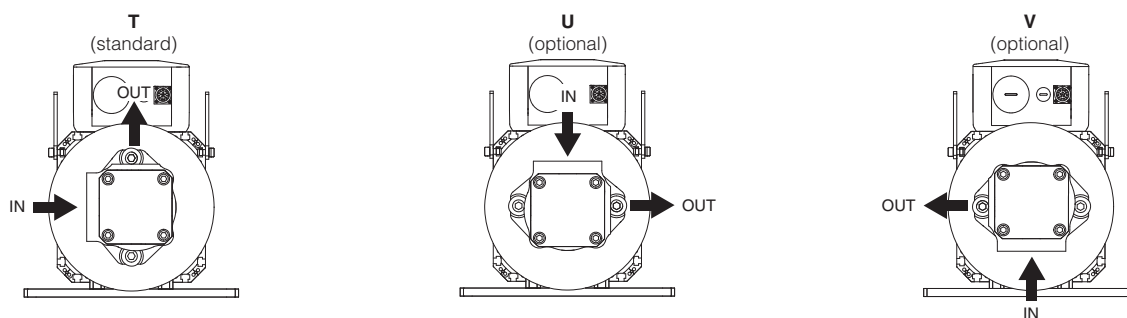

# TECHNICAL TABLES

THE COMPLETE DOCUMENTATION IS AVAILABLE AT [WWW.ATOS.COM](http://WWW.ATOS.COM)

Table

## TECHNICAL INFORMATION

Basics for Smart Servopumps - SSP	AS050
Sizing criteria for servopumps	AS200

## SERVOPUMPS

SSP	High performance and energy saving P/Q servopumps	AS100
-----	---	-------

## PUMPS

		P <sub>max</sub> [bar]	
PGI	Cast iron internal gear pumps, high pressure	330	AS300
PGIL	Aluminium internal gear pumps	250	AS350

## MOTORS

		Power [kW]	
PMM	High performance synchronous servomotors	9 ÷ 100	AS400

## DRIVES

		Current [A]	
D-MP	Electronic drives, fieldbus, smart start-up	22 ÷ 210	AS500

## ACCESSORIES

Software, adapters, cables, reactances, EMC filters and braking resistances	AS810
---	-------

## OPERATING INFORMATION

Operating and maintenance information for servopumps	AS910
--	-------

# THE ATOS RANGE

## PRODUCT LINES

The Atos range is represented by 3 product lines and 7 categories to provide easy access to the wide and ever-evolving product portfolio



### INDUSTRIAL

High performance hydraulics meet advanced digital technology

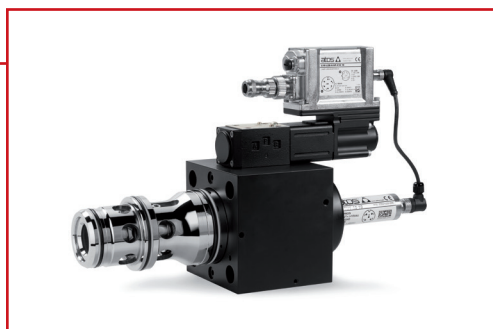

#### SECTORS:

- Manufacturing
- Defense
- Wind
- Construction
- Agriculture
- Transportation



### EX-PROOF

Engineered for safe operation in hazardous environments



#### SECTORS:

- Oil & gas
- Mining
- Energy



### STAINLESS STEEL

The highest resistance to corrosive environments and fluids



#### SECTORS:

- Marine
- Chemical
- Food

# THE ATOS RANGE

---

## PRODUCT CATEGORIES

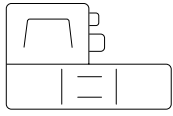

### PROPORTIONAL VALVES

A unique range, from simple valves without transducers to servoproportionals

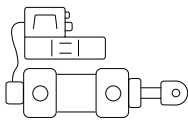

### AXIS & P/Q CONTROLS

Servosystems for position, speed and force control of any hydraulic actuator



### ON-OFF VALVES

A full range of reliable components to satisfy the most demanding applications



### CYLINDERS

ISO executions with rugged design, engineered for high speeds, low friction and extended operative life

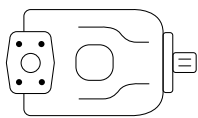

### PUMPS & SERVOPUMPS

Fixed or variable displacement, for high pressure applications with low noise and long service life

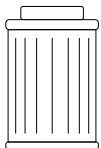

### FILTERS

Equipped with high efficiency microfiber elements for optimal fluid cleanliness

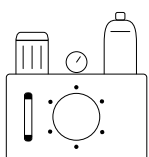

### SYSTEMS

Power units and hydraulic blocks tailored for any hydraulic application, environment and working condition





"WE ARE ATOS,  
WE ARE SMART"



**ATOS.** THE SMART ELECTROHYDRAULICS

## Worldwide Sales Organization

A sales network with 25 branches, 120 sales professionals and distributors in more than 80 countries, together with great responsiveness and focus on customers



### Atos spa

Italy - 21018 Sesto Calende

Phone +39 0331 922078

[info@atos.com](mailto:info@atos.com)

[www.atos.com](http://www.atos.com)