

# Genuine Metaris MT Series Vane Products

Versatile, Durable and Dependable



## High Performance Interchange Vane Pumps & Motors

Genuine Metaris MT Series vane pumps and motors are available in a variety of configurations and displacements. Our vane pumps come in four basic frame sizes: single, double, triple and drive train configurations, with pressures up to 4350 psi and maximum rpms up to 3000 in a single pump.

Our line of M Series vane motors are available with reversible shaft rotation and a variety of torque ratings and port locations. These are rated for pressures up to 2500 psi and maximum rpms up to 4000. The MT Series is engineered for reliable use with a long service life for many applications and is capable of accommodating a wide range of fluid viscosities. These units are replacements for Parker®/Denison® T6, T7 & M4 series vane units.

- Single, Double, Triple & Drive Train options
- High pressure efficiency
- Cartridge Kit design - replacement Cartridge Kits available
- Drop-in assemblies, easy conversion, and ease of maintenance
- Engineered for a wide speed range
- Balanced design allows for extended bearing life
- Low noise level design
- Wide range of acceptable viscosities
- High pressure efficiency with special fluids such as phosphate esters and water glycols
- Great mounting flexibility and installation compatibility
- Form, fit and function replacements for Parker®/Denison® T6, T7 & M4 units



# Reliable, No Matter the Application

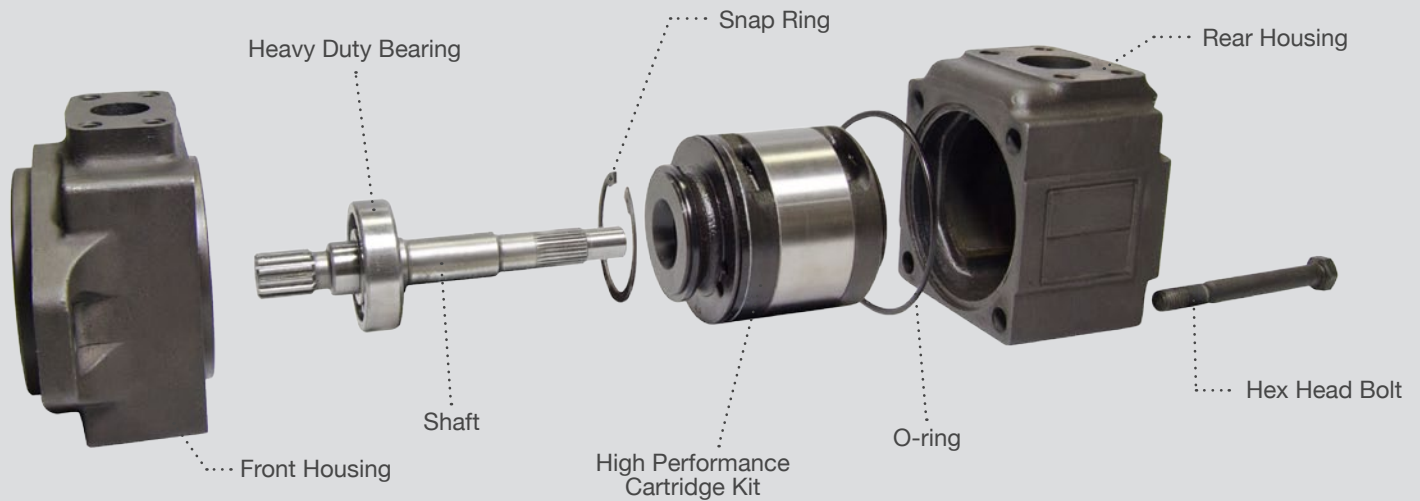

## SINGLE PUMPS

PUMP SERIES	DISPLACEMENT		MAX RPM	MAX PRESSURE (PSI / BAR)
	(IN <sup>3</sup> /R)	(CM <sup>3</sup> /R)		
MT6C	0.66 - 6.10	11 - 100	2800	4000 / 275
MT6CM	0.66 - 6.10	11 - 100	2800	4000 / 275
MT6D	2.90 - 11.62	48 - 190	2500	3500 / 240
MT6DM	2.90 - 11.62	48 - 190	2500	3500 / 240
MT6E	8.07 - 16.40	132 - 270	2200	3500 / 240
MT6EM	8.07 - 16.40	132 - 270	2200	3500 / 240
MT7D	2.68 - 9.64	44 - 158	3000	4350 / 300
MT7E	8.07 - 16.40	132 - 270	2200	3500 / 240



## DRIVE TRAIN PUMPS

PUMP SERIES	DISPLACEMENT		MAX RPM	MAX PRESSURE (PSI / BAR)
	(IN <sup>3</sup> /R)	(CM <sup>3</sup> /R)		
MT6CR	0.66 - 6.10	11 - 100	2800	4000 / 275
MT6CRM	0.66 - 6.10	11 - 100	2800	4000 / 275
MT6DR	2.90 - 11.65	48 - 190	3500	3500 / 240
MT6DRM	2.90 - 11.65	48 - 190	3500	3500 / 240
MT6ER	8.07 - 16.40	132 - 270	2200	3500 / 240
MT6ERM	8.07 - 16.40	132 - 270	2200	3500 / 240



## DOUBLE PUMPS

PUMP SERIES	DISPLACEMENT		MAX RPM	MAX PRESSURE (PSI / BAR)
	(IN <sup>3</sup> /R)	(CM <sup>3</sup> /R)		
MT6CC	1.32 - 12.20	22 - 200	2800	4000 / 275
MT6CCM	1.32 - 12.20	22 - 200	2800	4000 / 275
MT6DC	3.56 - 17.75	59 - 290	2500	4000 / 275
MT6DCM	3.56 - 17.75	59 - 290	2500	4000 / 275
MT6EC	8.73 - 22.56	143 - 370	2200	4000 / 275
MT6ECM	8.73 - 22.56	143 - 370	2200	4000 / 275
MT6ED	11.0 - 28.06	180 - 460	2200	3500 / 240
MT6EDM	11.0 - 28.06	180 - 460	2200	3500 / 240
MT6EE	16.1 - 32.8	264 - 540	2200	3500 / 240
MT67DC	2.68 - 9.64	44 - 156	2200	4000 / 275
MT67EC	8.73 - 22.5	143 - 370	2200	4000 / 275



## TRIPLE PUMPS

PUMP SERIES	DISPLACEMENT		MAX RPM	MAX PRESSURE (PSI / BAR)
	(IN <sup>3</sup> /R)	(CM <sup>3</sup> /R)		
MT6DCC	4.22 - 23.94	70 - 390	2500	4000 / 275
MT6DCCM	4.22 - 23.94	70 - 390	2500	4000 / 275



## VANE MOTORS

PUMP SERIES	DISPLACEMENT		TORQUE		MAX RPM	MAX PRESSURE (PSI / BAR)
	(IN <sup>3</sup> /R)	(CM <sup>3</sup> /R)	(LB-IN/PSI)	(NM/BAR)		
MM4C	1.49 - 4.89	24 - 80	0.24 - 0.78	0.39 - 1.27	4000	2500 / 175
MM4C1	1.49 - 4.89	24 - 80	0.24 - 0.78	0.39 - 1.27	4000	2500 / 175
MM4D	3.97 - 8.81	65 - 144	0.63 - 1.40	1.04 - 2.30	4000	2500 / 175
MM4D1	3.97 - 8.81	65 - 144	0.63 - 1.40	1.04 - 2.30	4000	2500 / 175

# Hydraulex - A Recognized Global Leading Provider of High Quality Hydraulic Components



## Products We Offer

- Inline Piston Pumps
- Radial Piston Pumps & Motors
- Bent Axis Piston Pumps & Motors
- Fixed Volume Vane Pumps
- Variable Volume Vane Pumps
- Gear Pumps
- Vane Motors
- Axial Piston Motors
- High Speed Motors
- Servo Motors
- Orbital Motors
- Directional Valves
- Flow Control Valves
- Pressure Control Valves
- Relief Valves
- Check Valves
- Stack Valves
- Servo Valves
- Proportional Valves
- PTOs (Power Take-offs)
- Cylinders



Hydraulex Corporate  
48175 Gratiot Ave  
Chesterfield, MI 48051  
Toll Free: 800.422.4279  
Tel: 586.949.4240

[www.hydraulex.com](http://www.hydraulex.com)

Hydraulex Detroit  
Hydraulex Jackson  
Hydraulex Seattle  
Hydraulex Memphis

Tel: 586.949.4240  
Tel: 601.469.1987  
Tel: 253.604.0400  
Tel: 901.794.2462

[sales@hydraulex.com](mailto:sales@hydraulex.com)  
[sales@metarisusa.com](mailto:sales@metarisusa.com)  
[hrdsales@hydraulex.com](mailto:hrdsales@hydraulex.com)  
[fhisales@hydraulex.com](mailto:fhisales@hydraulex.com)



Connect with us:



*All manufacturers names, symbols and descriptions in this document are used for reference purposes only, and it is not implied that any parts listed is the product of these manufacturers.*